

EXISTING LONGITUDINAL SECTION (A-A), Scale: 1/100

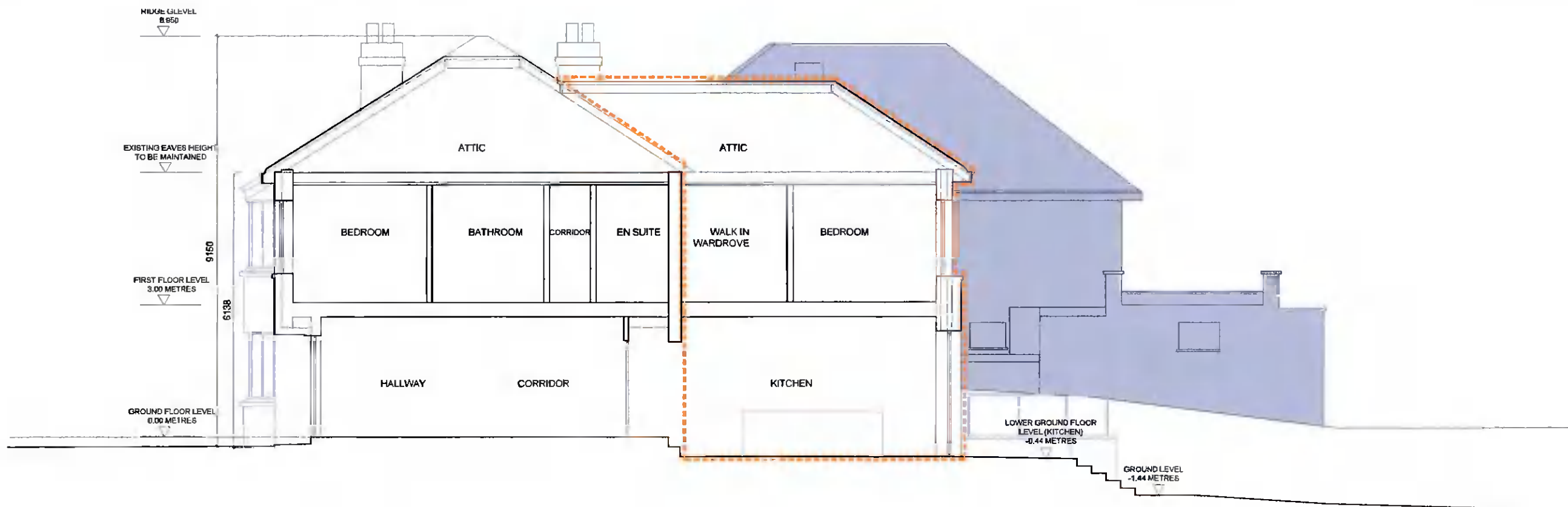

PROPOSED LONGITUDINAL SECTION (A-A), Scale: 1/100

— SITE BOUNDARY SUBJECT OF CURRENT PLANNING APPLICATION — PROPOSED EXTENSIONS OUTLINED IN ORANGE

0 1 5 m

NO DIMENSIONS TO BE SCALED OFF THIS DRAWING
ALL DIMENSIONS TO BE CHECKED ON SITE
THE DRAWING IS COPYRIGHT
SPOT LEVELS SHOWN IN RELATION TO GROUND FLOOR LEVEL

REV	DATE	DRN	NOTES
A	23.12.21	AL	ISSUED FOR PLANNING
B	24.03.22	AL	ISSUED FOR PLANNING RESPONSE

REV	DATE	DRN	NOTES

ARANZAZU LERA ANTON ARCHITECT
141 RATHFARNHAM ROAD, RATHFARNHAM, DUBLIN 14
T 0871027162 E aleranton@gmail.com

DWG. SERIES 3.1 PLANNING			
PROJECT	PROPOSED HOUSE EXTENSION AT ST KEVIN'S, 17 RATHFARNHAM PK, D 14	JOB NO	21-101
DRN. TITLE	EXISTING AND PROPOSED LONGITUDINAL SECTIONS (A-A)	DATE	23.12.21
CLIENT	WILLIAM JUDGE	DRN BY	AL
		SCALE	1:100
		DWG NO	3.1_301
		REV	B

ORIGINAL SHEET SIZE = A3