

FOR PLANNING PURPOSES ONLY
NOT A CONSTRUCTION ISSUE

85-280

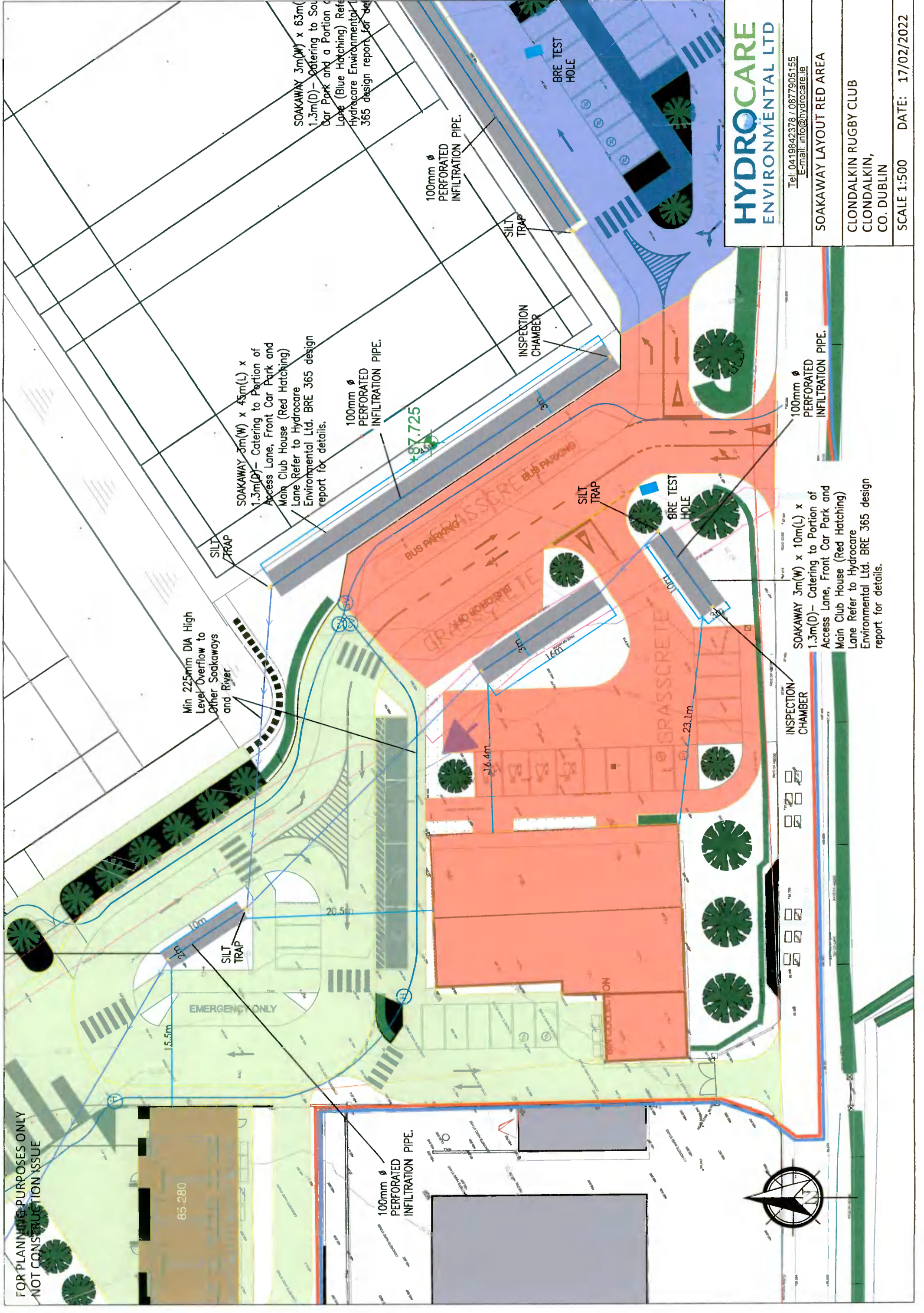

SOAKAWAY 3m(W) x 1.3m(D) x 45m(L) x 45m(L) - Catering to Portion of Access Lane, Front Car Park and Main Club House (Red Hatching) Lane Refer to Hydrocare Environmental Ltd. BRE 365 design report for details.

Min 225mm DIA High Level Overflow to Other Soakaways and River

SOAKAWAY 3m(W) x 1.3m(D) - Catering to Soakaway Car Park and a Portion of Lane (Blue Hatching) Refer to Hydrocare Environmental Ltd. BRE 365 design report for details.

100mm ϕ PERFORATED INFILTRATION PIPE.

100mm ϕ PERFORATED INFILTRATION PIPE.

100mm ϕ PERFORATED INFILTRATION PIPE.

INSPECTION CHAMBER

SOAKAWAY 3m(W) x 1.3m(D) - Catering to Portion of Access Lane, Front Car Park and Main Club House (Red Hatching) Lane Refer to Hydrocare Environmental Ltd. BRE 365 design report for details.

100mm ϕ PERFORATED INFILTRATION PIPE.

HYDROCARE ENVIRONMENTAL LTD

Tel: 0419842378 / 0877905155
E-mail: info@hydrocare.ie

SOAKAWAY LAYOUT RED AREA

CLONDALKIN RUGBY CLUB
CLONDALKIN,
CO. DUBLIN

SCALE 1:500 DATE: 17/02/2022

FOR PLANNING PURPOSES ONLY
NOT CONSTRUCTION ISSUE

**SOAKAWAY No.1
LONG SECTION**

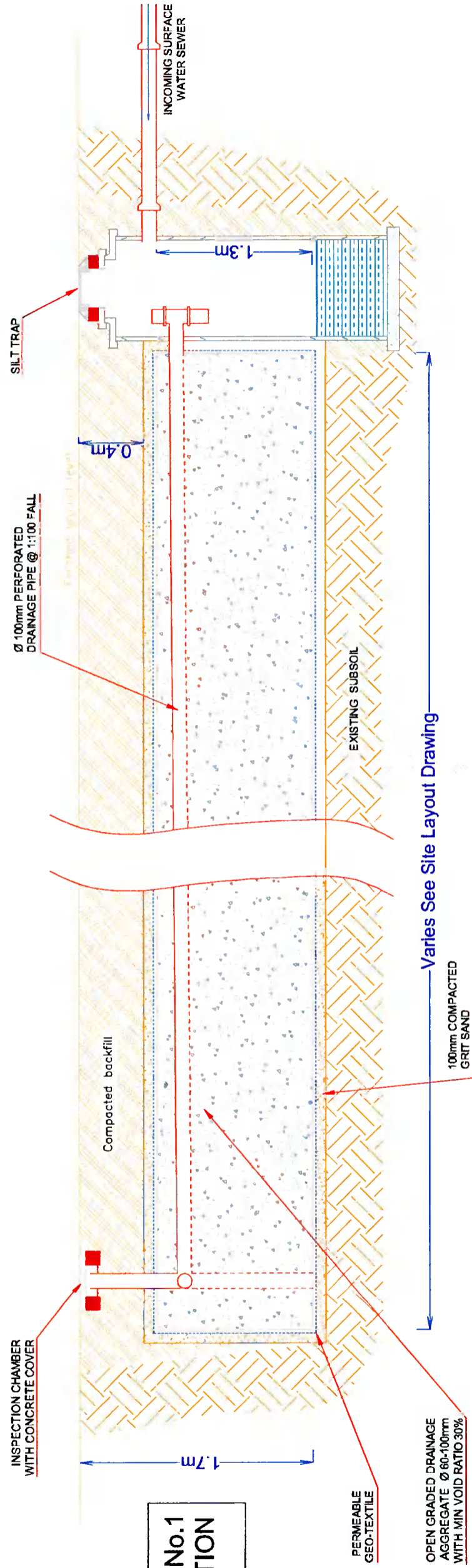

Varies See Site Layout Drawing

**SOAKAWAY
No.1 CROSS
SECTION**

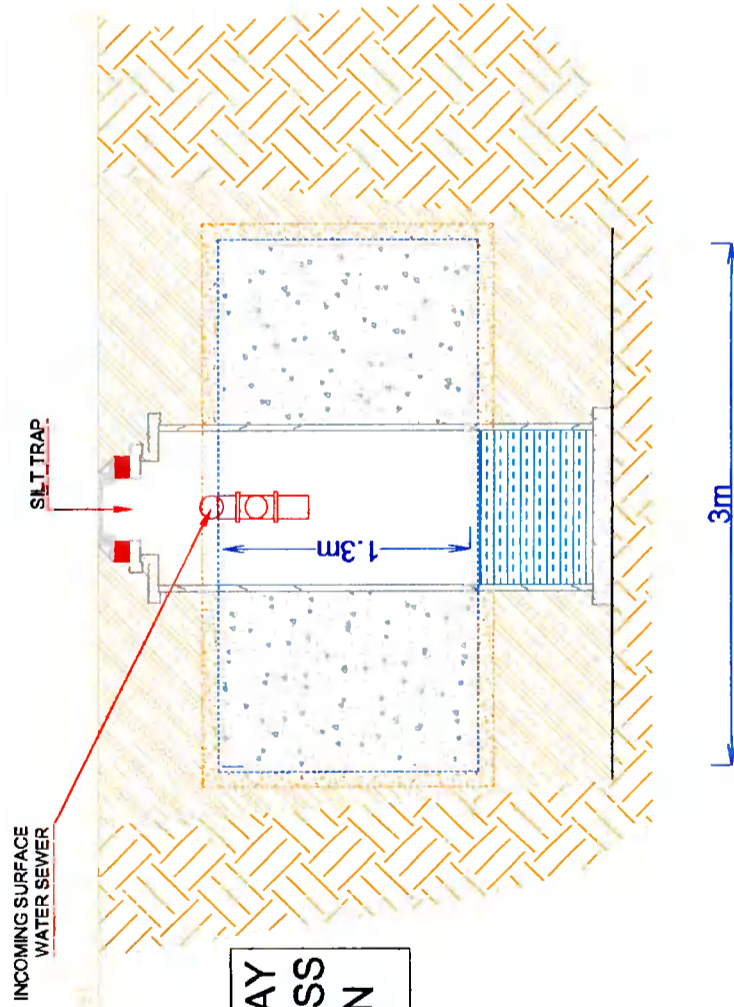

HYDROCARE
ENVIRONMENTAL LTD

Tel: 0419842378 / 0877905155
E-mail: info@hydrocare.ie

SOAKAWAY SECTION

CLONDALKIN RUGBY CLUB
CLONDALKIN,
CO. DUBLIN

SCALE nts DATE: 17/02/2022

FOR PLANNING PURPOSES ONLY
NOT CONSTRUCTION ISSUE

DIA High
low to
ways

SOAKAWAY 3m(W) x 45m(L) x
1.3m(D) - Catering to Portion of
Access Lane, Front Car Park and
Main Club House (Red Hatching)
Lane. Refer to Hydrocare
Environmental Ltd. BRE 365 design
report for details.

100mm ϕ
PERFORATED
INFILTRATION PIPE.

SOAKAWAY 3m(W) x 63m(L) x
1.3m(D) - Catering to South East
Car Park and a Portion of Access
Lane (Blue Hatching) Refer to
Hydrocare Environmental Ltd. BRE
365 design report for details.

100mm ϕ
PERFORATED
INFILTRATION PIPE.

SOAKAWAY 3m(W) x 100m(L) x
1.3m(D) - Catering to Portion of
Access Lane, Front Car Park and
Main Club House (Red Hatching)
Lane Refer to Hydrocare
Environmental Ltd. BRE 365 design
report for details.

100mm ϕ
PERFORATED
INFILTRATION PIPE.

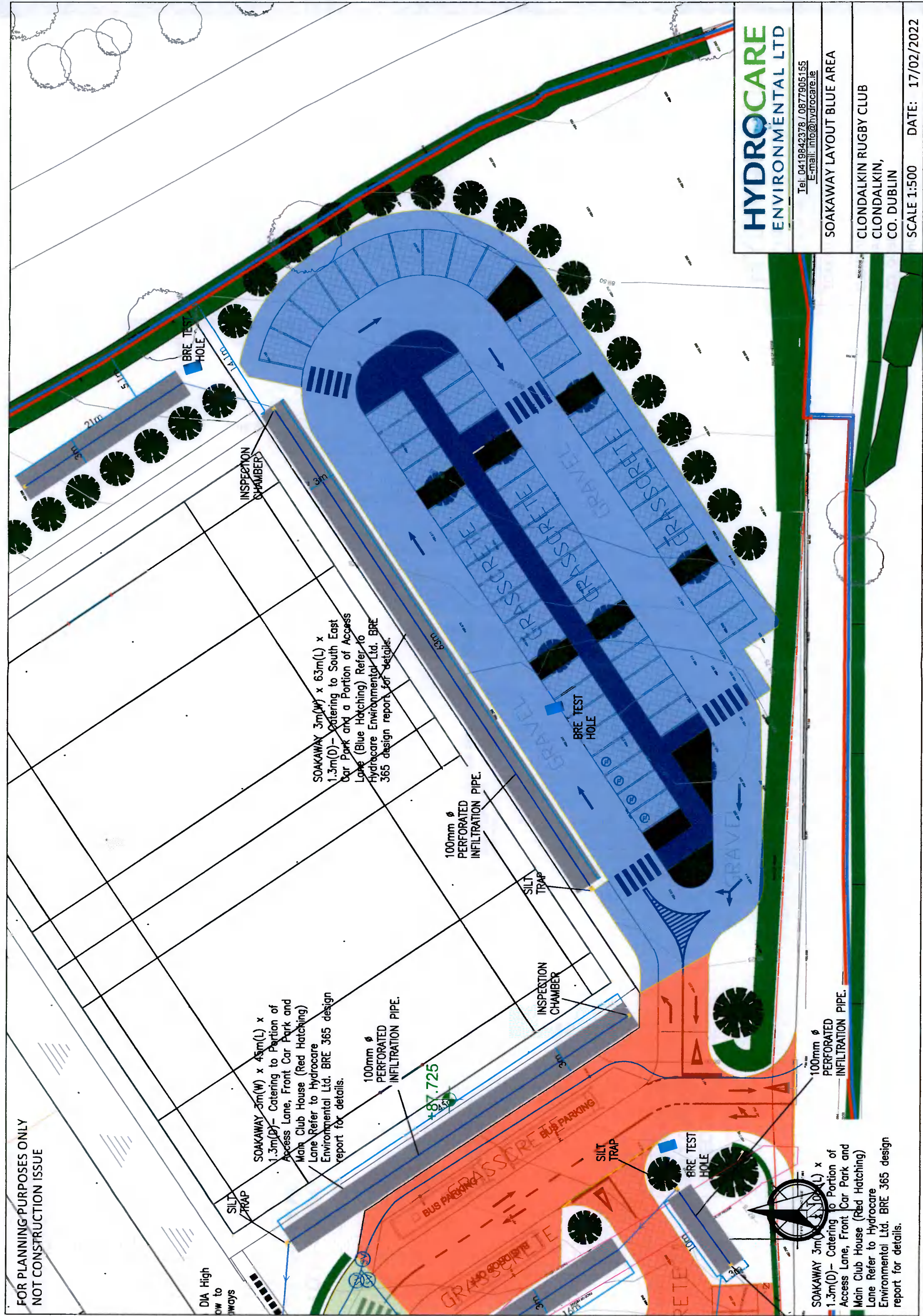

HYDROCARE
ENVIRONMENTAL LTD

Tel: 0419842378 / 0877905155
E-mail: info@hydrocare.ie

SOAKAWAY LAYOUT BLUE AREA

CLONDALKIN RUGBY CLUB
CLONDALKIN,
CO. DUBLIN

SCALE 1:500 DATE: 17/02/2022

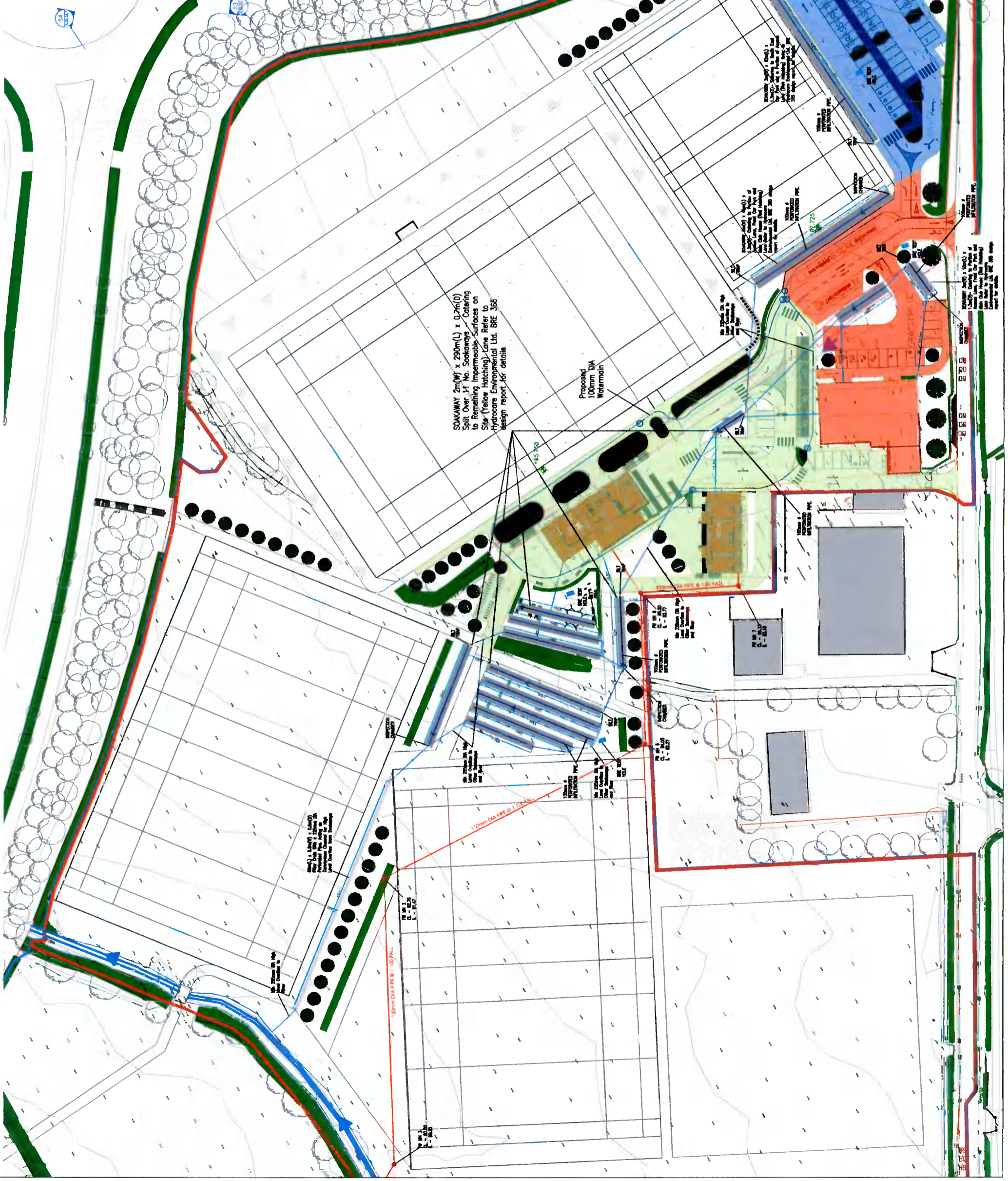
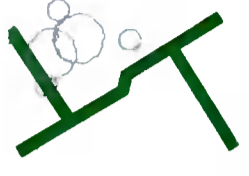
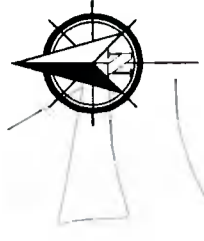

SOAKAWAY 2m(W) x 290m(L) x 0.7m(D)
 Split Over 17 No. Soakaways Catering
 to Remaining Impermeable Surfaces on
 Site (Yellow Hatching) - Lone Refer to
 Hydrocare Environmental Ltd. BRE 365
 design report for details

Proposed
 100mm BIA
 Watermain

150mm DIA PPE @ 1100 PAL

120mm DIA PPE @ 1100 PAL

HYDROCARE
 ENVIRONMENTAL LTD

Tel: 041 9842378 / 0877895155
 Email: info@hydrocare.ie

SITE OVERVIEW

CLONDALKIN RUGBY CLUB
 CLONDALKIN,
 CO. DUBLIN

SCALE 1:1000 DATE: 17/02/2022

FOR PLANNING PURPOSES ONLY
NOT CONSTRUCTION ISSUE

**SOAKAWAY No.1
LONG SECTION**

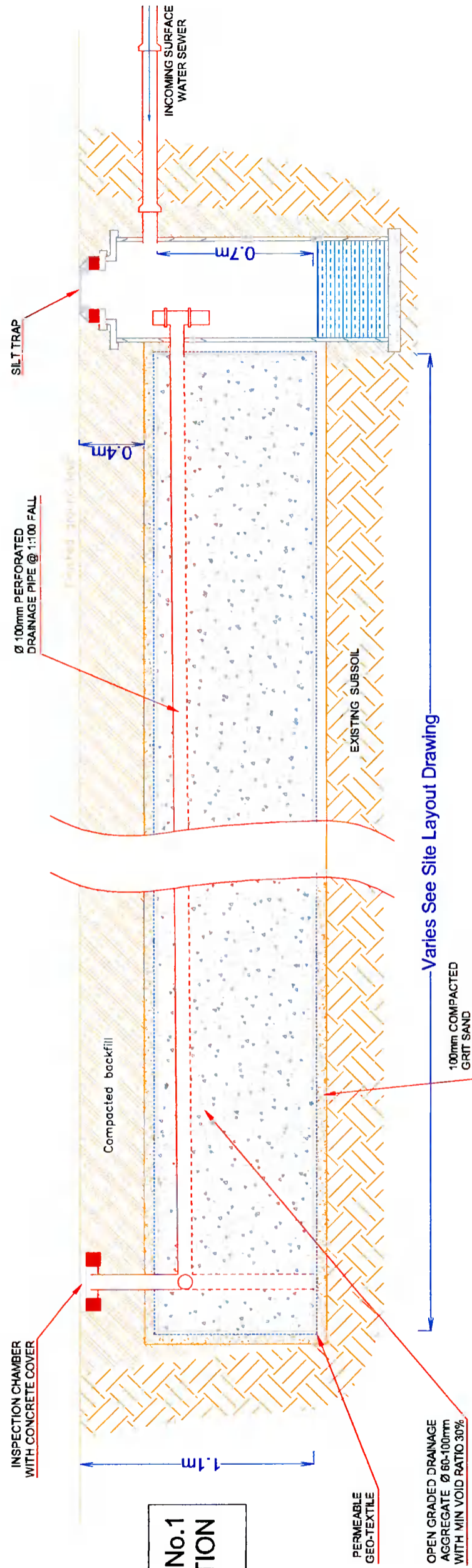

**SOAKAWAY
No.1 CROSS
SECTION**

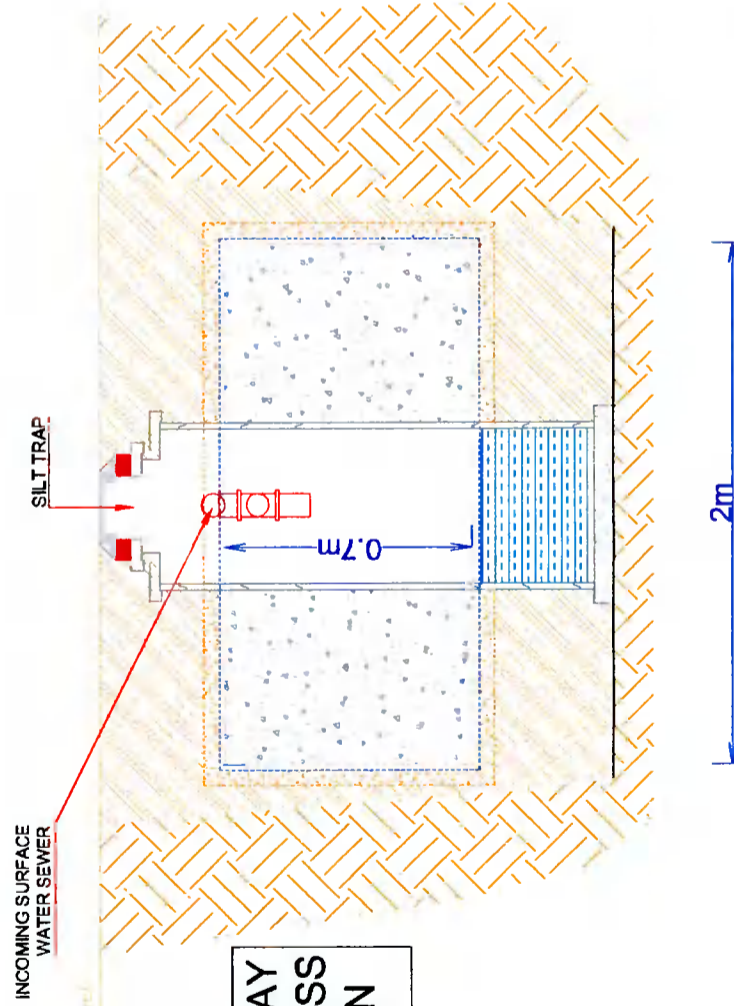

HYDROCARE
ENVIRONMENTAL LTD

Tel: 0419842378 / 0877905155
E-mail: info@hydrocare.ie

SOAKAWAY SECTION

CLONDALKIN RUGBY CLUB
CLONDALKIN,
CO. DUBLIN

SCALE nts DATE: 17/02/2022