

Node Label	Water Level (OD) 10% AEP	Flow (m³/s) 10% AEP	Water Level (OD) 1% AEP	Flow (m³/s) 1% AEP	Water Level (OD) 0.1% AEP	Flow (m³/s) 0.1% AEP
09CMM01407	86.72	N/A	86.78	N/A	86.8	N/A
09CMM01353	82.13	N/A	82.18	N/A	82.21	N/A
09CMM01325	80.6	5.18	80.63	6.73	80.64	8.59
09CMM01307	82.76	8.42	82.75	10.15	83.14	13.94
09VER S00056	86.44	6.58	86.44	9.19	86.54	13.60
09VER S00041	80.37	-1.43	80.37	N/A	80.57	N/A
09FORT00006	84.24	1.48	84.25	2.87	84.75	5.63
09CMM01250						2.93

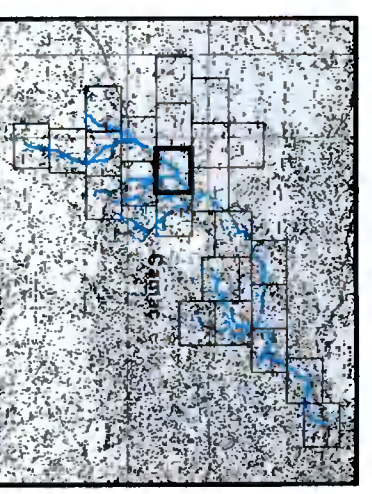
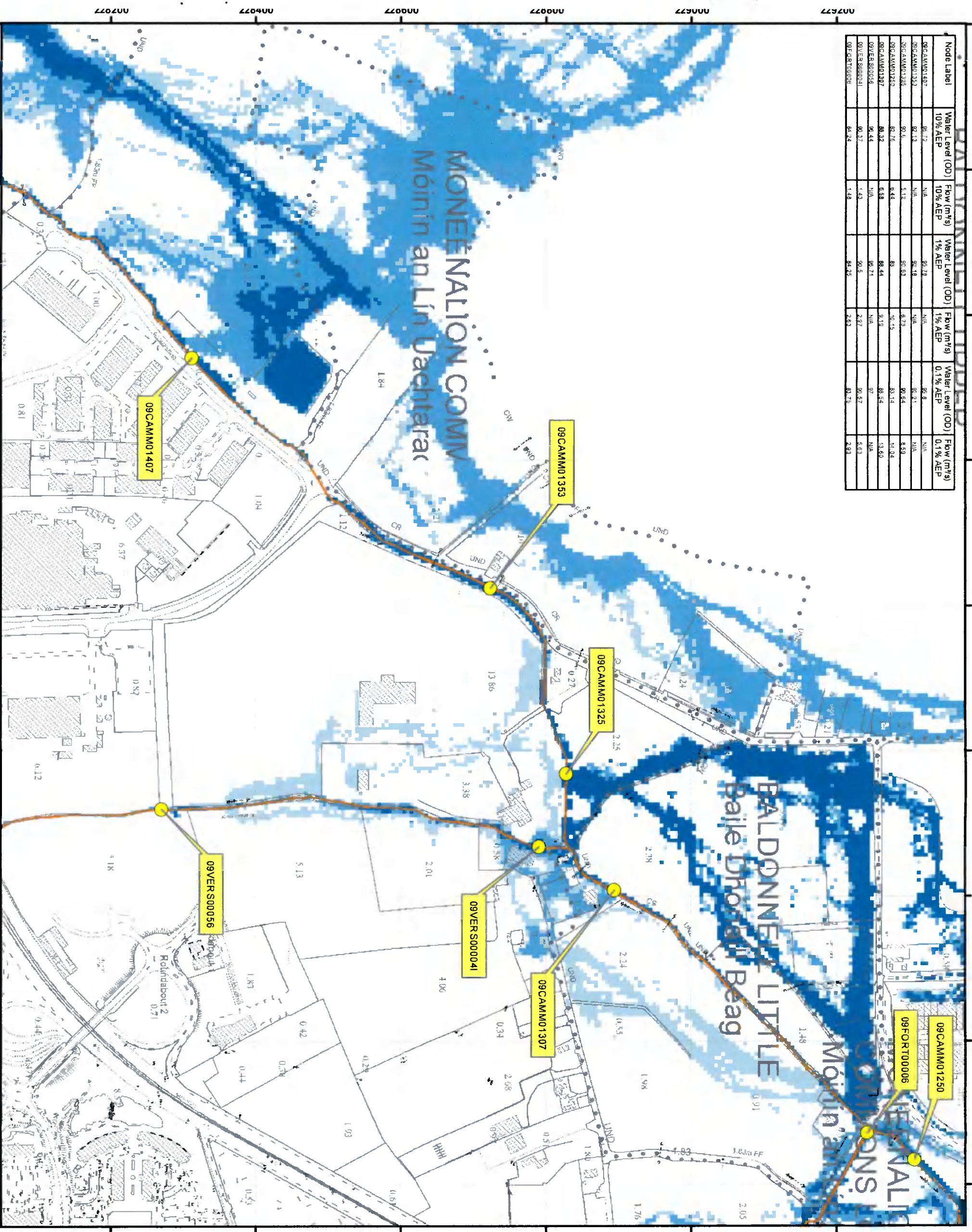

**IMPORTANT USER NOTE:**  
 THE VIEWER OF THIS MAP SHOULD REFER TO THE DISCLAIMER, GUIDANCE NOTES AND CONDITIONS OF USE THAT ACCOMPANY THIS MAP.

- Legend**
- 10% Fluvial AEP Event
  - 1% Fluvial AEP Event
  - 0.1% Fluvial AEP Event
  - Modelled River Centreline
  - AFA Extents
  - Embankment1
  - Wall
  - Detended Area
  - 5% AEP Standard of Protection of Flood Defence (Walls / Embankments)
  - Node Point
  - Node ID Node Label

**FINAL**

REV	NOTES	DATE
01	NOTESOP label updated (Pg 21) Removal of Det. Area (Pg 21)	13/11/2017



The Office of Public Works  
 74 Bowdler Road, F-44(D) 28 90 862206  
 Dublin 8  
 Co. Dublin  
 E:relief@opw.gov.ie

**Map:**  
 Camac Fluvial Flood Extents

**Map Type:** EXTENT  
**Source:** FLUVIAL  
**Map Area:** HPW

**Scenario:** CURRENT  
**Drawn By:** C.M.G. Date: 13 November 2017  
**Checked By:** A.S. Date: 13 November 2017  
**Approved By:** S.P. Date: 13 November 2017

**Drawing No.:**  
**E09CAM\_EXFCD\_F1\_08**

**Map Series:** Page 8 of 24

**Drawing Scale:** 1:5,000 @A3







Node Label	Water Level (OD) 10% AEP	Flow (m <sup>3</sup> /s) 10% AEP	Water Level (OD) 1% AEP	Flow (m <sup>3</sup> /s) 1% AEP	Water Level (OD) 0.1% AEP	Flow (m <sup>3</sup> /s) 0.1% AEP
09FOR00026	97.27	N/A	97.44	N/A	97.58	N/A
09FOR00077	96.89	N/A	97.1	N/A	97.28	N/A
09FOR00026	96.39	N/A	96.44	N/A	96.45	N/A
09TALL00068J	89.82	N/A	89.84	N/A	89.88	N/A
09TALL00068J	89.84	N/A	89.84	N/A	89.87	N/A
09TALL00144J	100.16	0.10	100.43	0.18	100.76	0.31
09TALL00111	94.41	N/A	94.71	N/A	95	N/A
09CHEE00051J	103.06	1.83	103.24	3.37	103.51	6.72

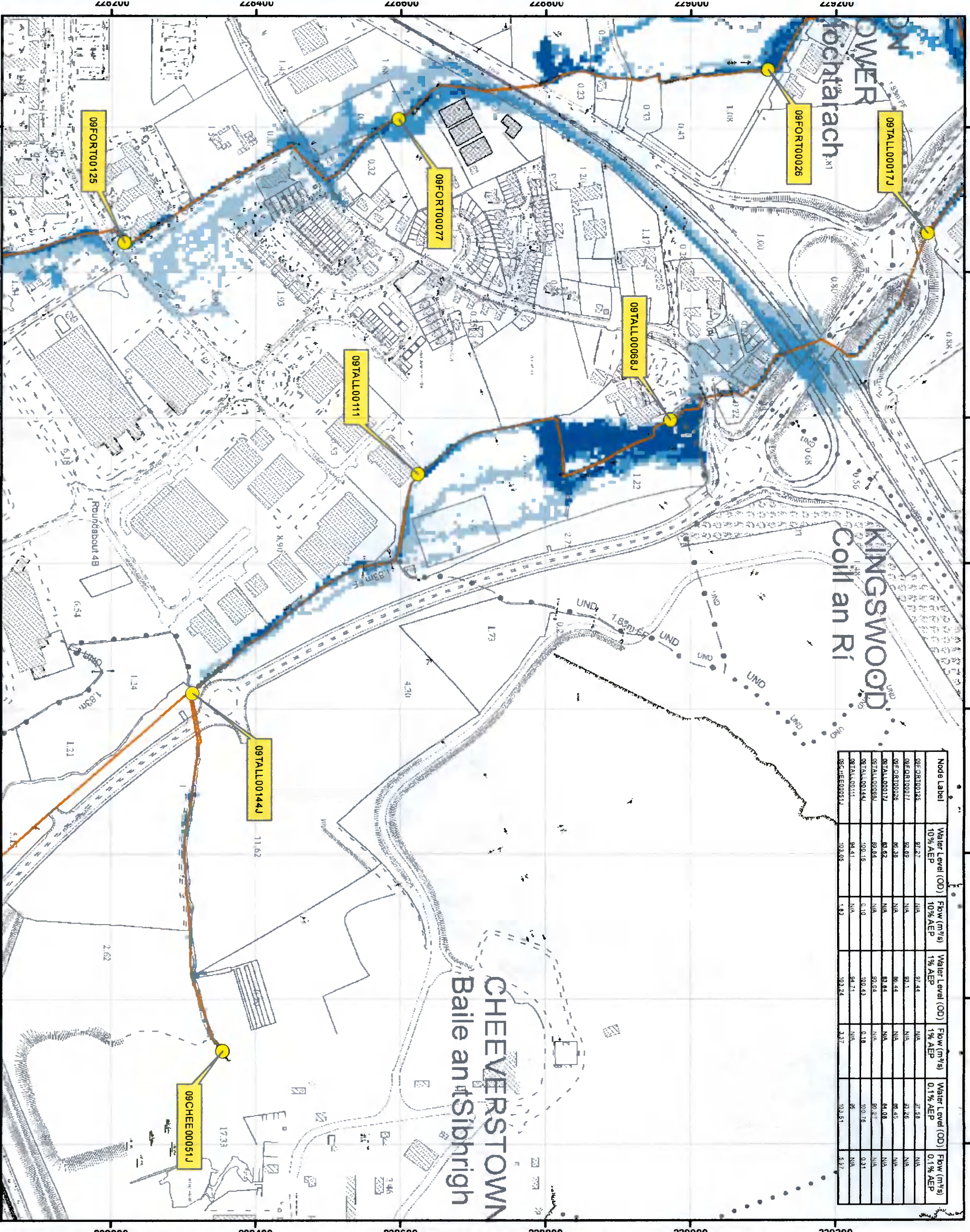

**IMPORTANT USER NOTE:**  
THE VIEWER OF THIS MAP SHOULD REFER TO THE DISCLAIMER, GUIDANCE NOTES AND CONDITIONS OF USE THAT ACCOMPANY THIS MAP.

- Legend**
- 10% Fluvial AEP Event
  - 1% Fluvial AEP Event
  - 0.1% Fluvial AEP Event
  - Modelled River Centreline
  - AFA Extents
  - Embankment
  - Wall
  - Defended Area
  - Standard of Protection of Flood Defence (Walls / Embankments)
  - Node Point
  - Node ID / Node Label

**FINAL**

REV	NO/Top level updated (Pg 2)	DATE
01	Remove Old Data, Area (Pg 2)	13/11/2017

**OPW** (Office of Public Works)

**RPS** (RPS Group)

**CFRAM** (Central Flood Risk Assessment Methodology)

**EASTERN STUDY**

The Office of Public Works  
74 Bowdler Road  
Belfast  
BT12 9BZ  
E:reland@opw.gov.uk

Emwood House  
T: +44(0) 28 90 6879  
F: +44(0) 28 90 68236  
W: www.rpsgroup.com

Map Type: EXTENT  
Source: FLUVIAL  
Map Area: HPW  
Scenario: CURRENT  
Drawn By: C.McG. Date: 13 November 2017  
Checked By: A.S. Date: 13 November 2017  
Approved By: S.P. Date: 13 November 2017  
Drawing No.:  
E09CAM\_EXFCD\_F1\_11  
Map Series: Page 11 of 24  
Drawing Scale: 1:5,000 @A3







X: 305190  
Y: 229146



SOAKAWAY 2m(W) x 250m(L) x 0.2m(D)  
Spill Over 14 No. Soakaways - Catering  
to Removing Impermeable Surfaces on  
Site (Yellow Hatching) - Refer to  
Hydrocare Environmental Ltd. BRE 365  
design report for details.

Proposed  
100mm DIA  
Watermain



**HYDROCARE**  
ENVIRONMENTAL LTD

Tel: 0419842378 / 0877905165  
E-mail: info@hydrocare.ie

**SITE OVERVIEW**  
CLONDALKIN RUGBY CLUB  
CLONDALKIN,  
CO. DUBLIN

SCALE 1:1000 DATE: 17/02/2022







To Remaining Impermeable Surfaces on Site (Yellow Hatching) Lane Refer to Hydrocare Environmental Ltd. BRE 365 design report for details.

Proposed 100mm DIA Watermain

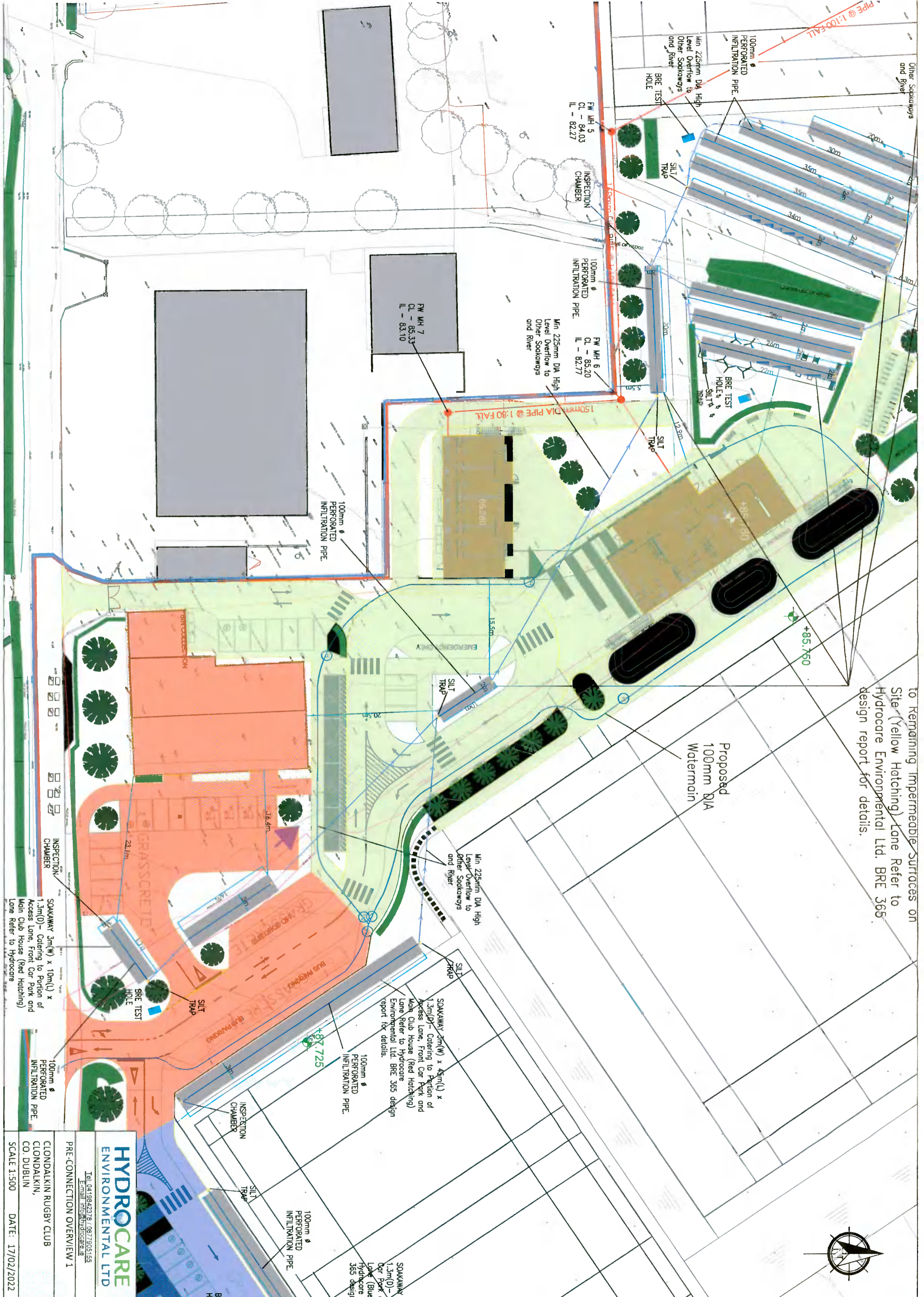

SOKKAWAY 3m(W) x 4m(L) x 1.3m(D) - Catering to Portion of Access Lane, Front Car Park and Main Club House (Red Hatching) Lane Refer to Hydrocare Environmental Ltd. BRE 365 design report for details.

SOKKAWAY 3m(W) x 10m(L) x 1.3m(D) - Catering to Portion of Access Lane, Front Car Park and Main Club House (Red Hatching) Lane Refer to Hydrocare

**HYDROCARE ENVIRONMENTAL LTD**  
 Tel: 0419842378 / 0877905165  
 Email: info@hydrocare.ie

PRE-CONNECTION OVERVIEW 1

CLONDALKIN RUGBY CLUB  
 CLONDALKIN,  
 CO. DUBLIN

SCALE 1:500 DATE: 17/02/2022







FW MH 1  
CL - 80.40  
IL - 78.99

# X: 305190

# Y: 229146

150mm DIA PIPE @ 1:100 FALL

FW MH 2  
CL - 82.06  
IL - 80.06

FW MH 3  
CL - 82.50  
IL - 80.23

150mm DIA PIPE @ 1:100 FALL

FW MH 3  
CL - 82.76  
IL - 81.47

150mm DIA PIPE @ 1:100 FALL

Min 225mm DIA High Level Overflow to River

69m(L) x 0.6m(W) x 0.6m(D) Filter Drain With a 225mm DIA Perforated Pipe, Acting as Conveyance Channel for High Level Overflow from Sookawops

Min 225mm DIA High Level Overflow to Other Sookawops and River

Min 225mm DIA High Level Overflow to Other Sookawops and River

SILT TRAP

BRE TEST HOLE

100mm ø PERFORATED INFILTRATION PIPE

INSPECTION CHAMBER



**HYDROCARE**  
ENVIRONMENTAL LTD

Tel: 0419842378 / 0877905155  
Email: info@hydrocare.ie

PRE-CONNECTION OVERVIEW 2

CLONDALKIN RUGBY CLUB  
CLONDALKIN,  
CO. DUBLIN

SCALE 1:500 DATE: 17/02/2022



