

PROPOSED WORKS
SHOWN COLOURED BLUE

NOTE:
DRAINAGE LAYOUT
IS SCHEMATIC

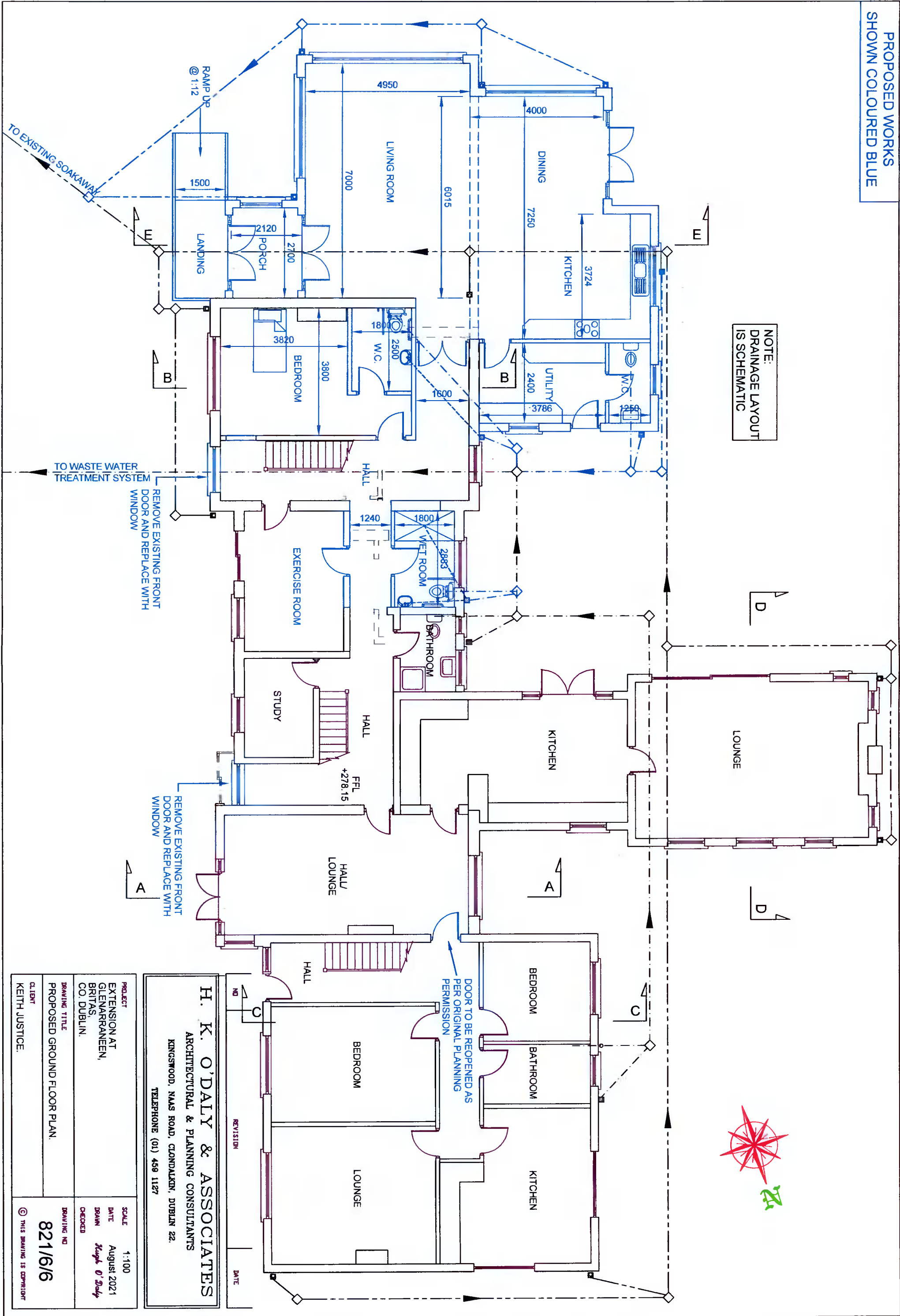

TO WASTE WATER
TREATMENT SYSTEM
REMOVE EXISTING FRONT
DOOR AND REPLACE WITH
WINDOW

REMOVE EXISTING FRONT
DOOR AND REPLACE WITH
WINDOW

DOOR TO BE REOPENED AS
PER ORIGINAL PLANNING
PERMISSION

PROJECT	EXTENSION AT GLENARRANEEN, BRITAS CO. DUBLIN.	SCALE	1:100
CLIENT	KEITH JUSTICE	DATE	August 2021
DRAWING TITLE	PROPOSED GROUND FLOOR PLAN.	DRAWN	<i>Keogh O'Daly</i>
DRAWING NO	821/6/6	CHECKED	

H. K. O'DALY & ASSOCIATES
ARCHITECTURAL & PLANNING CONSULTANTS
KINGSWOOD, NAAS ROAD, CLONDALKEN, DUBLIN 22.
TELEPHONE (01) 459 1127

NO	REVISION	DATE