

All dimensions to be checked on site. Figure dimensions take preference over scaled dimensions. Any errors or discrepancies to be reported to the Architect. This drawing may not be edited or modified by the recipient.

Copyright and ownership of this drawing is vested in RKD Architects, whose prior written consent is required for its use, reproduction or for publication to any third party. All rights reserved by the law of copyright and by international copyright conventions are reserved to RKD Architects and may be protected by court proceedings for damages and/or injunctions and costs. RKD Architects' Quality Management Systems are certified to ISO 9001:2015.

Green Facade Legend:

- Proposed Green Walling Planting Zone Area
- Proposed Green Wall Rope Trellis Area on Facade
- Proposed Modular System Green Walling Area
- Proposed Extensive Green Roofing Area

DATA CENTRE BUILDINGS - A SCHEDULE

DATE	DESCRIPTION	AREA
04/15	DL15	16,755 m ²
04/16	DL16	18,891 m ²
	GRAND TOTAL	35,646 m ²

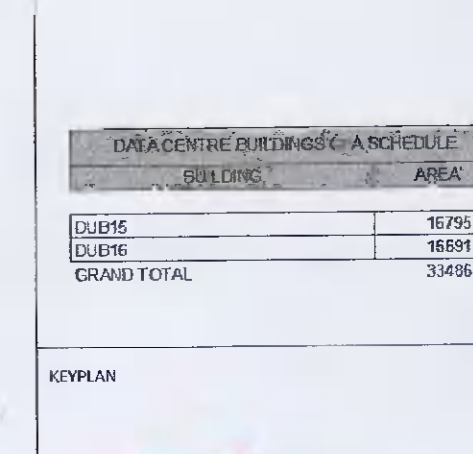

Rev.	Date	Description
B	2022/02/02	Further Information Submission
A	2021/07/26	Planning Issue

WORKSTAGE / WORKSTAGE NAME
PLANNING

PROJECT
INXN DUB15 & DUB16

PROJECT ADDRESS
Profile Park, Nangor Road, Clondalkin, Dublin 22

DWG TITLE
DUB15 Proposed Ground Floor Plan

DATE: 28/05/2021 DRN: SL CHK: MK

RKD
50 Northumberland Rd, Ballsbridge, Dublin 4, Ireland. +353 1 698 1055

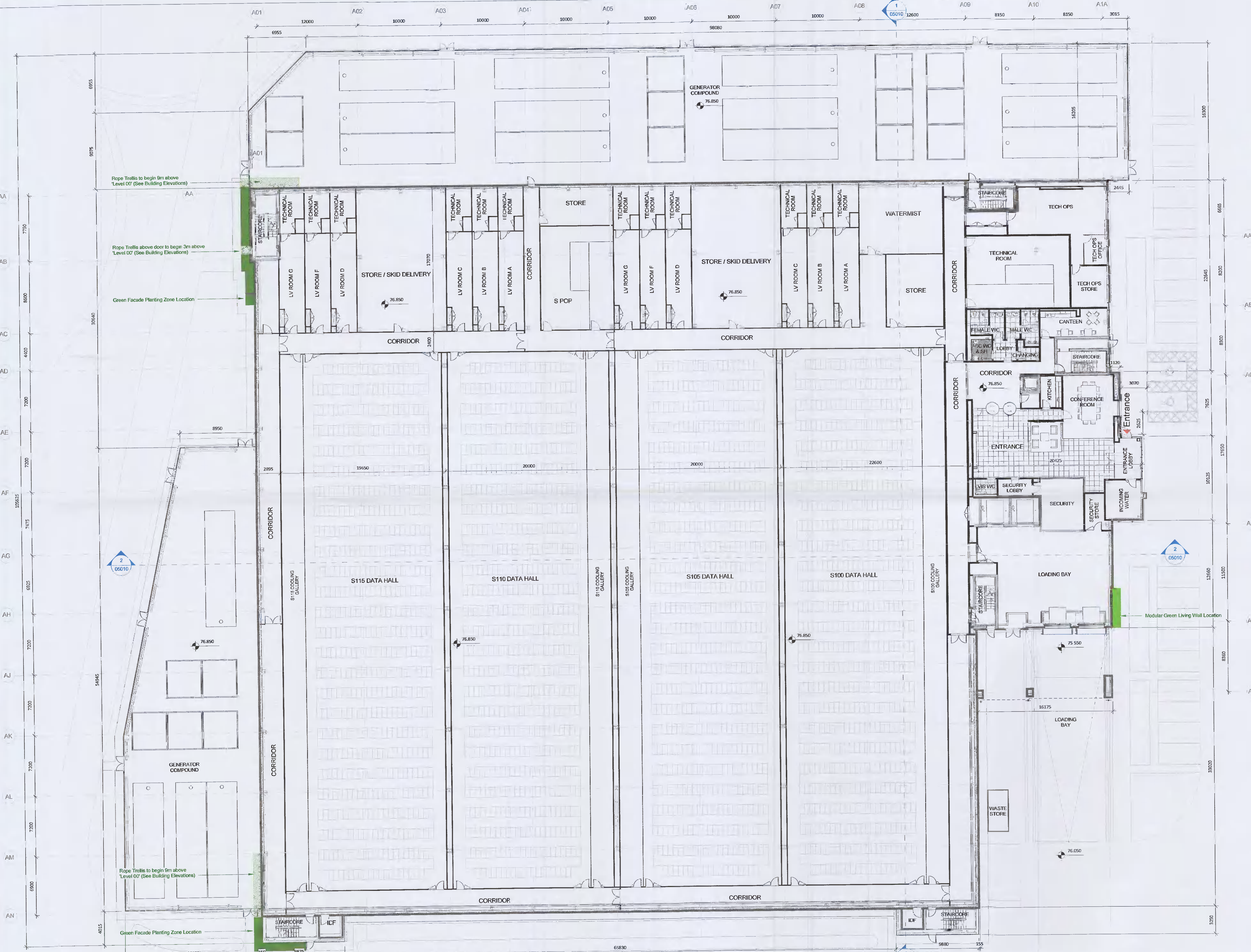

1 03001 DUB15 - Ground Floor Plan
1 : 200