

# Area 1

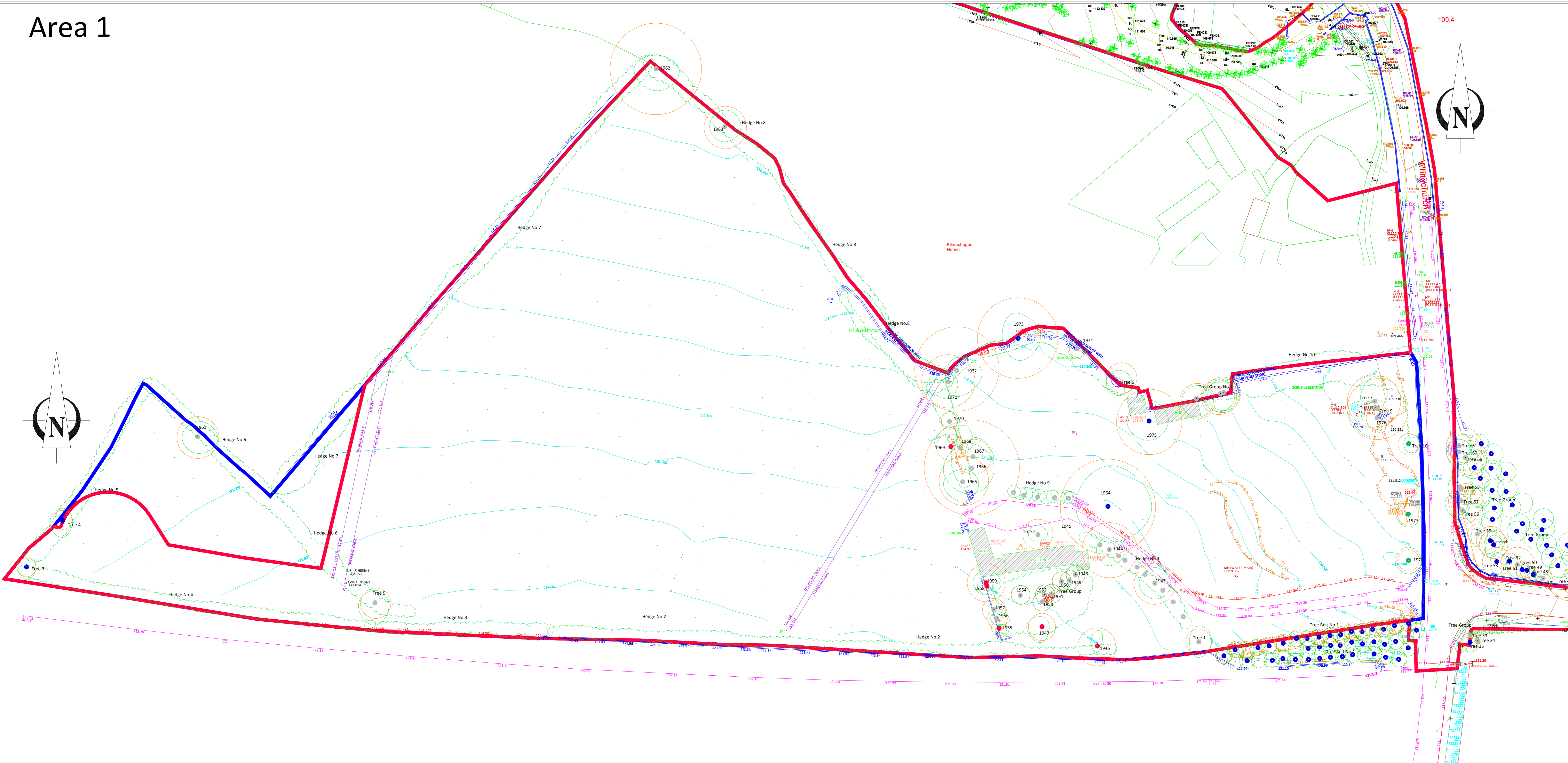

# Notes:

- Tree Constraints/Root zones**  
 For trees being retained, all construction works need to be planned to occur outside this area
- Tag Number
  - Category grade
  - Actual Crown Spread
- B55837: 2012 - Category Retention Rating**
- Category U Trees**  
Trees in such a condition that any existing value would be lost within 10 years or being recommended for removal sound arboricultural practice.
  - Category A Trees**  
Trees of high quality/value with a min. of 40 years life expectancy.
  - Category B Trees**  
Trees of moderate quality/value with a min. of 20 years life expectancy.
  - Category C Trees**  
Trees of low quality/value with a min. of 10 years life expectancy.
- Sub Categories**
- Mainly Arboricultural values
  - Mainly Landscape values
  - Mainly cultural and conservation values.

# Area 2

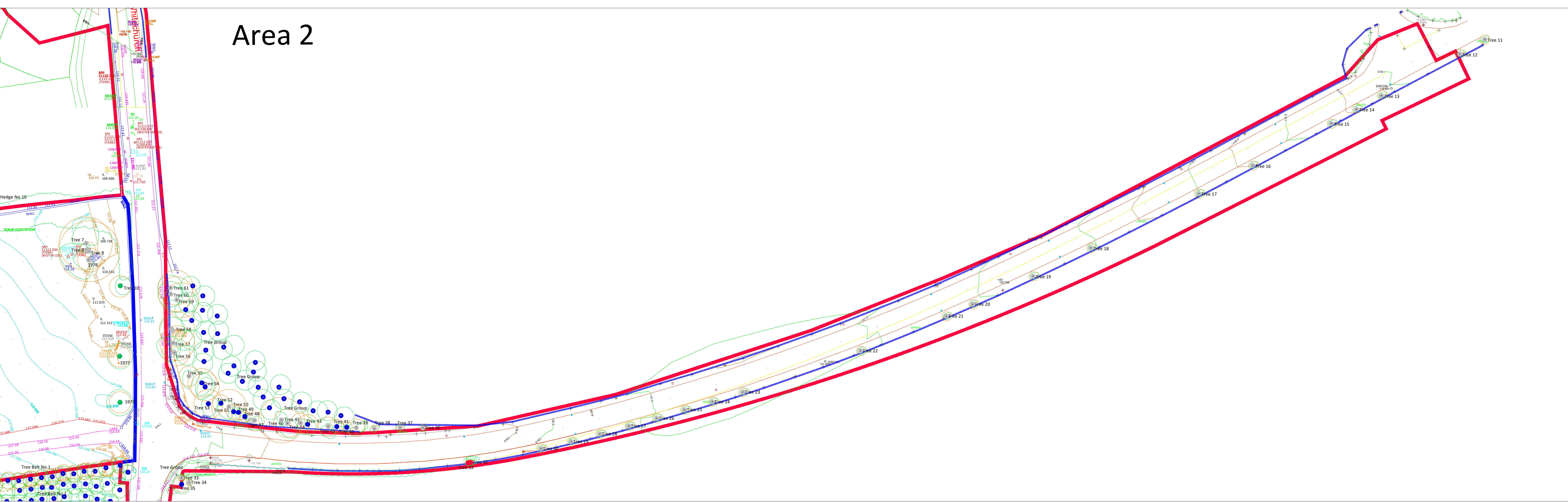

**ARBORIST ASSOCIATES LTD.**  
 94 BALLYBAWN COTTAGES, ENNISKERRY, CO. WICKLOW  
 TEL: 01-2742011 / 087-2629589

**TITLE:** Tree Constraints Plan  
 For Lands at Kilmashogue House,  
 Site: Whitechurch Rd, Rathfarnham, Dublin 16.  
**DATE:** Dwg No: WCR001 Scale 1:500 @ A0