

# Area 1

# Notes:

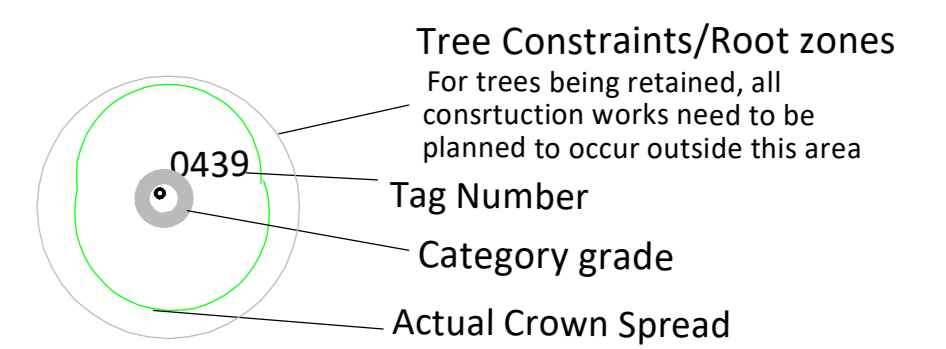

### BS5837: 2012 - Category Retention Rating

- **Category U Trees**  
Trees in such a condition that any existing value would be lost within 10 years or being recommended for removal sound arboricultural practice.
  - **Category A Trees**  
Trees of high quality/value with a min. of 40 years life expectancy.
  - **Category B Trees**  
Trees of moderate quality/value with a min. of 20 years life expectancy.
  - **Category C Trees**  
Trees of low quality/value with a min. of 10 years life expectancy.
- Sub Categories**
- 1- Mainly Arboricultural values
  - 2- Mainly Landscape values
  - 3- Mainly cultural and conservation values.

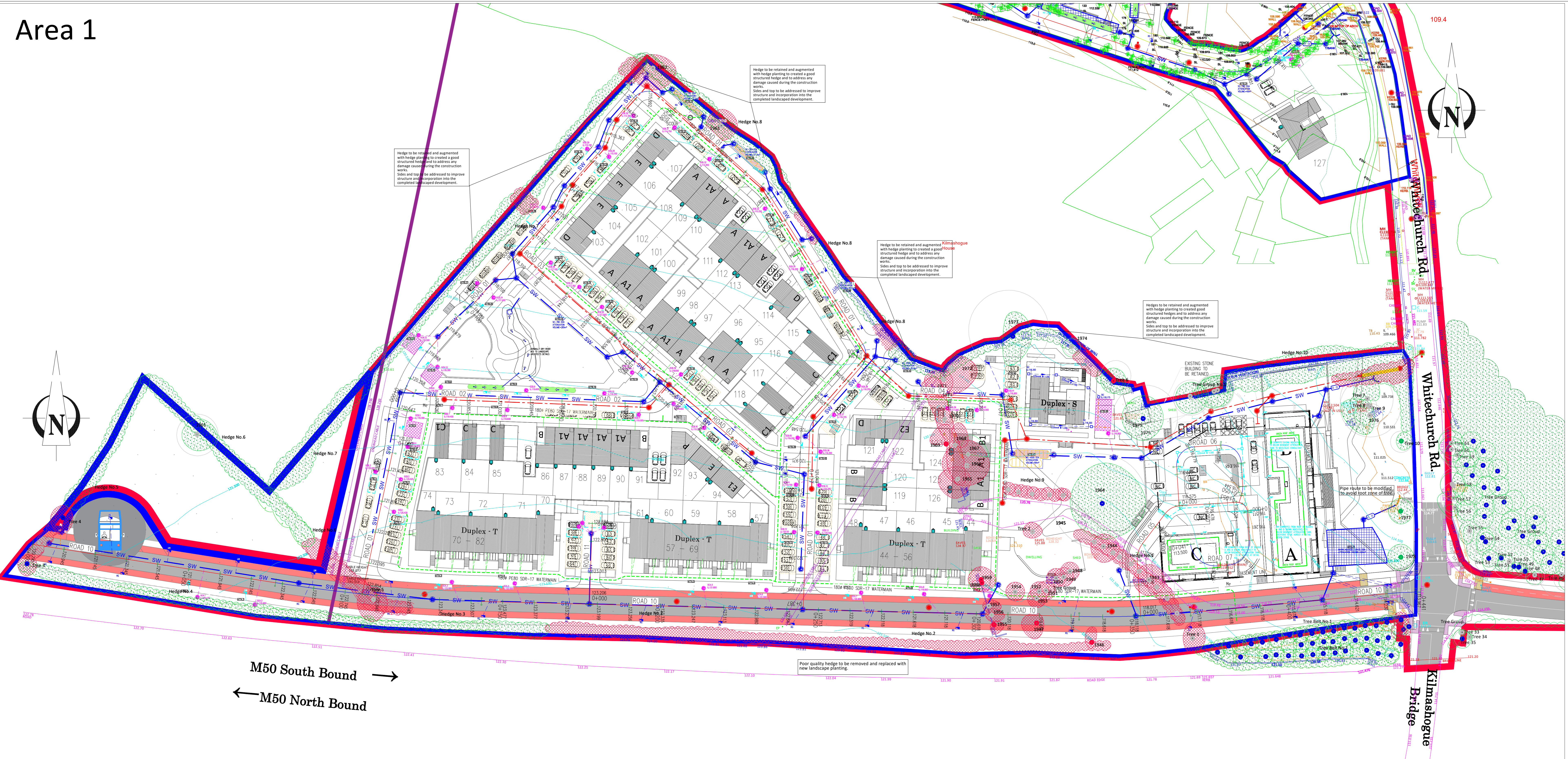
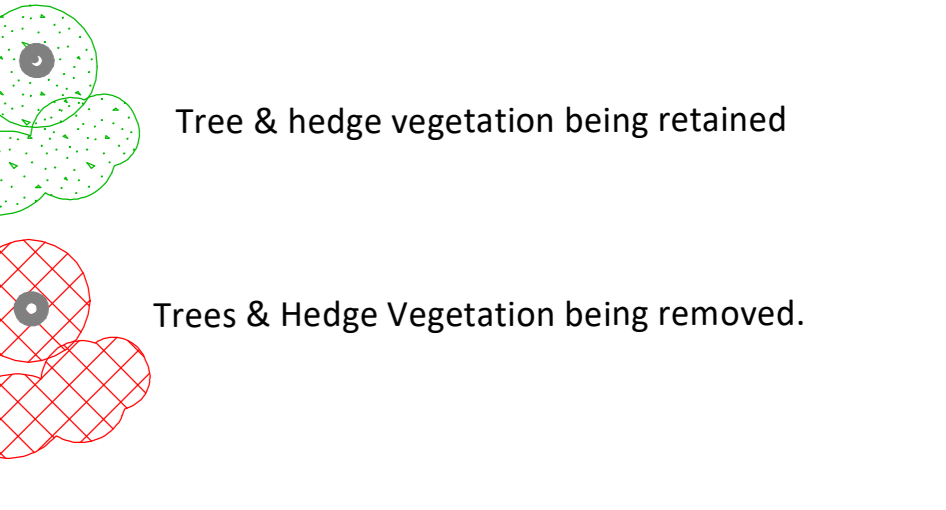

# Area 2

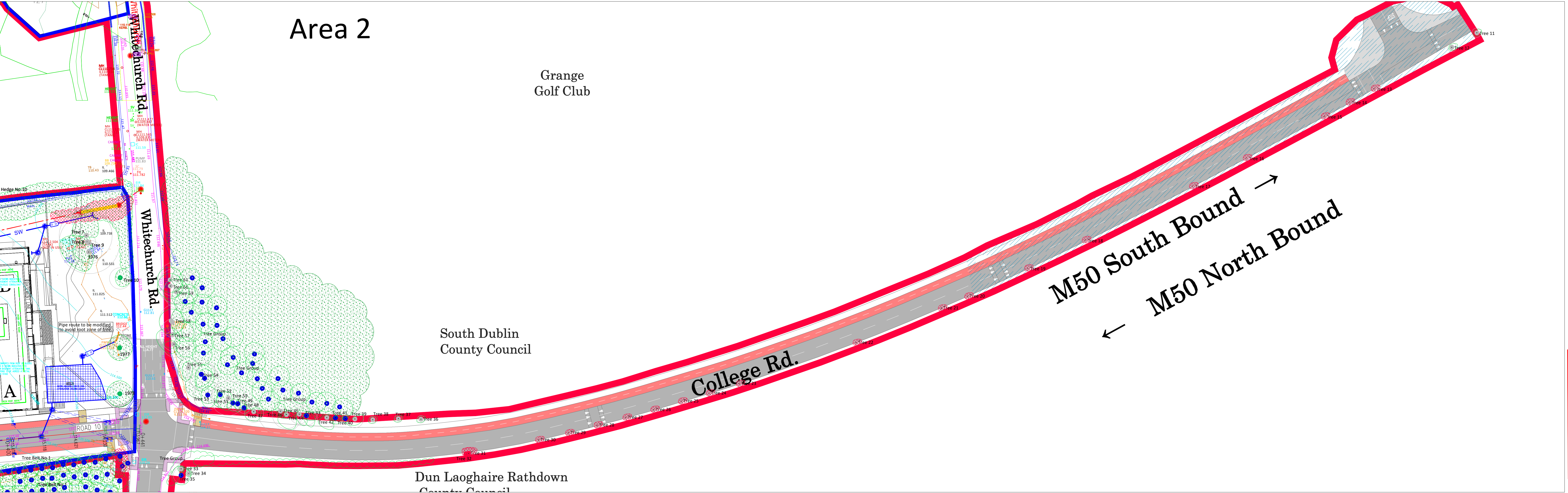

**ARBORIST ASSOCIATES LTD.**  
 94 BALLYBAWN COTTAGES, ENNISKERRY, CO. WICKLOW  
 TEL: 01-2742011 / 087-2629589

**TITLE:** Arboricultural Impact Assessment Plan

**Site:** For Lands at Kilmashogue House, Whitechurch Rd, Rathfarnham, Dublin 16.

**DATE:** Dwg NoWCR002 Scale 1:500 @ A0