

Legend:

- Shared House Collection Points
- Apartment / Duplex Collection Points
- Apartment / Commercial Collection Point
- Rear Access Laneways

** Individual house units to have waste collection point to front of property at kerbside.

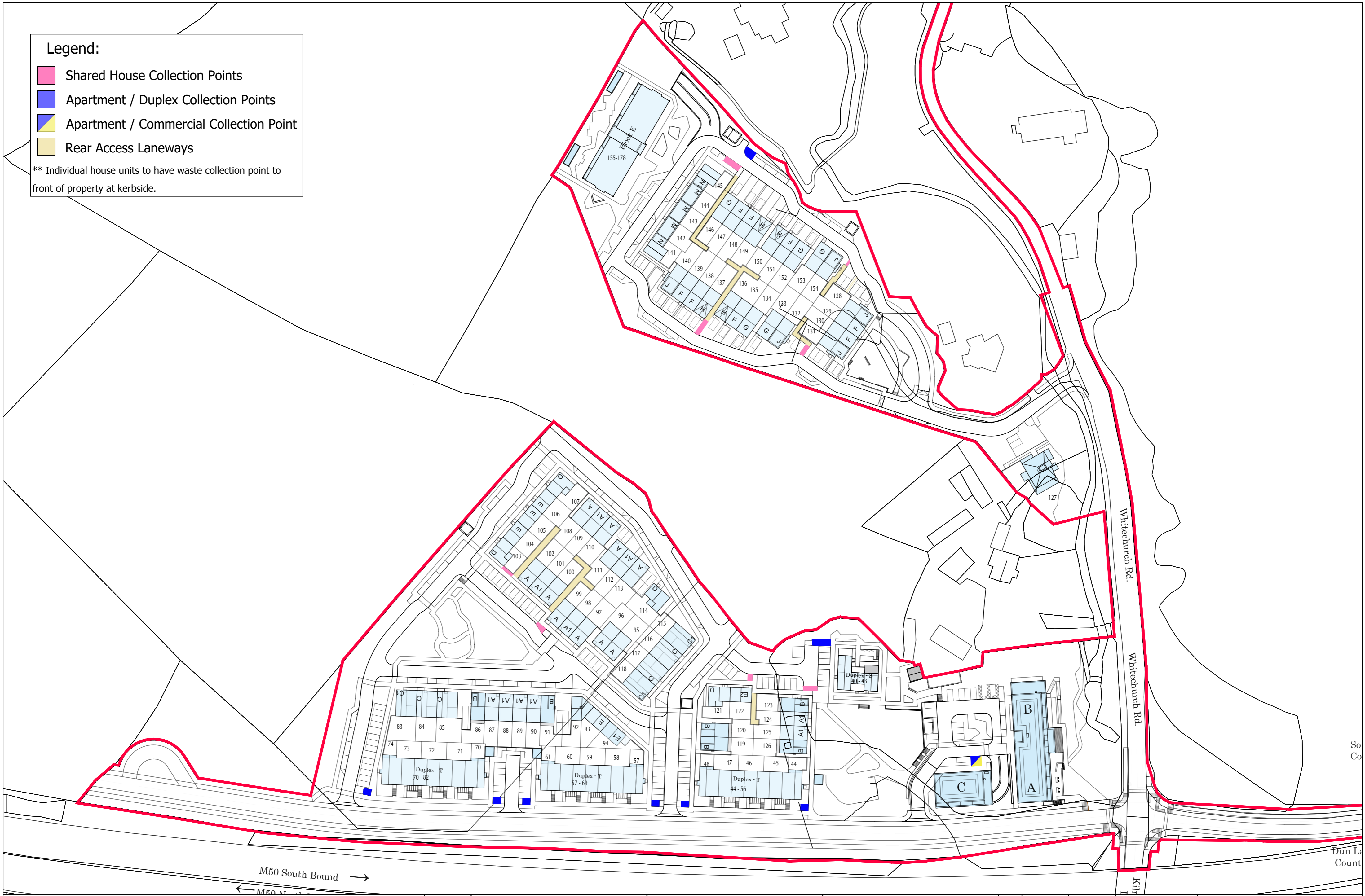

IMPORTANT
Do not scale this drawing, only stated dimensions to be used.
Any discrepancies to be immediately notified to JFOC Architects. All dimensions to be checked on site. Only drawings marked for construction are suitable for this purpose, all others are only suitable for the use indicated by 'Project Stage'.
This drawing is protected by copyright and is the property of JFOC Architects. Any disclosure, copying, reproduction or distribution of this information without written authorisation is prohibited and will be deemed a breach of copyright.

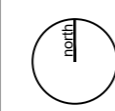
ORIENTATION	CLIENT
	BCDK Holdings Ltd. & Coill Avon Ltd.

PROJECT TITLE
Proposed Residential Development at Edmondstown

DRAWING TITLE
Site Layout Waste Collection Points

SCALE	1:1000 on A2	PROJECT STAGE	Planning
DRAWN	NS	DRAWING NUMBER	18.132.PD4024
CHECKED		REV.	
DATE	November 2021		

JFOC
ARCHITECTS

364 Greenmount House
Harold's Cross
Dublin 16W
D6W X008
01 4530277
jfocarchitects.com
info@jfocarchitects.com