

Existing Gate Pier at Rookwood Lodge Trimmed / moved back 200mm to clear sightline

Potential Pedestrian Access to Rookwood Lodge from new footpath

49m DMURS Sight-Lines Cross-Hatched Purple

Proposed Pedestrian Crossing Ramp

Proposed new Entrance Shaded Grey

Potential 3.0m Offset on Adjacent Site Frontage for future Footpath / Cycle-Path Shaded Light Green

3.0m Offset on Site Frontage for future Footpath / Cycle-Path Shaded Dark Green

Potential For Access Connection to Rookwood Lodge

**NOTES**

1. Figured Dimensions Only to be Taken from this Drawing. All Dimensions to be Checked on Site
2. This drawing to be read in Conjunction with all other Architectural & Engineering drawings & all other relevant drawings & Specification

Date	By	Revision
17/05/21	GW	1. Layout shown as per received on 06/02/21
09/09/18	GW	Proposed layout shown as per received on 06/02/21
16/06/18	GW	Finals Related to Consent with Early Gate
13/05/18	GW	Minor revision to entrance & signage

Project: Rookwood, Ballyboden

Drawing Title: Sight Triangles and Main Access Road at 1:500

Drawn By: Ms Brenda Weir

**ROR PLANNING**

This document is the property of Gordon White Consulting Engineers. It is not to be used, reproduced, disseminated or circulated in whole or in part without the prior written permission in writing of Gordon White Consulting Engineers.



**GORDON WHITE CONSULTING ENGINEERS**

Drawn By: GW  
Scale: 1:500  
Date: 19 Feb 2019  
Drawn No: G1162-05  
J

Professional Survey Ireland License No. 030004121  
OSI © Ordnance Survey Ireland & Government of Ireland

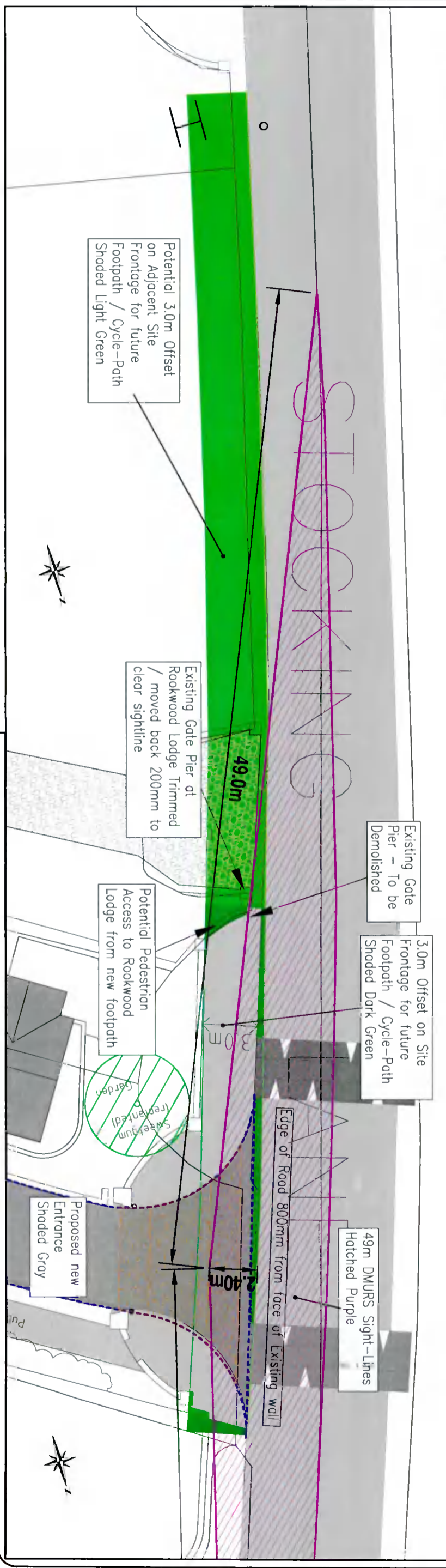
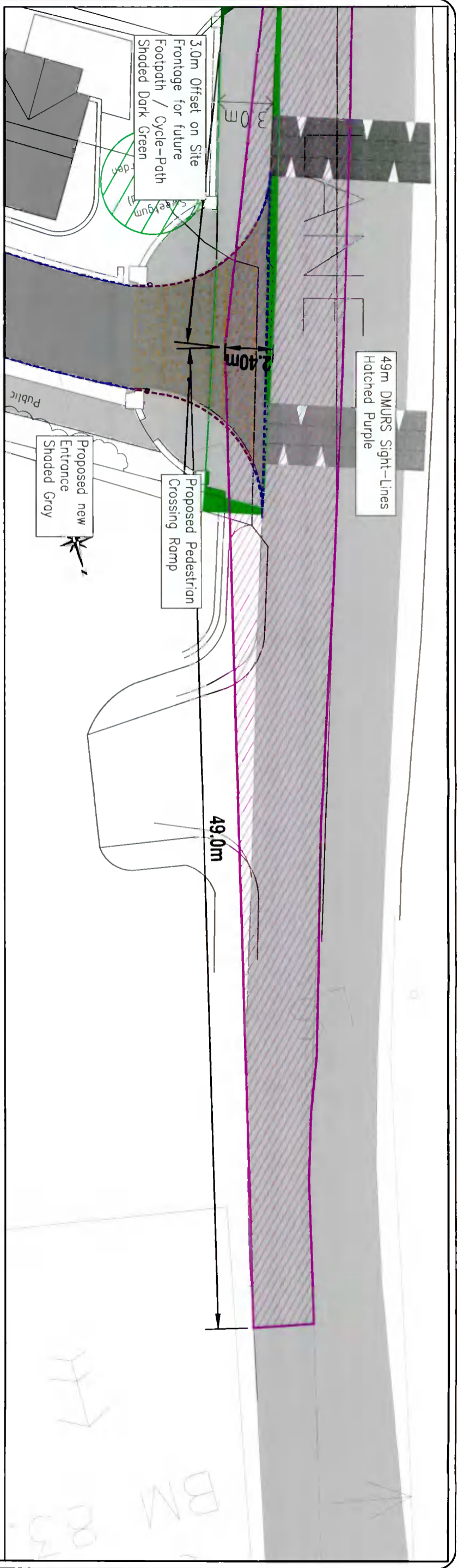

NOTES A3

1. Figured Dimensions Only to be Taken from this Drawing. All Dimensions to be Checked on Site.
2. This drawing to be read in Conjunction with all other Architectural & Engineering drawings & all other relevant drawings & Specification.

Rev	Date	By	Revision
1	18/11/21	GW	Original drawing
2	12/02/21	GW	Layout based on plan received on 06/05/21
3	18/04/18	GW	Layout based on drawing with Existing Gate
4	19/02/18	GW	Minor revision to enhance & highlight detail for future footpath / Cycle-path

FOR PLANNING

Ms Brenda Weir

Project: Rookwood, Ballyboden

Drawing Title: Sight Triangles at 1:200

THIS DOCUMENT IS THE PROPERTY OF GORDON WHITE CONSULTING ENGINEERS. IT IS TO BE USED ONLY FOR THE PROJECT AND SITE SPECIFICALLY IDENTIFIED IN THIS DOCUMENT. IT IS NOT TO BE REPRODUCED, COPIED, OR DISTRIBUTED WITHOUT THE WRITTEN PERMISSION OF GORDON WHITE CONSULTING ENGINEERS.

**GORDON WHITE CONSULTING ENGINEERS**

Mr David J. Gordon, Lead Civil Engineer  
 Mr Gordon White, Chief Building Control Officer  
 Mr Gordon White, Chief Building Control Officer

Mr Gordon White, Lead Civil Engineer  
 Mr Gordon White, Chief Building Control Officer  
 Mr Gordon White, Chief Building Control Officer

Drawn By: GW	Scale: 1:200
Checked By: GW	Date: 19 Feb 2019
Project No: G1162-06	Sheet No: J

OS Licence No. 200004171  
 Ordnance Survey Ireland & Government of Ireland

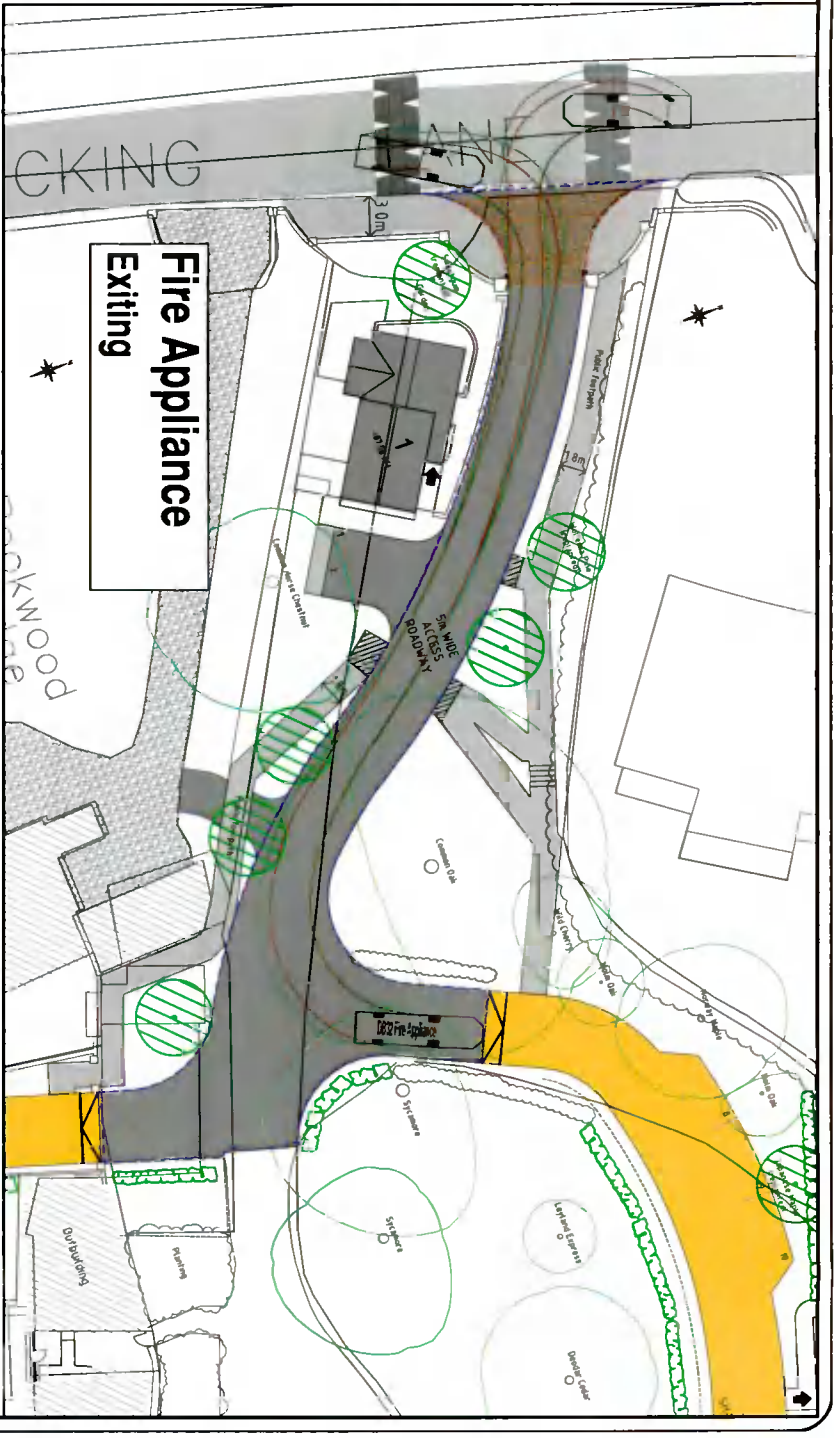
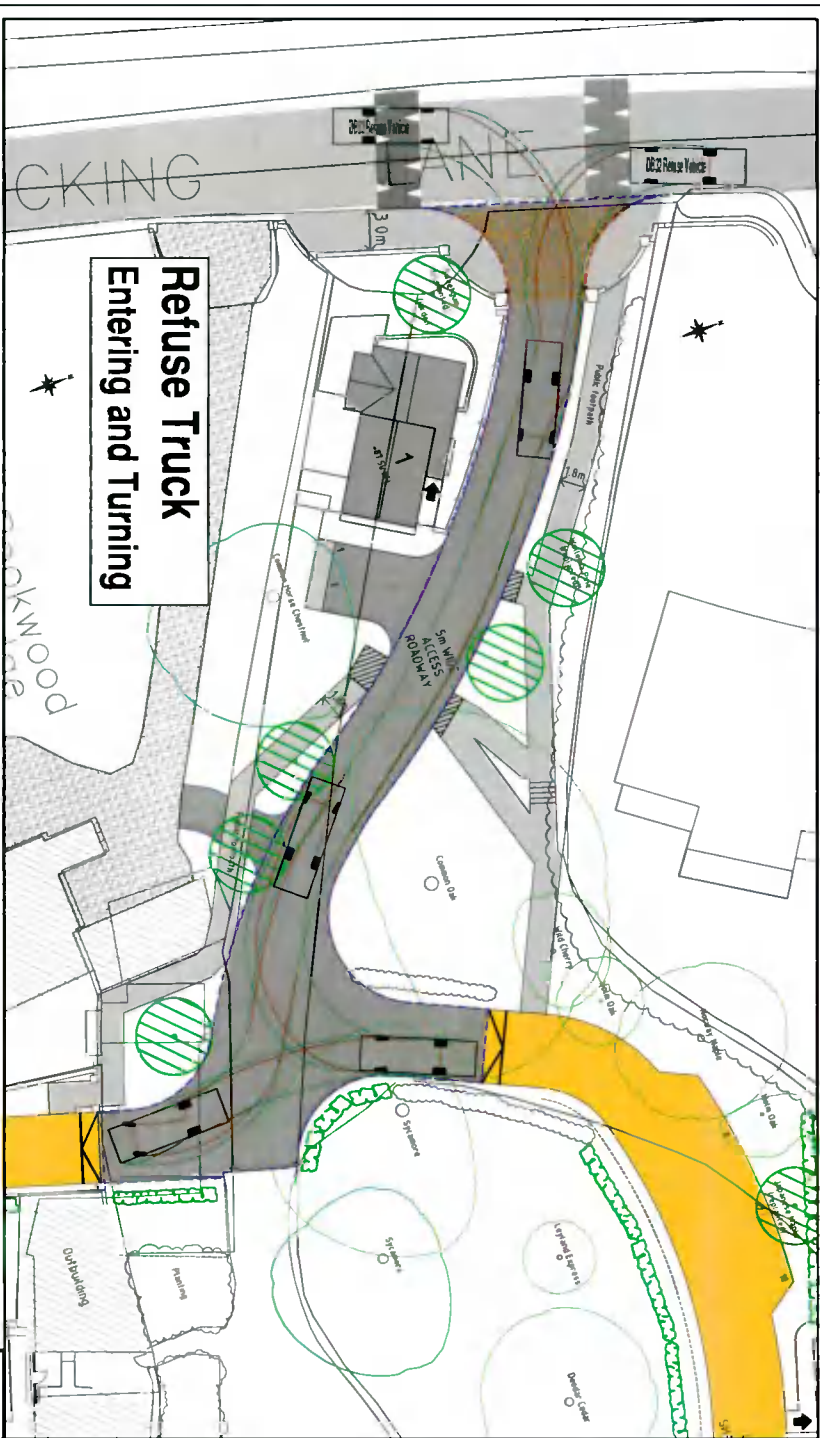
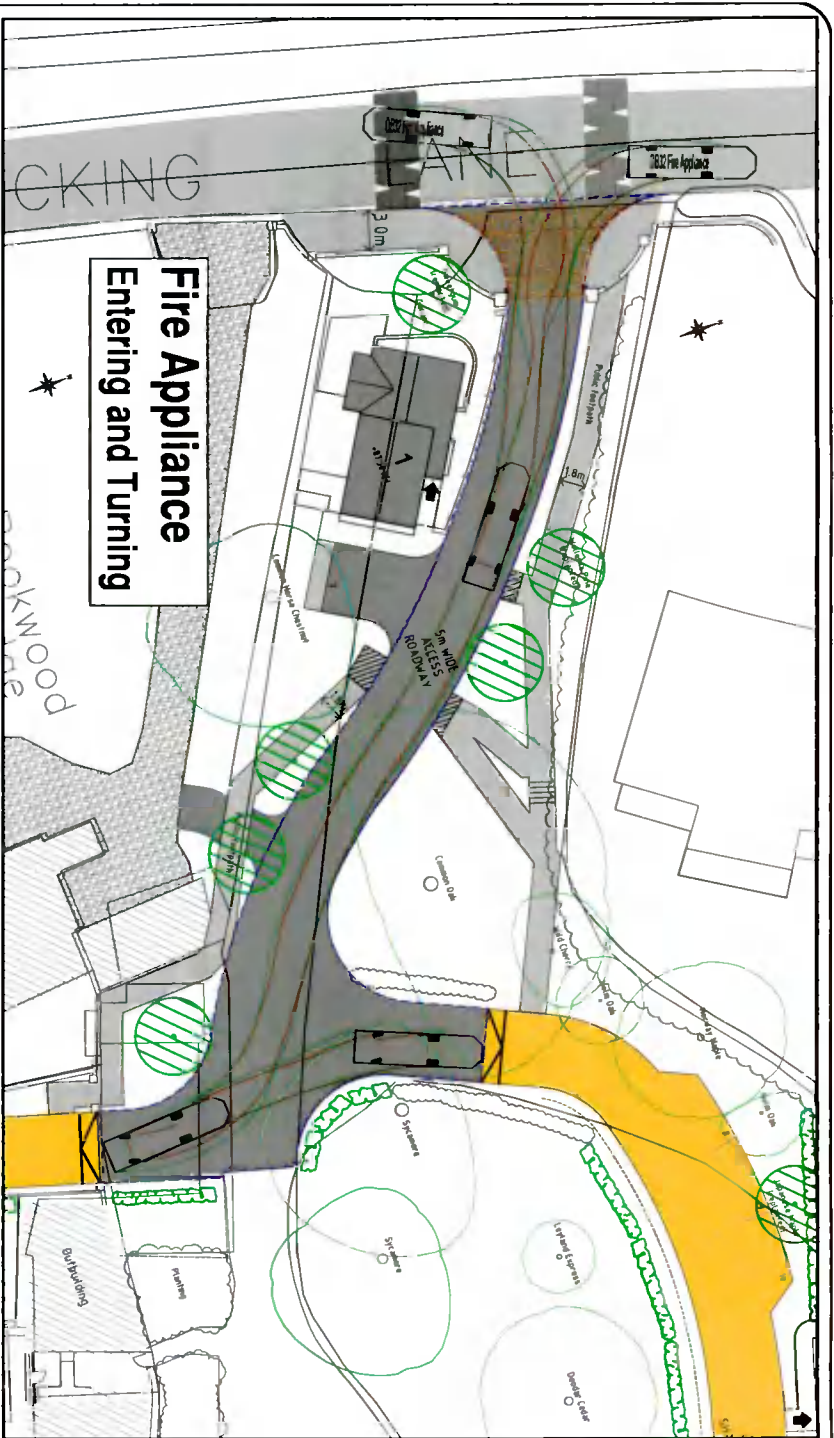

**NOTES**

A3

1. Figured Dimensions Only to be Taken from this Drawing. All Dimensions to be Checked on Site.
2. This drawing to be read in Conjunction with all other Architectural & Engineering drawings & all other relevant drawings & Specification

No.	Date	By	Revision
J	09/03/22	GW	Initial Design
H	12/02/21	WL	Layout Revised as per received Rev 21

**FOR PLANNING**

Client  
Ms Brenda Weir

Project  
Rockwood, Ballyboden

Drawing Title  
Swept Path Assessment  
(AutoTrack) of Access Road

THIS DOCUMENT IS THE PROPERTY OF GORDON WHITE CONSULTING ENGINEERS. IT IS TO BE USED ONLY FOR THE PROJECT AND SITE SPECIFICALLY IDENTIFIED HEREIN. IT IS NOT TO BE REPRODUCED, COPIED, OR OTHERWISE TRANSMITTED IN ANY FORM OR BY ANY MEANS, WITHOUT THE WRITTEN PERMISSION OF GORDON WHITE CONSULTING ENGINEERS.



Scale: 1:500  
Date: 11 Nov 22  
Drawn By: GW

Project No: G1162-07

Professional Engineer License No. 230004171  
Gordon White Consulting Engineers & Government of Ireland