

G DAVENPORT

mooretown ratoath meath info@gdavenport.ie

11/02/2022

REFURB OF EXISTING DWELLING
MOUNT CARMEL, LUCAN OLD ROAD
DUBLIN 20

CLIENT: J & L MUNNELLY

NOTES:

PART OF F.I. SUBMISSION

OS MAP REF NO.: 3195-D

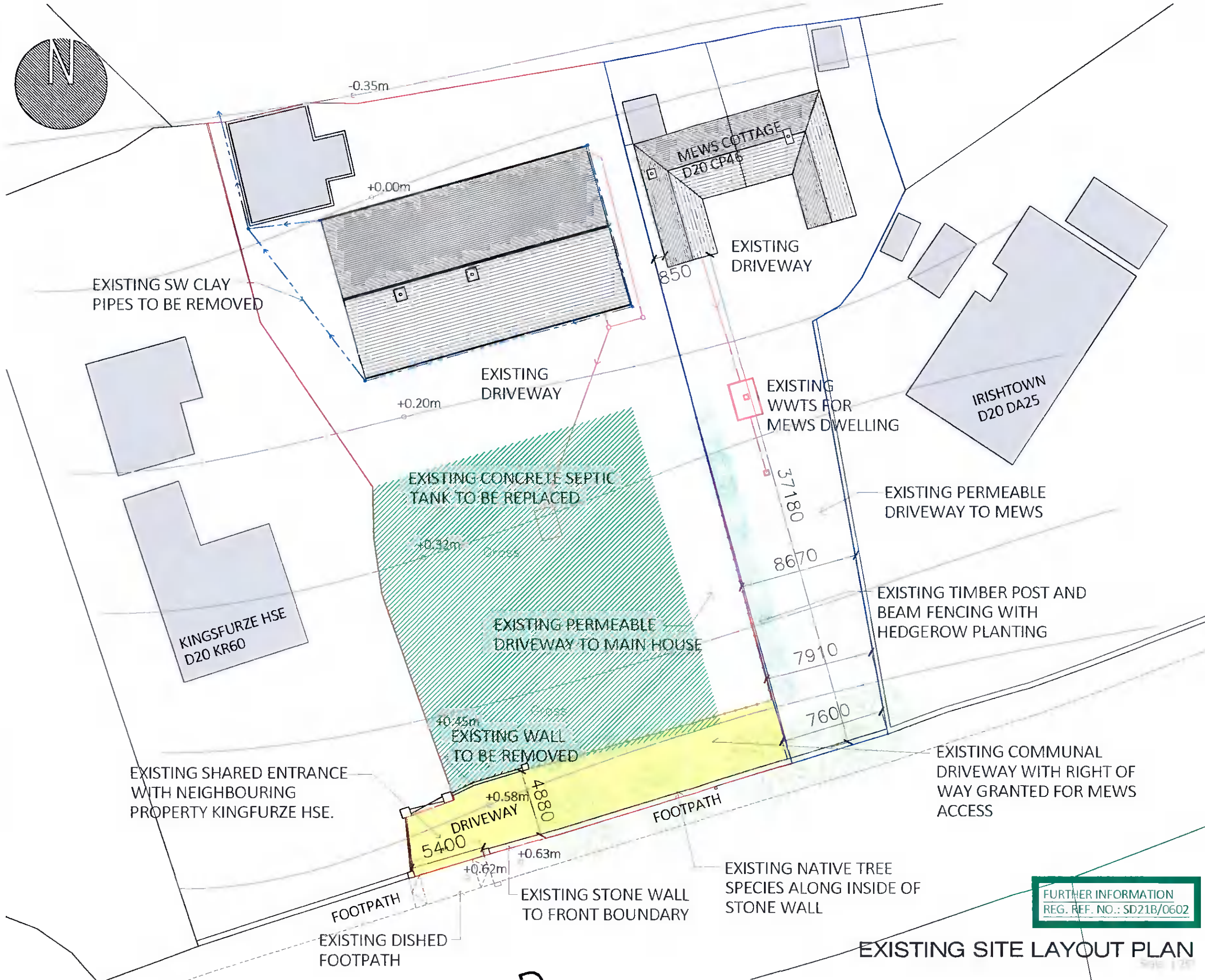

DISCLAIMER
 G Davenport Architecture + Design makes no representation or warranties, express or implied, with respect to the reuse of the data provided herewith, regardless of its format or the means of its transmission. There is no guarantee of representation to the user as to the accuracy, currency, suitability or reliability of this data for any purpose other than that specified in the drawing. The user accepts the data 'as is' and assumes all risks associated with its use. By acceptance of this data, the user agrees not to transmit this data or provide access to any part of it to another party unless the user shall include with the data a copy of this disclaimer.
 G Davenport Architecture + Design assumes no responsibility for actual or consequential damage incurred as a result of any user's reliance on this data.

Notice regarding the Computer Aided Design (CAD) files enclosed. Acceptance of the CAD data is based on the following disclaimer which covers all CAD data received from G Davenport Architecture + Design.

FURTHER INFORMATION
 REG. REF. NO.: SD21B/0602

450F.I.
A3-06

EXISTING SITE LAYOUT PLAN