



**PROPOSED TREE PLANTING**  
To be planted as rootballed stock in the first available planting season after construction. Stock size proposed is as shown and tree support shall be two softwood stakes @ 7.5cm diameter @ 250cm length and should be driven into the ground to knee-height with ties and horizontal cross support. Tree pit 750x750x500mm deep.

**GROUND PREPARATION**  
Soil levels to be raised by 30 cm across new planting areas except in areas where grass is to be retained and the area of ground that goes underneath the existing tree canopies. These areas should not have any change in soil level or be compacted by vehicles or the storage of materials. No removal or damage to existing vegetation should occur.

**PROPOSED SHRUB PLANTING**  
To be planted as container-grown stock in the first available planting season after construction. Stock size/type and densities proposed are as shown below. Shrubs are to be planted in a mix depth of 450mm of approved topsoil overlying clean subsoil previously broken up by the Main Contractor to alleviate any compaction. Area planted to be spread with 75mm deep of approved bark mulch.

**PROPOSED HEDGE PLANTING**  
Native hedgerow planting to be notched planted 300mm apart in double staggered row at 450mm centres with plants of the same species in groups of 3 to 6 to be planted in the first available planting season after construction in a minimum 300mm depth of clean topsoil, with a minimum of 50mm approved bark mulch applied.

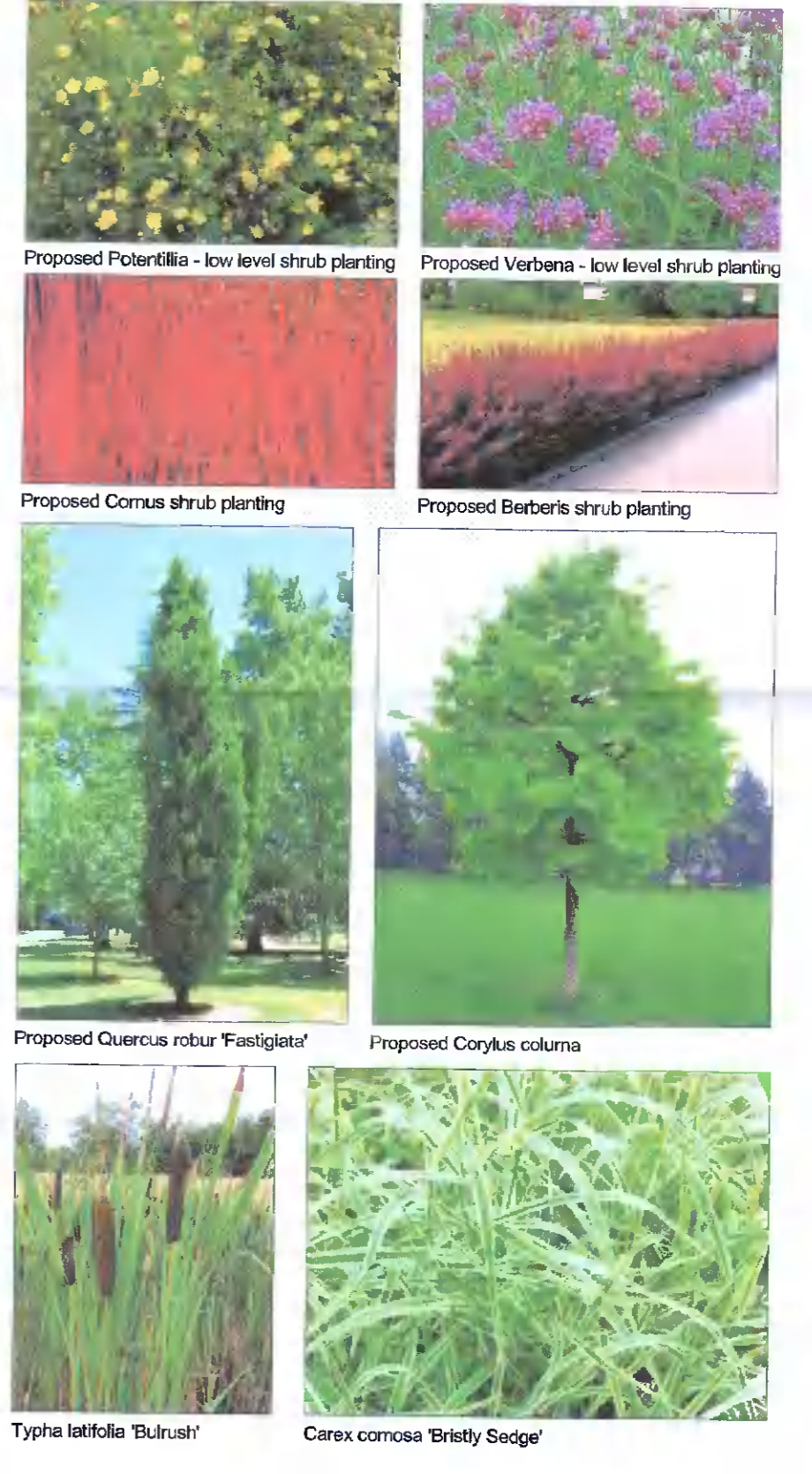

**PROPOSED LANDSCAPING PLAN 1:200**

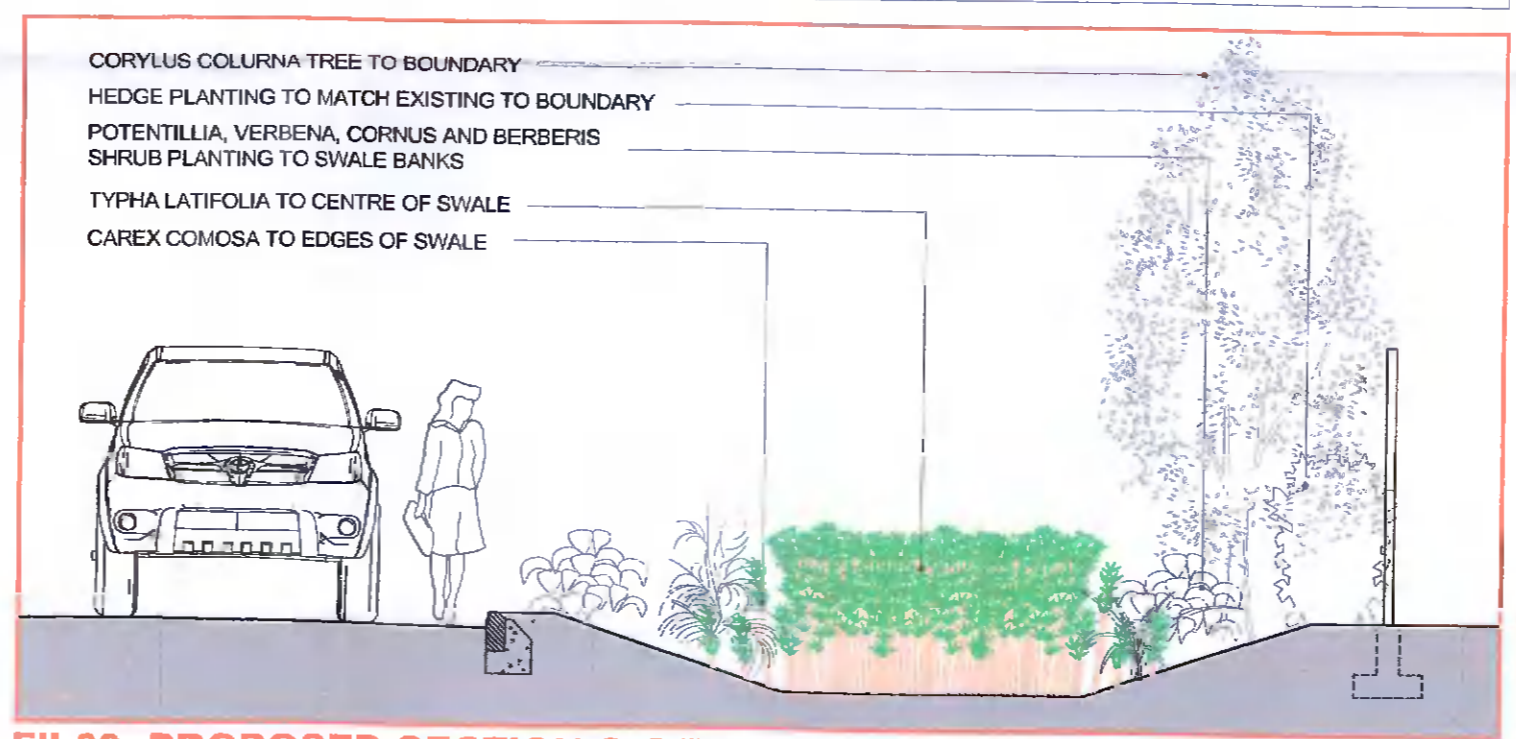

**FIL03: PROPOSED SECTION C-C THROUGH SWALE 1:50**

**SITE TO WHICH APPLICATION RELATES SHOWN RED THIS**

**NOTE:**  
ALL NEW LANDSCAPING TO BE A CONTINUATION & EXTENSION OF THE EXISTING LANDSCAPING.

**FURTHER INFORMATION:**  
REVISIONS IN ORANGE

PROPOSED SHRUB PLANTING				PROPOSED PERENNIAL PLANTING				PROPOSED TREE PLANTING				PROPOSED SHRUB PLANTING			
SPECIES	SIZE (CM)	DENSITY	COND.	SPECIES	SIZE (CM)	DENSITY	COND.	SPECIES	SIZE (CM)	DENSITY	COND.	SPECIES	SIZE (CM)	DENSITY	COND.
Berberis thunbergii	30-40	5/m <sup>2</sup>	C3	Agapanthus primulae veris (cowslip)	11	Quercus robur fastigiata	14-18cm girth	T1	Quercus robur fastigiata	14-18cm girth	----	Rb X 10	Verbena	30-40	5/m <sup>2</sup>
Buddleia davidii	40-60	5/m <sup>2</sup>	C2	Aster perfoliatus (primrose)	13	Corylus colurna	14-18cm girth	T2	Corylus colurna	14-18cm girth	----	Rb X 12	Leucanthemum (ox eye daisy)	80-100	2/m <sup>2</sup>
Cornus alba 'spice'™	80-100	2/m <sup>2</sup>	C10	Campanula persicifolia salvia x sylvestris	13	Betula pendula	14-18cm girth	T3	Betula pendula	14-18cm girth	----	Rb X 3	T3 Betula pendula	80-100	2/m <sup>2</sup>
Hedera helix 'poetica arborea'	30-40	5/m <sup>2</sup>	C3	Delphinium verbena	30-40	5/m <sup>2</sup>	C3	Digitalis (foxglove)	30-40	5/m <sup>2</sup>	C10	Geranium 'johnsons blue'	30-40	5/m <sup>2</sup>	C10
Helleborus	30-40	5/m <sup>2</sup>	C3	Geranium 'johnsons blue'	30-40	5/m <sup>2</sup>	C10	Geranium sanguineum	30-40	5/m <sup>2</sup>	C10	Proposed bulb planting	30-40	5/m <sup>2</sup>	C3
Ilex aquifolium	80-100	2/m <sup>2</sup>	C10	Lavandula angustifolia 'hedgecote'	30-40	5/m <sup>2</sup>	C3	Proposed hedge planting	30-40	5/m <sup>2</sup>	C3	Proposed grass planting	30-40	5/m <sup>2</sup>	C3
Lavandula angustifolia 'hedgecote'	30-40	5/m <sup>2</sup>	C3	Potentilla fruticosa	30-40	5/m <sup>2</sup>	C3	Carpinus betulus	60-80cm	5/m	ER	Typha latifolia	30-40	5/m <sup>2</sup>	C3
Conchocarpus perfoliatus	40-60	5/m <sup>2</sup>	C3	Proposed bulb planting	30-40	5/m <sup>2</sup>	C3	Proposed hedge planting	30-40	5/m <sup>2</sup>	C3	Carex comosa	30-40	5/m <sup>2</sup>	C3
Potentilla fruticosa	30-40	5/m <sup>2</sup>	C3	Rubus tricolor 'betty ashburner'	30-40	5/m <sup>2</sup>	C3	Proposed grass planting	30-40	5/m <sup>2</sup>	C3	Grass	30-40	5/m <sup>2</sup>	C3
Rubus tricolor 'betty ashburner'	30-40	5/m <sup>2</sup>	C3	Sedum spectabile	30-40	5/m <sup>2</sup>	C3	Grasscrete or similar permeable paving	30-40	5/m <sup>2</sup>	C3	Proposed boundary fence	30-40	5/m <sup>2</sup>	C3
Sedum spectabile	30-40	5/m <sup>2</sup>	C3	Verbena bonariensis	30-40	5/m <sup>2</sup>	C3	Proposed boundary fence	30-40	5/m <sup>2</sup>	C3	Site boundary	30-40	5/m <sup>2</sup>	C3
Verbena bonariensis	30-40	5/m <sup>2</sup>	C3	Viburnum davidii	30-40	5/m <sup>2</sup>	C3	Site boundary	30-40	5/m <sup>2</sup>	C3		30-40	5/m <sup>2</sup>	C3
Viburnum davidii	30-40	5/m <sup>2</sup>	C3												

LEGEND	
	VEHICLE CHARGING POINTS
	BOLLARDS
	LED AREA FLOODLIGHT ON LAMP POST (REFER TO SABRE LIGHTING DRAWING)
	UP-LIGHT LUMINAIRE TO SIGNAGE
	GROUND LEVEL DISPLAY LUMINAIRE
	FLOODLIGHT ON BUILDING
	UPLIGHT TO CORNER FEATURE

REV	NOTES	BY	DATE	REV	STA	NOTES	BY	DATE
A	FI ISSUE		08/02/22					

job: EXTENSION & ADDITIONAL SITE DEVELOPMENT  
 site: TOYOTA LUFFY VALLEY  
 client: TOM STAUNTON  
 drawing: PROPOSED LANDSCAPING PLAN

job: 20101  
 site: FI 1-04  
 client: JAN '22  
 drawing: 1:200 (1.50 @ A)