



**Notes:**  
 - Do not scale from this drawing. Use figured dimensions in all cases.  
 - Verify dimensions on site and report any discrepancies to the Architect immediately.  
 - This drawing is to be read in conjunction with the Architect's Specification.  
 - © This drawing is copyright and may only be reproduced with the Architect's permission.

**Drawing Notes:**

**AMENDMENTS LEGEND**

- 1.) Reconfiguration of the approved basement layout.
- 2.) Removal of consented core & re-configuring of internal space.
- 3.) Ground floor alterations proposed to facilitate the introduction of a larger commercial unit capable of accommodating a small supermarket.
- 4.) Consented creche re-located to block C.
- 5.) Consented substation & switchroom relocated to block A.
- 6.) Amalgamation and consolidation of communal amenity space.
- 7.) Core C omission and associated alterations to Blocks C and D.
- 8.) Common corridor reduced to 1350mm from 1800mm.
- 9.) Party Wall moved 803mm to accommodate array of 1 bedroom apartments in lieu of 2 central studio apartments.
- 10.) New studio apartment type.
- 11.) New one-bed apartment type.
- 12.) New two-bed apartment type.
- 13.) Minor alteration to previously approved facades, building line and internal partition walls and slight increase apartments nos.

-  Consented location subject to amendment.
-  Proposed change of use / mix.

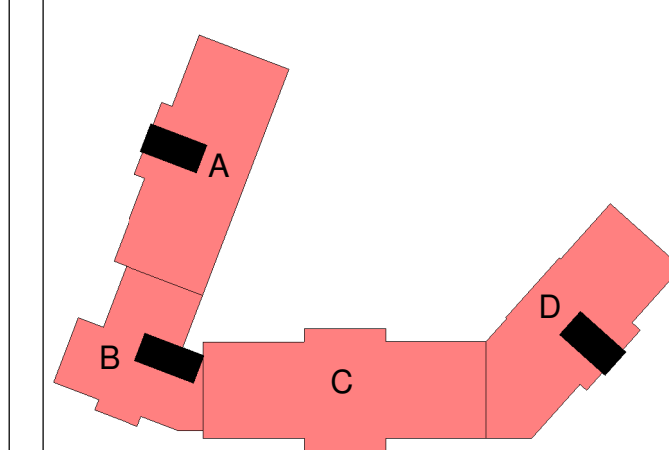

Rev.	Date	Drawn	For planning amendment	Details of Issue / Revision
P1	01/10/21	IOB	For planning amendment	



Dartry Mills,  
 Dartry Road  
 Dublin 6,  
 D06 Y0E3  
 T: +353 (0)1 498 7000  
 W: www.reddyarchitecture.com  
 E: info@reddyarchitecture.com

Client Details:  
**Stranwil Limited**

Project Details:  
**Units 5A-C, Second Avenue.**

Drawing Title:  
**Proposed 2nd - 5th Floor Plan**

Job No. <b>P21-134D</b>	Sheet Size: <b>A1</b>	Scale @A1: <b>1:200</b>
Issue Date: <b>01/10/21</b>	Drawn By: <b>IOB</b>	Reviewed By: <b>E.O'Brien</b>

Status: <b>P3</b>	Purpose of Issue: <b>For planning amendment</b>
Project - System - Spatial Zone - Level - Type - Originator - Role - Number	
<b>CRD-Z-05-XX-L02-DR-RAU-AR-1102</b>	<b>P1</b>

**L02-L05 APARTMENT SCHEDULE**

SECOND FLOOR			
Number	Apt.	Type	Block
Apt 015	1 Bed (2p)	1 Bed Type 02	A
Apt 016	1 Bed (2p)	1 Bed Type 02	A
Apt 079	Studio	Studio Type 2	C
Apt 080	Studio	Studio Type 1	C
Apt 081	1 Bed (2p)	1 Bed Type 05	C
Apt 084	1 Bed (2p)	1 Bed Type 02	C
Apt 085	1 Bed (2p)	1 Bed Type 02	C
Apt 091	1 Bed (2p)	1 Bed Type 02	D
Apt 092	1 Bed (2p)	1 Bed Type 02	D
Apt 094	1 Bed (2p)	1 Bed Type 05	C
Apt 095	1 Bed (2p)	1 Bed Type 05	C
Apt 096	2 Bed (4p)	2 Bed 4P Type 4	C
Apt 097	2 Bed (4p)	2 Bed 4P Type 4	C
Apt 098	1 Bed (2p)	1 Bed Type 05	C
Apt 099	1 Bed (2p)	1 Bed Type 04	C

THIRD FLOOR			
Number	Apt.	Type	Block
Apt 023	1 Bed (2p)	1 Bed Type 02	A
Apt 024	1 Bed (2p)	1 Bed Type 02	A
Apt 105	Studio	Studio Type 2	C
Apt 106	Studio	Studio Type 1	C
Apt 107	1 Bed (2p)	1 Bed Type 05	C
Apt 110	1 Bed (2p)	1 Bed Type 02	C
Apt 111	1 Bed (2p)	1 Bed Type 02	C
Apt 117	1 Bed (2p)	1 Bed Type 02	D
Apt 118	1 Bed (2p)	1 Bed Type 02	D
Apt 120	1 Bed (2p)	1 Bed Type 05	C
Apt 121	1 Bed (2p)	1 Bed Type 05	C
Apt 122	2 Bed (4p)	2 Bed 4P Type 4	C
Apt 123	2 Bed (4p)	2 Bed 4P Type 4	C
Apt 124	1 Bed (2p)	1 Bed Type 05	C
Apt 125	1 Bed (2p)	1 Bed Type 04	C

FOURTH FLOOR			
Number	Apt.	Type	Block
Apt 031	1 Bed (2p)	1 Bed Type 02	A
Apt 032	1 Bed (2p)	1 Bed Type 02	A
Apt 131	Studio	Studio Type 2	C
Apt 132	Studio	Studio Type 1	C
Apt 133	1 Bed (2p)	1 Bed Type 05	C
Apt 136	1 Bed (2p)	1 Bed Type 02	C
Apt 137	1 Bed (2p)	1 Bed Type 02	C
Apt 143	1 Bed (2p)	1 Bed Type 02	D
Apt 144	1 Bed (2p)	1 Bed Type 02	D
Apt 146	1 Bed (2p)	1 Bed Type 05	C
Apt 147	1 Bed (2p)	1 Bed Type 05	C
Apt 148	2 Bed (4p)	2 Bed 4P Type 4	C
Apt 149	2 Bed (4p)	2 Bed 4P Type 4	C
Apt 150	1 Bed (2p)	1 Bed Type 05	C
Apt 151	1 Bed (2p)	1 Bed Type 04	C

FIFTH FLOOR			
Number	Apt.	Type	Block
Apt 039	1 Bed (2p)	1 Bed Type 02	A
Apt 040	1 Bed (2p)	1 Bed Type 02	A
Apt 157	Studio	Studio Type 2	C
Apt 158	Studio	Studio Type 1	C
Apt 159	1 Bed (2p)	1 Bed Type 05	C
Apt 162	1 Bed (2p)	1 Bed Type 02	C
Apt 163	1 Bed (2p)	1 Bed Type 02	C
Apt 169	1 Bed (2p)	1 Bed Type 02	D
Apt 170	1 Bed (2p)	1 Bed Type 02	D
Apt 172	1 Bed (2p)	1 Bed Type 05	C
Apt 173	1 Bed (2p)	1 Bed Type 05	C
Apt 174	2 Bed (4p)	2 Bed 4P Type 4	C
Apt 175	2 Bed (4p)	2 Bed 4P Type 4	C
Apt 176	1 Bed (2p)	1 Bed Type 05	C
Apt 177	1 Bed (2p)	1 Bed Type 04	C

L02 - L05 Second Floor To Fifth Floor  
 1 : 200