

**CARPARK BREAKDOWN**

SPACES:	61
DAC SPACES:	06
TOTAL:	67
<b>TOTAL BIKE SPACES: 316 SPACES (LONG STAY)</b>	

Secure Bicycle Store A  
12 no. Double stackers  
4 Bicycles Per Stackers  
Total 48 Bicycles

Secure Bicycle Store B  
42 no. Double stackers  
4 Bicycles Per Stackers  
Total 168 Bicycles

Secure Bicycle Store C  
25 no. Double stackers  
4 Bicycles Per Stackers  
Total 100 Bicycles

**Notes:**  
- Do not scale from this drawing. Use figured dimensions in all cases.  
- Verify dimensions on site and report any discrepancies to the Architect immediately.  
- This drawing is to be read in conjunction with the Architect's Specification.  
- © This drawing is copyright and may only be reproduced with the Architect's permission.

**Drawing Notes:**

**AMENDMENTS LEGEND**

- 1.) Reconfiguration of the approved basement layout.
- 2.) Removal of consented core & re-configuring of internal space.
- 3.) Ground floor alterations proposed to facilitate the introduction of a larger commercial unit capable of accommodating a small supermarket.
- 4.) Consented creche re-located to block C.
- 5.) Consented substation & switchroom relocated to block A.
- 6.) Amalgamation and consolidation of communal amenity space.
- 7.) Core C omission and associated alterations to Blocks C and D.
- 8.) Common corridor reduced to 1350mm from 1800mm.
- 9.) Party Wall moved 803mm to accommodate array of 1 bedroom apartments in lieu of 2 central studio apartments.
- 10.) New studio apartment type.
- 11.) New one-bed apartment type.
- 12.) New two-bed apartment type.
- 13.) Minor alteration to previously approved facades, building line and internal partition walls and slight increase apartments nos.

- Consented location subject to amendment.
- Proposed change of use / mix.

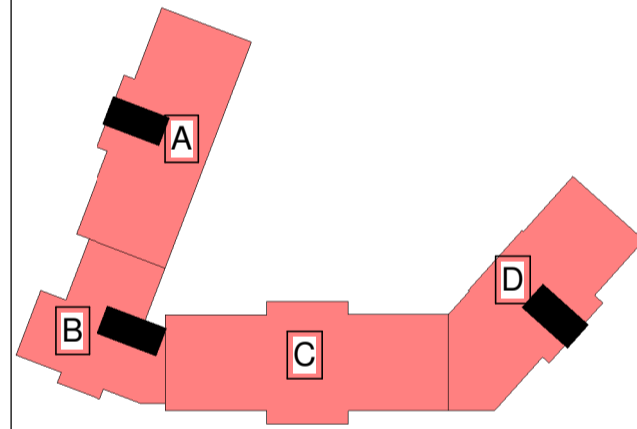

Rev.	Date	Drawn	Details of Issue / Revision
Issues & Revisions			

**reddyQ+U**

Dartry Mills,  
Dartry Road  
Dublin 6,  
D06 Y0E3  
T: +353 (0)1 498 7000  
W: www.reddyarchitecture.com  
E: info@reddyarchitecture.com

Client Details:  
**M.B McNamara Construction**

Project Details:  
**Units 5A-C,  
Second Avenue.**

Drawing Title:  
**Proposed Basement Plan**

Job No. <b>P21-134D</b>	Sheet Size: <b>A1_</b>	Scale @A1: <b>1:200</b>
Issue Date: <b>01/10/21</b>	Drawn By: <b>IOB</b>	Reviewed By: <b>EOB</b>

Status: **P3** Purpose of Issue: **For planning amendment**

Project - System - Spatial Zone - Level - Type - Originator - Role - Number	Revision
<b>CRD-Z-SW-ZZZ-M3-RAU-AR-1099</b>	<b>P1</b>

Proposed Basement Plan  
1:200