

IN TERMS OF ELECTRIC CHARGE POINTS FOR CARS THE ENTIRE CAR PARK WILL BE DUCTED TO ACCEPT CABLING TO SERVE A CHARGING POINT FOR EVERY CAR SPACE. CONDUITS WILL BE RUN ON THE WALLS WHERE CHARGING POINTS CAN ALSO BE MOUNTED AS REQUIRED. WHERE A CHARGING POINT IS REQUESTED TO BE INSTALLED, THE RELEVANT CHARGING POINT WILL BE PRE-WIRED BACK TO THEIR HOME ELECTRICITY METER IN THE DESIGNATED METER LOCATION. THE SOCKET POINT WILL HAVE A LOCKABLE COVER ON IT SO THAT ONLY THAT USER MAY USE THE POWER POINT. THIS PROVISION AROUND THE PARKING AREA ALLOWS FUTURE CHARGING POINTS TO BE INSTALLED AT ANY OF THE CAR PARKING SPACES WITH MINIMUM WORKS AS AND WHEN REQUIRED. A TYPICAL DUCTING LAYOUT IS ENCLOSED.

WE PROPOSE TO ALLOCATE 12 CAR PARKING SPACES TO GO-CAR.

10% OF THE OVERALL CAR PARKING SPACES TO BE ALLOCATED FOR CHARGING SPOTS FOR BATTERY OPERATED CARS

### Area Type

- Car Park
- Circulation
- Communal
- Services
- Major Vertical Penetration

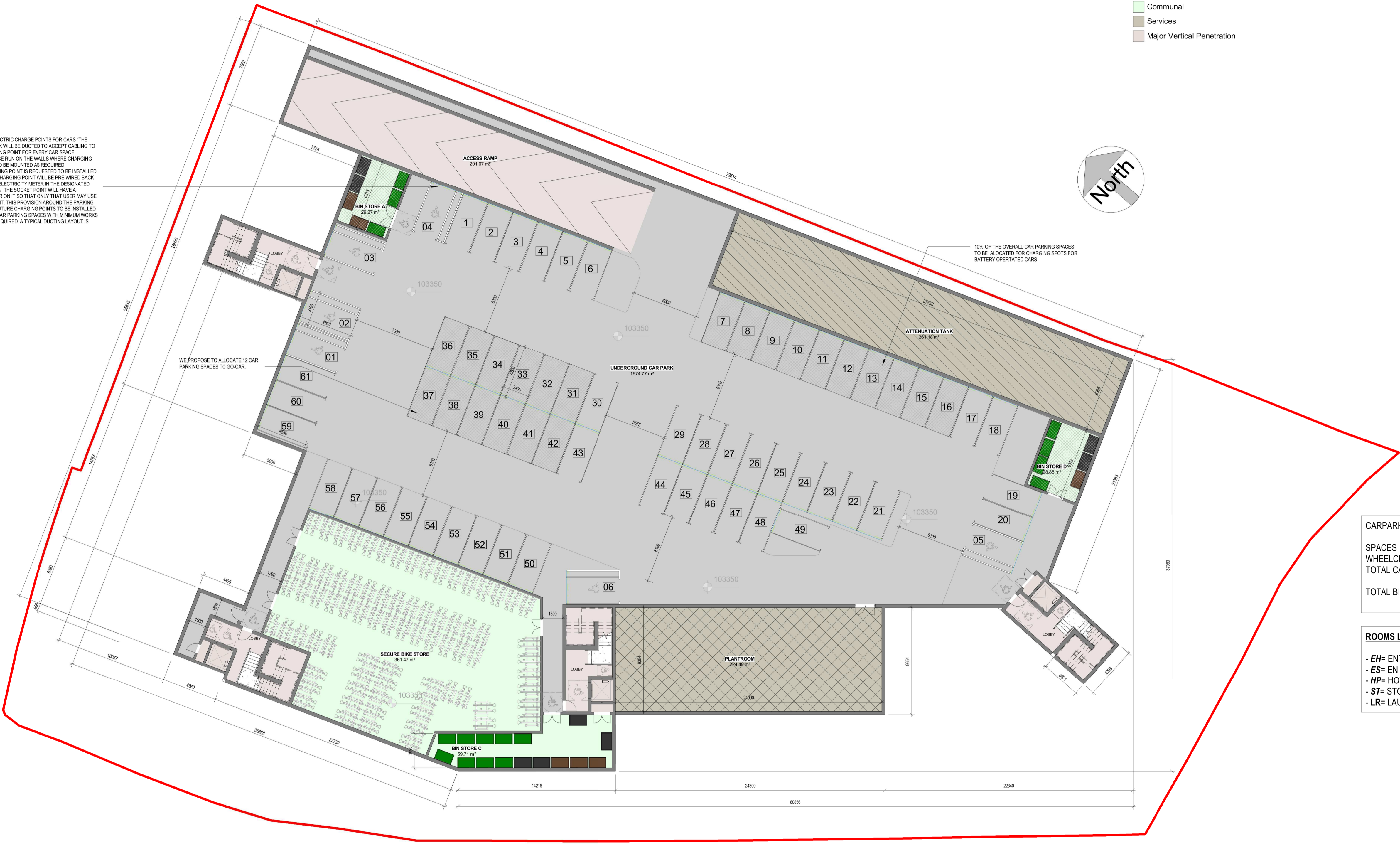
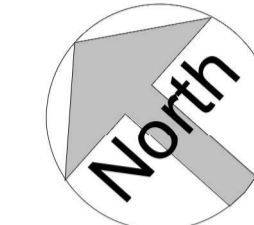

**CARPARK BREAKDOWN:**

SPACES	61
WHEELCHAIR SPACES	06
TOTAL CAR SPACES:	67
TOTAL BIKE SPACES: 300(RESIDENTS)	

- ROOMS LEGEND:**
- EH= ENTRANCE HALL
  - ES= EN SUITE
  - HP= HOT PRESS
  - ST= STORAGE
  - LR= LAUNDRY ROOM

**Notes:**

- Do not scale from this drawing. Use figured dimensions in all cases.
- Verify dimensions on site and report any discrepancies to the Architect immediately.
- This drawing is to be read in conjunction with the Architect's Specification.
- © This drawing is copyright and may only be reproduced with the Architect's permission.

**Drawing Notes:**

Rev.	Date	Drawn	IOB	Consented	Details of Issue / Revision
P1	01/10/21				Issues & Revisions

Dartry Mills,  
Dartry Road  
Dublin 6,  
D06 Y0E3  
T: +353 (0)1 498 7000  
W: www.reddyarchitecture.com  
E: info@reddyarchitecture.com

Client Details:  
**Stranwil Limited**

Project Details:  
**Units 5A-C,  
Second Avenue.**

Drawing Title:  
**Consented Basement Plan**

Job No.	Sheet Size:	Scale @A1:
<b>P21-134D</b>	<b>A1_Landscape</b>	<b>1:200</b>
Issue Date:	Drawn By:	Reviewed By:
<b>01/10/21</b>	<b>IOB</b>	<b>EOB</b>

Status	Purpose of Issue
<b>P3</b>	<b>Consented</b>

Project - System - Spatial Zone - Level - Type - Originator - Role - Number	Revision
<b>CRD-Z-SW-ZZZ-M3-RAU-AR-10B1</b>	<b>P1</b>

**B01 Basement Level General Arrangement Plan (Consented)**  
1 : 200