

- NOTES**
1. THIS DRAWING IS TO BE READ IN CONJUNCTION WITH ALL OTHER RELEVANT ARCHITECTURAL AND ENGINEERING DRAWINGS. ANY DISCREPANCIES, ERRORS OR OMISSIONS TO BE BROUGHT TO THE ATTENTION OF THE DESIGNER.
 2. ALL DIMENSIONS TO BE CHECKED BY THE CONTRACTOR ON SITE PRIOR TO COMMENCEMENT OF WORKS.
 3. AECOM LIMITED TO BE INFORMED BY THE CONTRACTOR OF ANY DISCREPANCIES PRIOR TO THE COMMENCEMENT OF WORKS ON SITE.
 4. DIMENSIONS OF ALL BOUNDARIES AND ADJOINING ROADS TO BE CHECKED ON SITE PRIOR TO COMMENCEMENT OF WORKS.
 5. DO NOT SCALE. ALL MEASUREMENTS AND COORDINATES TO BE CHECKED ON SITE.



ISSUE/REVISION		
I/R	DATE	DESCRIPTION
0	28.10.2021	ISSUED FOR PLANNING

PROJECT NUMBER
60556657

SHEET TITLE
PROPOSED GENERAL ARRANGEMENT

SHEET NUMBER
PAM-ACM-XX-00-DR-CE-01-0001

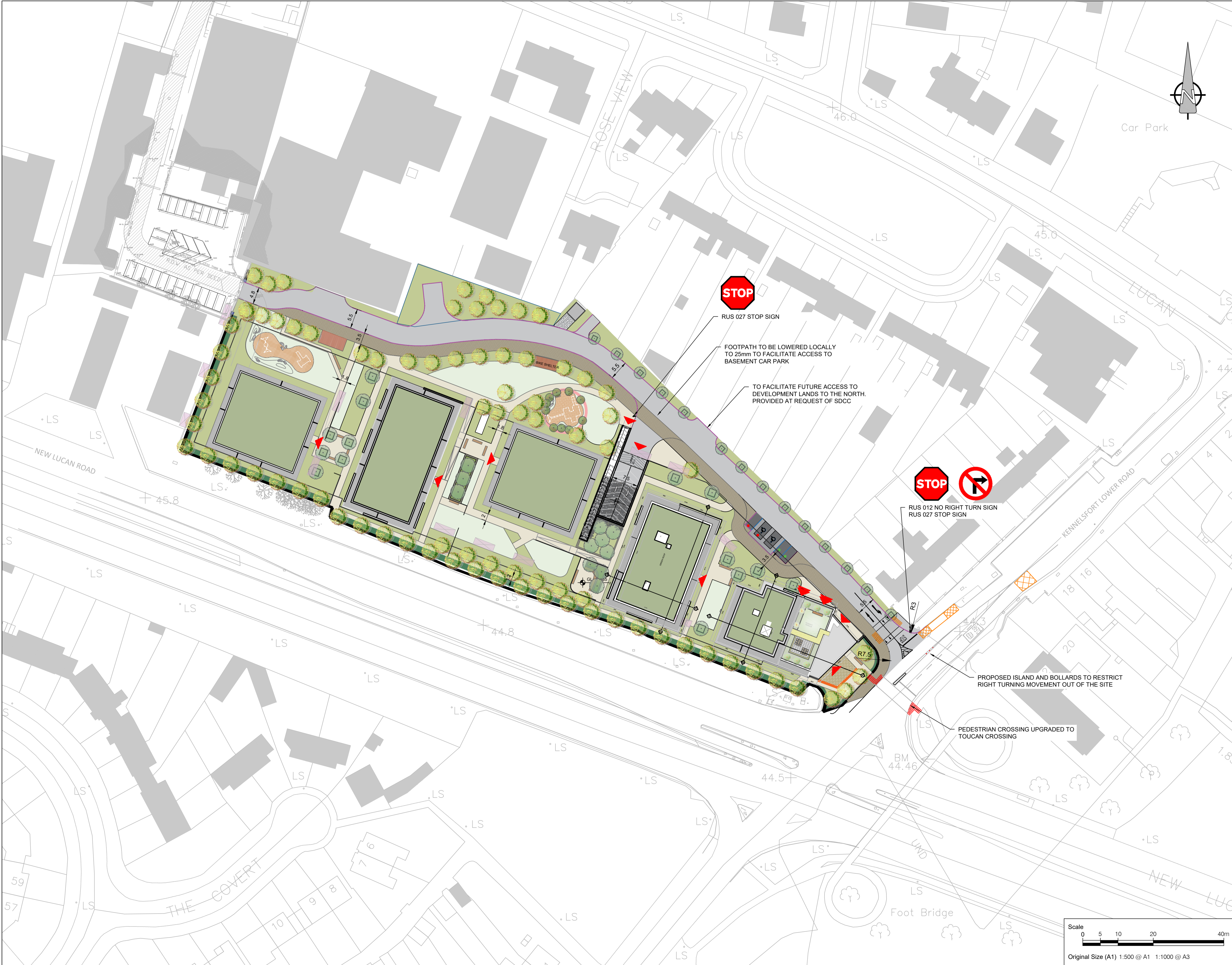

Project Management Initials: Designer: MC Checked: ZC Approved: EMLK
 ISO A1 594mm x 841mm
 Last saved by: MICHAEL COLLINS(2021.10.21) Last Plotted: 2021.10.28
 Filename: L:\EGACY\IEDB\FP001\UFI\UOSS\PR-224738_PALMERSTOWN_MONT1800_CAD_GIS\904_CE\01_WIP\02_SHEETS\PAM-ACM-XX-00-DR-CE-01-0001.DWG
 Printed on 100% Recycled Content Paper

This drawing has been prepared for the use of AECOM's client. It may not be used, modified, reproduced or relied upon by third parties, except as agreed by AECOM or as required by law. AECOM accepts no responsibility, and denies any liability, whatsoever, to any party that uses or relies on this drawing without AECOM's express written consent. Do not scale this document. All measurements must be obtained from the stated dimensions.