



Notes

- 1.0 Do not scale
- 1.1 All dimensions are in metres unless specified
- 1.2 Assume all site details are existing unless stated
- 1.3 All mapping reproduced with permission of the Ordnance Survey of Ireland. Licence number EN 0023719-24

Existing Disused Pylon

Existing Ground-mounted Cabin
-Exempted Development Under Class 31(e)

Existing 25 Monopole

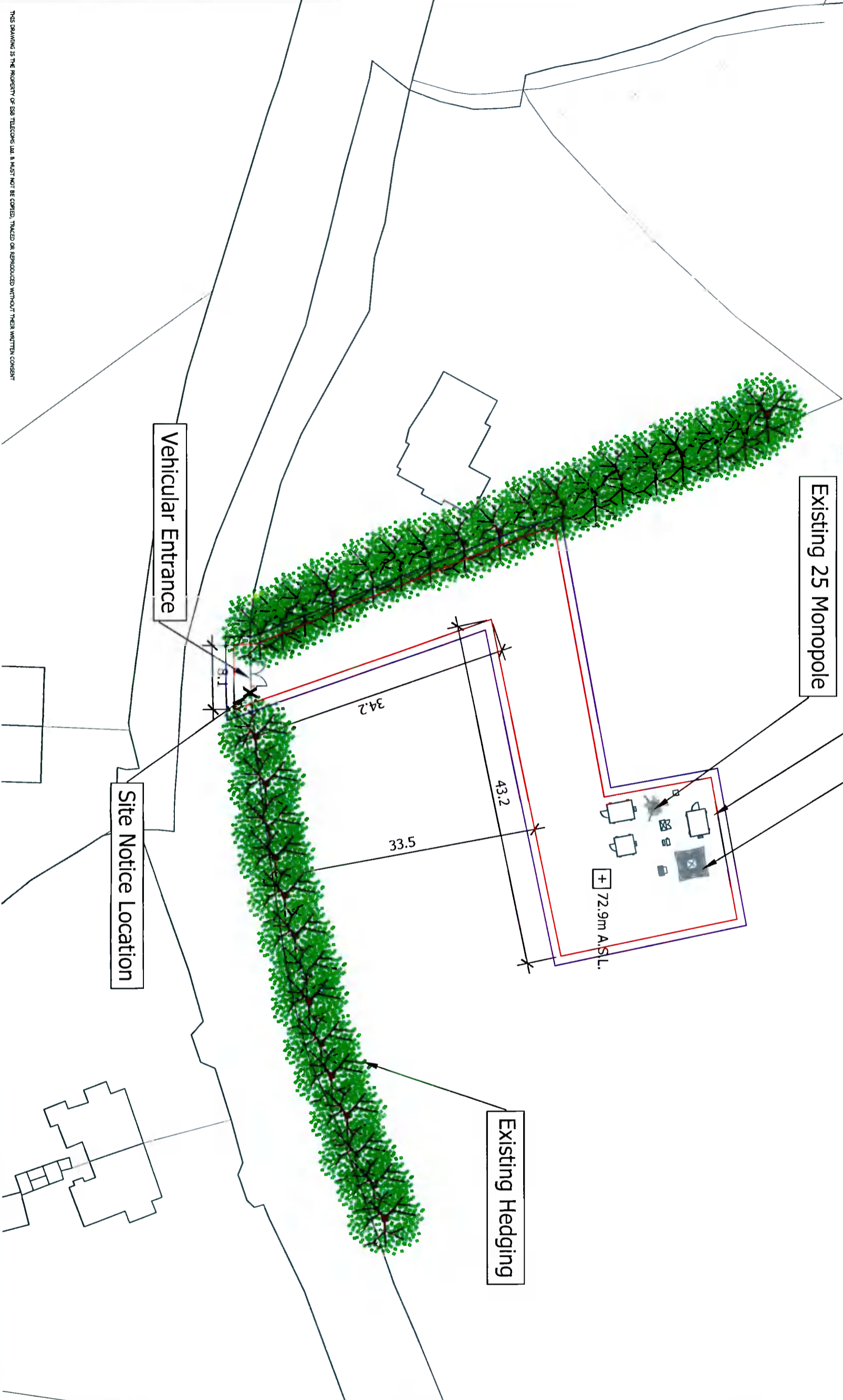

Existing Hedging

Vehicular Entrance

Site Notice Location

Structure Details:
Height:- 25m
Type:- Monopole
Colour:- Grey

Power Supply:
Mini Pillar On Site

Site Details:
Development Area:- 1005.1 m² (outlined in red)
Ownership Area:- 1005.1 m² (outlined in blue)

Site Access:
Access is via Old Nangor Road

Site Co-ordinates:

Irish National Grid	304916
Co-ordinate EASTING	231033
Irish Transverse Mercator Grid	704843
Co-ordinate EASTING	731060

Warning

THIS MAP INDICATES THE APPROXIMATE LOCATION OF MAIN ESB CABLES IN THE GENERAL AREA OF THE PROPOSED EXCAVATION. THE FOLLOWING PROCEDURES/CONDITIONS MUST BE STRICTLY ADHERED TO:
1. BEFORE ANY EXCAVATION BY MECHANICAL MEANS IS UNDERTAKEN, THE EXACT LOCATION OF THE CABLES MUST BE ESTABLISHED BY:
(a) USING CABLE LOCATION EQUIPMENT
(b) MANUALLY EXCAVATED TRENCHES
2. CABLE DEPTHS CANNOT BE ASSUMED
3. ESB MUST BE NOTIFIED AGAINST ANY CLAIMS DUE TO ACCIDENTS OR DAMAGES FROM ANY REASON.
SEE ATTACHED DRAWING FOR MORE DETAILS. THIS ARE NOT OUTLINE.

REV.	DATE	DESCRIPTION	CHK.	APP.

ESB Telecoms Ltd.
Block 2 Swift Square,
Northwood,
Dublin 9.
Ph: 01-7027051
Fax: 01-6388218

Address:
ESB Telecoms Ltd. compound,
Nangor Road,
Clondalkin,
Dublin 22.

Title: Nangor Road 2022_Site Layout Plan
Drawing No: Nangor Road_PI_02

Issue Date: 02 - 02 - 2022
Drawn By: N. Fitzpatrick

Scale: 1:500
OS Map Ref: 332607
Sheet: 3326-a