

NOTE:  
NO ADDITIONAL  
STRUCTURAL SUPPORTS  
ARE REQUIRED FOR  
CONVERSION OF ATTIC  
SPACE

NOTES:  
ALL TIMBERS TO BE SCB AND IN  
ACCORDANCE WITH SR 11 1991.  
PROVIDE LATERAL SUPPORT TO  
WALLS WHERE THEY RUN PARALLEL  
TO JOISTS, BY FIXING 30X6MM GALV.  
M.S. STRAPS AT 2M CRS ACROSS 2  
NO JOISTS.  
SOLID NOGGING PIECES TO BE FIXED  
DIRECTLY UNDER STRAPS. DITTO  
ALONG ROOF SLOPE.  
INSULATION BETWEEN RAFTERS TO  
BUILDING REGULATIONS.  
PROVIDE 50MM UNOBSTRUCTED AIR  
SPACE BETWEEN INSULATION AND  
ROOF FELT. PROVIDE VENTILATION AT  
EAVES TO PROMOTE CROSS  
VENTILATION 10MM STRIP FULL  
LENGTH

**PROPOSED SECTION VIEW**

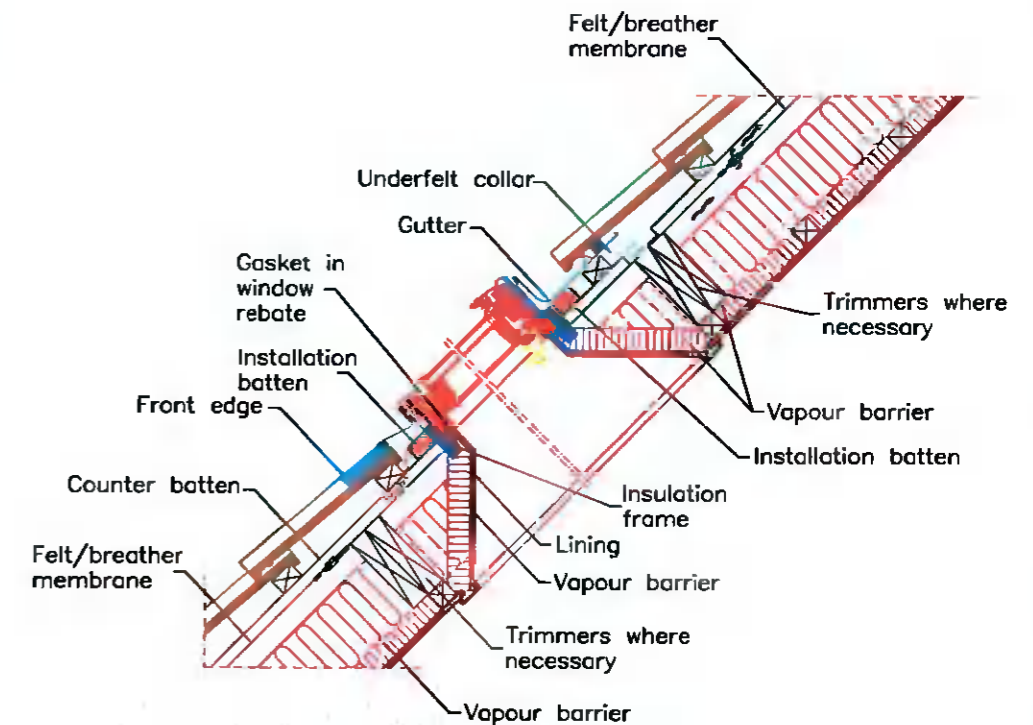

**TYPICAL ROOF WINDOW DETAIL**



The information contained in this drawing is confidential and must not be divulged to any third party without the written consent of 4bes Design Services.



38 Larkfield Avenue  
Lucan  
Co. Dublin

10 Shackleton Square,  
Lucan  
Co. Dublin

**PROPOSED SECTIONS AND  
DETAILS**

DRAWN	JOHN FORBES , 38 LARKFIELD AVE. , LUCAN, Co. DUBLIN	
DATE	Jan 2022	Kristina Trufanova and Ilya Trufanov
SCALE	1:50 @ A3	

**SS - 8**