

1. Figured Dimensions Only to be Taken from this Drawing. All Dimensions to be Checked on Site.
2. This drawing to be read in conjunction with all other Architectural & Engineering drawings & all other relevant drawings & Specification.
3. Layout is based on OS mapping. Contours are derived from OS LiDAR Data.

Rev.	Date	By	Revision

FOR PLANNING

Client
Paula & Barry Egan

Project
STABLES CONVERSION AT WINDMILL HILL, RATHCOOLE

Drawing Title
EXISTING AND PROPOSED WASTEWATER DRAINAGE

THE ACCURACY OF THE INFORMATION CONTAINED HEREIN IS THE SOLE RESPONSIBILITY OF THE CLIENT. THE INFORMATION CONTAINED HEREIN IS INTENDED TO BE USED FOR THE PURPOSES SPECIFIED AND IS NOT TO BE USED FOR ANY OTHER PURPOSES WITHOUT THE WRITTEN PERMISSION IN SUCH RESPECT OF GORDON WHITE CONSULTING ENGINEERS. © PROPERTY OF GORDON WHITE CONSULTING ENGINEERS

GORDON WHITE
CONSULTING ENGINEERS
1st Floor, 8 Riverbank, Lake Drive,
Clydesdale Business Campus,
Dublin 24, D24 1A9P
Tel: (01) 479 6396 Mobile: (086) 230 6216
e-mail: info@gw.ie web: www.gw.ie

Drawn By	GW	Scale	1:500
Client Ref. No.	07 Oct '21		
Draw No.	G1286-02		

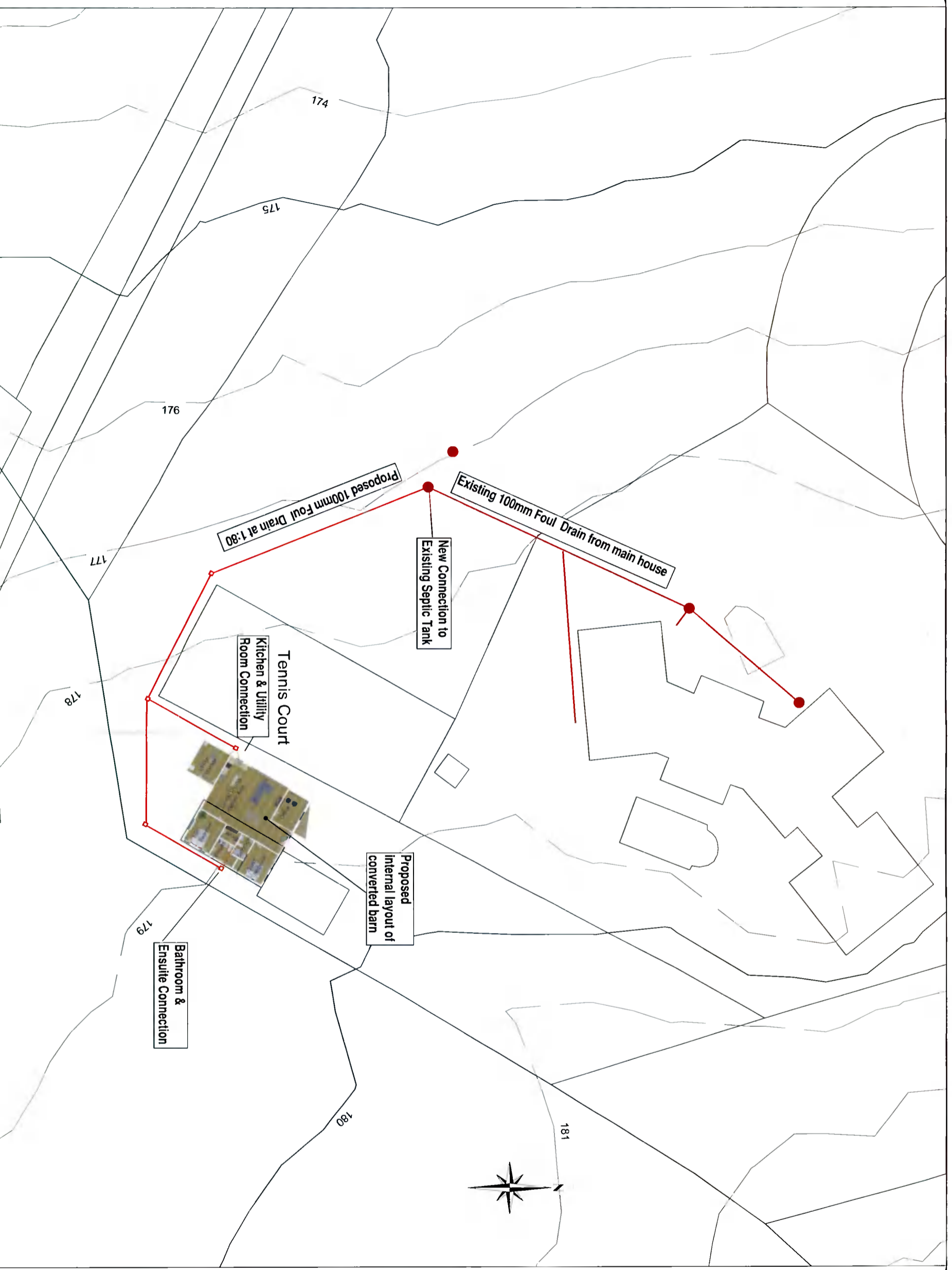

Extracts from the following Digital OS1 Maps reproduced under licence:
3450-B (1:2,500 Series)
OS / Ordnance Survey Ireland License No. CML4527/0656
© Ordnance Survey Ireland / Government of Ireland