

Existing main house on site, Mattie, Windmillhill

Pool and glass enclosure to rear of the main house.

Adjacent corrugated barn structure to be retained. No development proposed.

Horse stables to be developed into annex dwelling.

Tennis court

Private road serving neighbouring property

Neighbouring building

SITE BOUNDARY

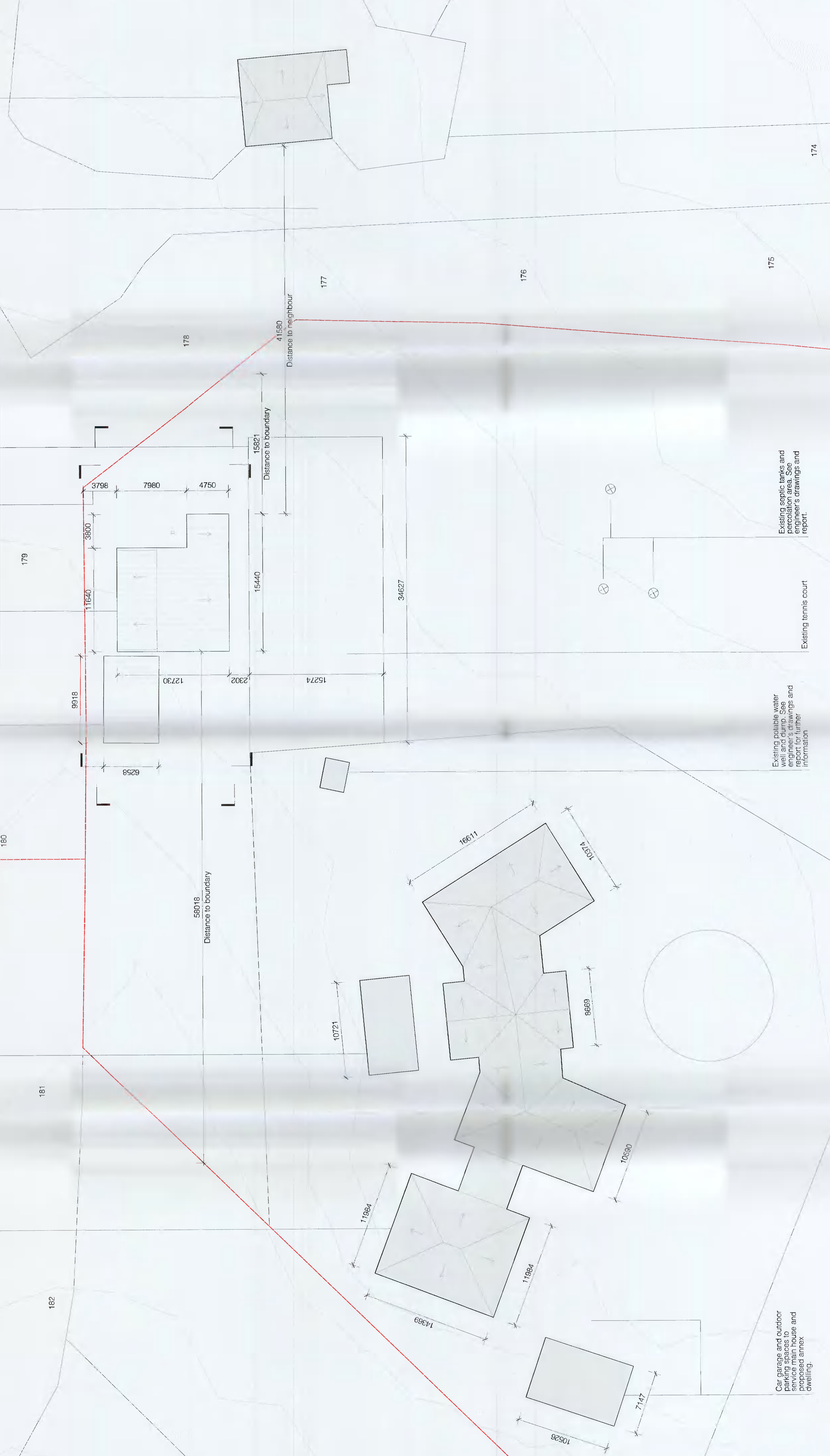

183

182

181

180

179

178

177

176

175

174

9918

6258

3800

11640

12730

3798

7980

4750

2302

15440

15821

41580

58018

Distance to boundary

Distance to neighbour

Distance to boundary

10721

11984

14369

1691

10526

7147

8669

10374

10390

15440

15821

Distance to boundary

Distance to neighbour

Distance to boundary

Distance to neighbour

Distance to boundary

Distance to neighbour

Distance to boundary

Car garage and outdoor parking spaces to service main house and proposed annex dwelling.

Existing potable water well and pump. See engineer's drawings and refer further information

Existing tennis court
Existing septic tanks and percolation area. See engineer's drawings and report.

SHEET TITLE: **PLANNING DRAWING: SITE PLAN**
 SCALE: 1:200
 DRAWN BY: NICOLAS HOWDEN
 SHEET NUMBER: 01-02

PROJECT TITLE AND ADDRESS: **STABLE HOUSE MATTIE, WINDMILLHILL, RATHCOOLE, COUNTY DUBLIN**
 DATE: 26.01.2022
 SHEET SIZE: A1

NOTES:
 PRINCIPAL DIMENSIONS ARE IN MILLIMETERS.
 THIS DRAWING TO BE READ IN CONJUNCTION WITH ALL OTHER ARCHITECTURAL & ENGINEERING DRAWINGS.
 CONTOURS ARE DERIVED FROM OSI LIDAR DATA

