

**PROPOSED TWO STOREY THREE BEDROOM HOUSE TO SIDE OF 54A KNOCKLYON GREEN, KNOCKLYON, DUBLIN 16 FOR MR. JOHN FAIR.**



Scale: 1 : 100

**FRONT ELEVATION**

**Roof**  
Coloured concrete roof tiles laid to manufacturers instructions on 35mm x 50mm battens on sarking felt on prefabricated roof trusses at 600mm centres to I.S. 193, 1985, complete with bracing, water storage tank supports and holding down clips, all to manufacturers instructions

**Note**  
All structural timbers to comply with SR11, structural timber for domestic construction. Timber to be kiln dried and supplied at a moisture content not exceeding 22%

**Ventilation:**  
Room vents - 6500sq.mm  
Roof - 25mm continuous strip or equal  
Window opens Kitchen 1/10 of floor area, other rooms 1/20 of floor area.

**Insulation:**  
Maximum Elemental U.I. Values.  
Exposed Roofs - 0.25 W/M2 K.  
Exposed Walls - 0.45 W/M2 K.  
Exposed Floors - 0.45 W/M2 K.

Glazing - Double glazing throughout.

Smoke Detector to be fixed to ceiling at bottom of stairs to B.S. 5588 Part 1 1990.

**Concrete Mixes:**  
Lean Mix 7.5 N/mm2.  
Pipe Bedding 10.0 N/mm2.  
Blinding 10.0 N/mm2.  
Strip Foundation 15.0 N/mm2.  
Ground Floor 20.0 N/mm2.  
Paths 25.0 N/mm2.

**Lintols:**  
Precast concrete composite lintol and pressed metal lintols incorporating insulation, 225mm bearing each end.



**REAR ELEVATION**

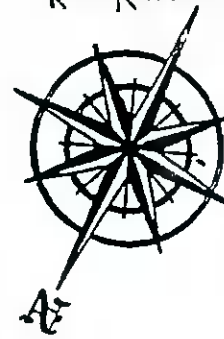

**DRAINAGE LEGEND**  
Foul Sewer Drain  
Surface Water Drain  
Gully Trap  
Gully Trap R. W.P.  
Armstrong Junctions  
Manhole

Smoke Detector to be fixed to ceiling at bottom of stairs to B.S. 5588 Part 1 1990.

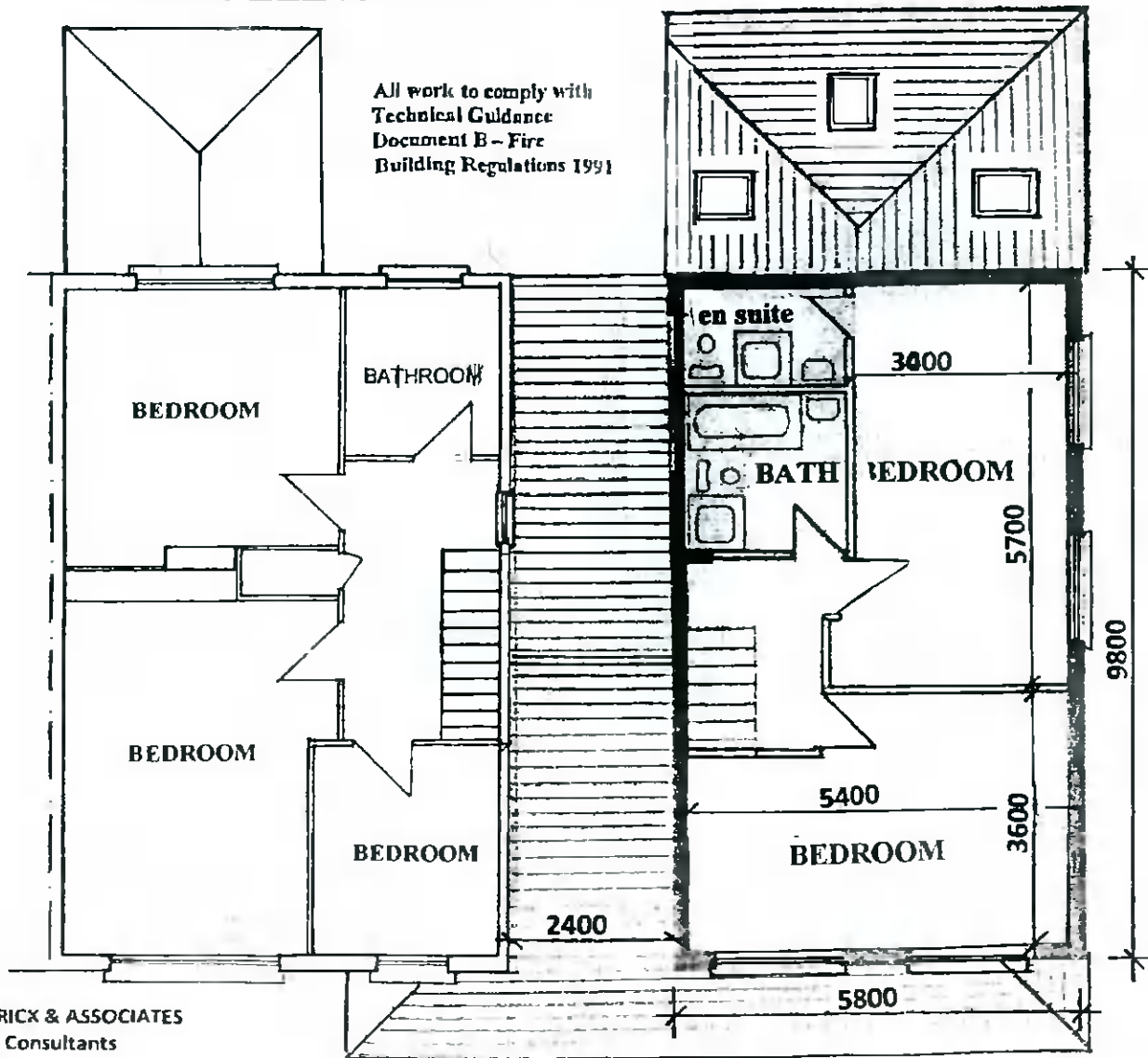

**EXISTING FIRST FLOOR PLAN**

**PROPOSED FIRST FLOOR PLAN**

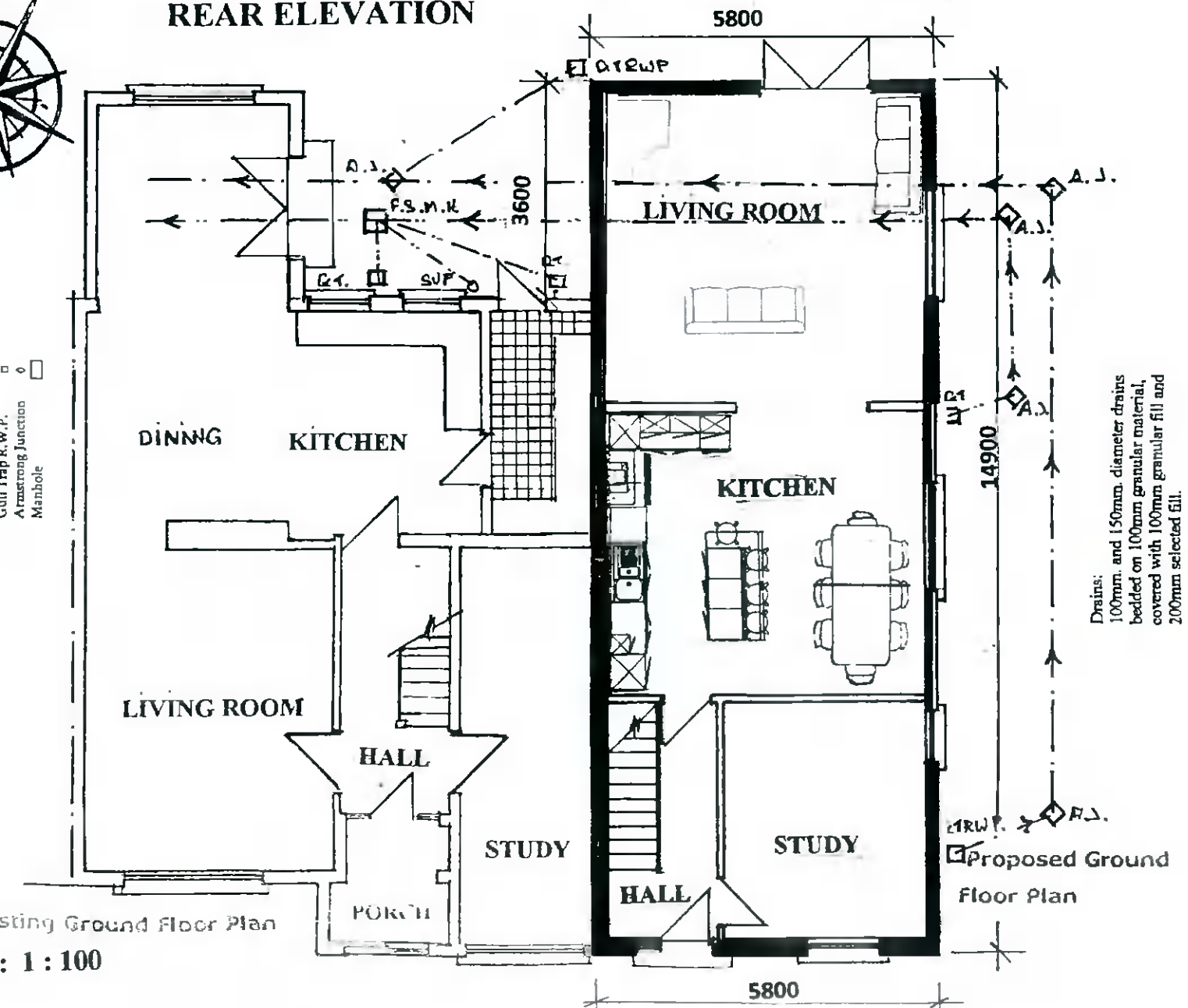

Scale: 1 : 100

Existing Ground Floor Plan

Floor Plan