

ARCHITECT

JENNINGS DESIGNSTUDIO

LEGEND

TREE PROTECTION

 TREES TO BE RETAINED

 TREE PROTECTION FENCING

 EXISTING SITE BOUNDARY

 LAND OWNERSHIP BOUNDARY

 WORKS SUBJECT TO THIS PLANNING APPLICATION

Note

Tree protection fencing is recommended to protect overhanging canopies from construction activity. These should be removed and replaced when works commence are required within these immediate areas.

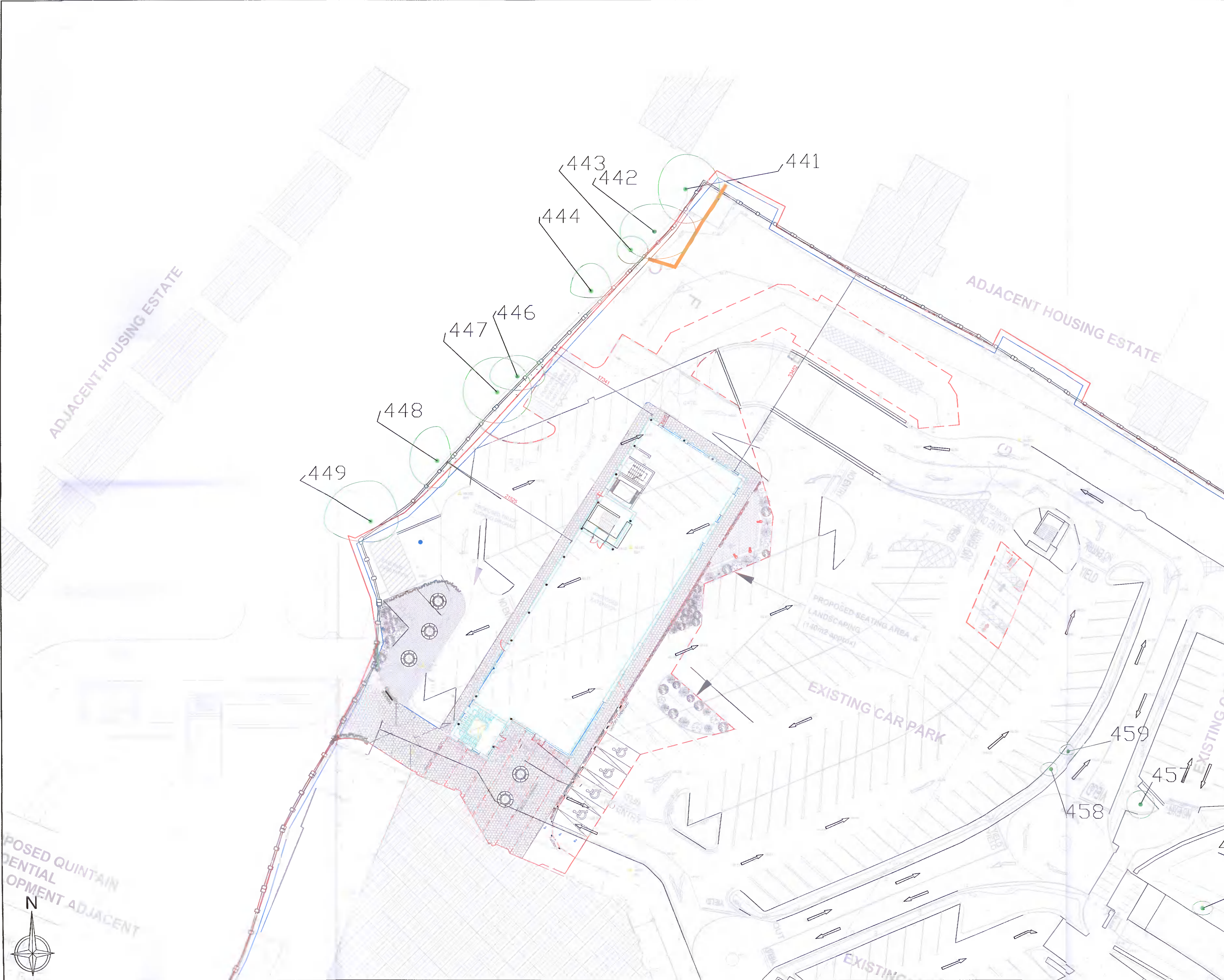

REVISIONS

REV	DATE	DESCRIPTION

PROJECT: LUCAN SHOPPING CENTRE	JOB NO. TLUC001
-----------------------------------	--------------------

DRAWING Tree protection (1of1)	DATE 17-12-21	SCALE 1:250 @ A1
-----------------------------------	------------------	---------------------

DRAWN BY: NIAL MCBRIDE	NMB INITIALS
------------------------	-----------------

STATUS: PLANNING	
------------------	--

DRAWING NO. 110	REVISION.
-----------------	---------------

NOTES
 Do Not Scale: Use Figure Dimensions Only.
 Not for Construction: Purpose unless Specifically Marked.
 © THIS DRAWING IS COPYRIGHT OF CMK HORTICULTURE + ARBORICULTURE LTD

