



 Pink bubble supercedes planning amendment application and relates to RFI Reg.Ref: SDZ21A/0020

-  PRIMARY DESIRE LINE BETWEEN BLOCK F CARPARK & BLOCK G
-  PEDESTRIAN ROUTE ACCESS FROM BLOCK G1 & G2 CORES VIA COURTYARD
-  PRIMARY PEDESTRIAN ROUTE ACCESS FROM COURTYARD SIDE OWN DOOR UNITS

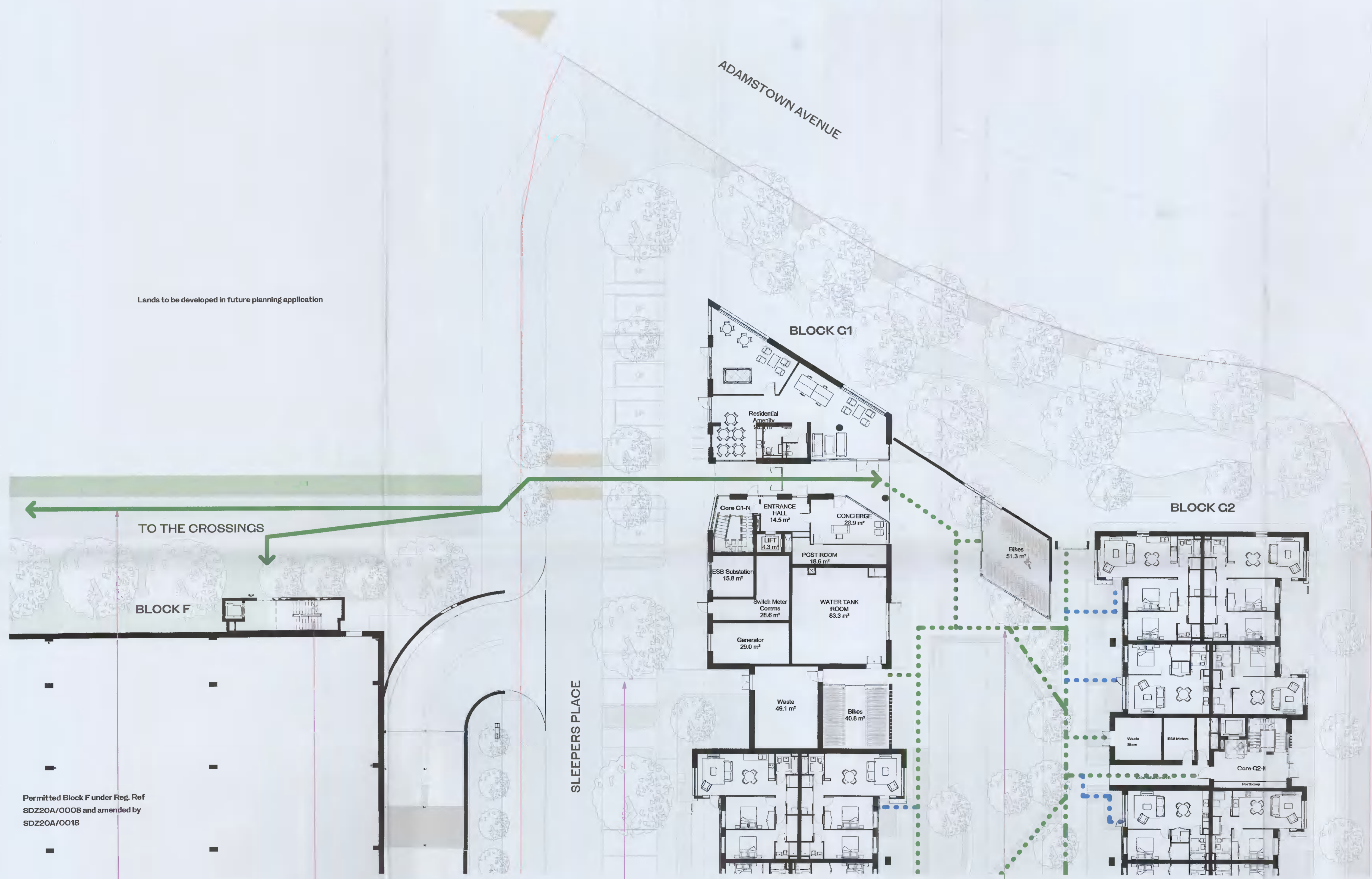

Lands to be developed in future planning application

TO THE CROSSINGS

Permitted Block F under Reg. Ref SDZ20A/0008 and amended by SDZ20A/0018

RFI no. 3. (1)
 TRUE DESIRE LINE FROM BLOCK G TO THE CROSSINGS

RFI no. 3. (1)
 DEDICATED SECURE PEDESTRIAN LIFT TO RESIDENTIAL CARPARKING SPACES IN BLOCK F

RFI no. 3. (1)
 ON STREET CAR PARKING PROVIDED FOR STREET FRONTING OWN DOOR UNITS

RFI no. 3. (1)
 PRIMARY DESIRE LINE IS ACCESSIBLE FROM VARIOUS LOCATIONS WITHIN G1 & G2 VIA COMMUNAL COURTYARD (CORES G1-S, G1-N, G2-S, G2-N AND COURTYARD SIDE OWN DOOR UNITS)

REV	DATE	DESCRIPTION	CHK	DRN
P04	01/02/2022	ISSUED FOR FURTHER INFORMATION	RJ	HJL
P03				
P02				
P01				

STATUS CODE DESCRIPTION
ISSUED FOR FURTHER INFORMATION

CLIENT
 QUINTAIN IRELAND LTD.

PROJECT
 ADAMSTOWN STATION BLOCK G

DRAWING
 EAST-WEST PEDESTRIAN ACCESS DESIRE LINES

PROJECT NUMBER 550749	DATE 01/02/22
SCALE@ A1: As indicated	DRAWN/CHECKED: SEN/RJ

STATUS CODE: A1	DRAWING NUMBER: ADC-HJL-G-00-DR-A-6602	REVISION: P04
--------------------	-------------------------------------------	------------------

Henry J Lyons