



# Dublin Baile Átha Cliath

SITE AREA - 0.0459 Hectares

— SITE OUTLINED RED

SITE COVERAGE : 54%

PLOT RATIO: 2.2

GROSS FLOOR AREA : 1016SQM

PARKING SPACES PROVIDED: 6 SPACES

ROOF GARDEN AREA: 46.6SQM

**ACCOMMODATION SCHEDULE**

STUDIO APARTMENT	-1 NO.
1 BED APARTMENT	-4 NO.
2 BED APARTMENT	-5 NO.
<b>TOTAL NO. OF APARTMENTS -</b>	<b>10 NO.</b>

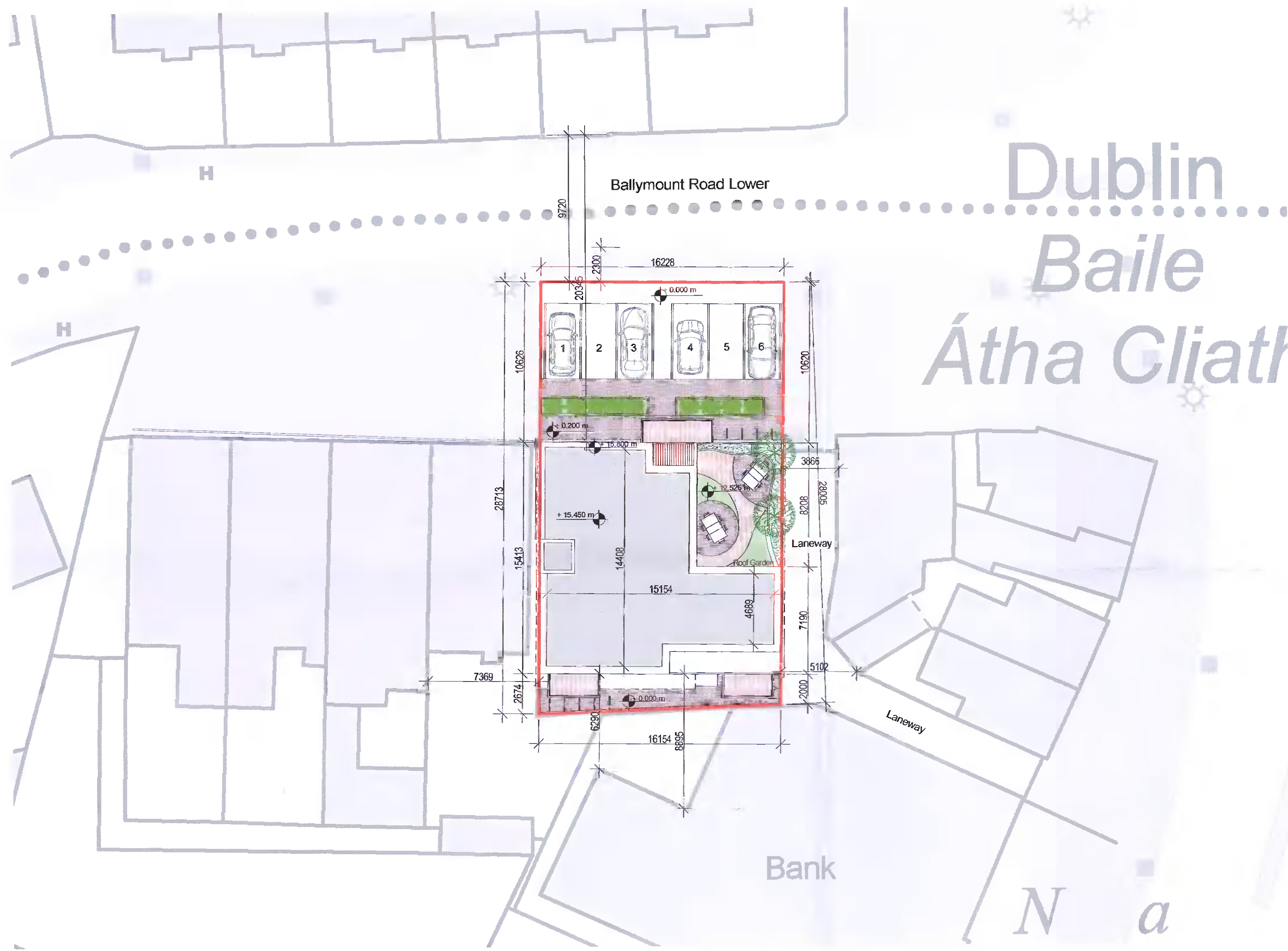

**1** PROPOSED SITE PLAN  
SCALE 1 : 200

NOTES:  
© This drawing is copyright. Figured dimensions only to be taken from this drawing. All dimensions to be checked on site. Module Design Ltd to be informed of any discrepancies before work proceeds.

REV	DATE	DESCRIPTION	ISSUED
A	2021.12.10	Issued for Planning	Zubi Efobi

CLIENT NAME: ALAN & MONICA HOLMES	
DRAWN: ZUBI EFOBI	CHECKED:
DATE: January 2022	PAGE SIZE A2

PROJECT NAME PROPOSED MIXED USE DEV. AT PAINTWORLD, 1-2 BALLYMOUNT ROAD LOWER, DUBLIN 12			
DRAWING TITLE PROPOSED SITE PLAN			
PROJECT NO. 21127	DRAWING NO. P002	SCALE 1 : 200	REV A

**MODULE**  
ARCHITECTURE | DESIGN | PROJECT MANAGEMENT  
1st Floor, 2 Chapel Hill, Lucan, Co. Dublin  
t: +353 1 532 5078 e: hello@module.ie w: www.module.ie

STATUS  
**PLANNING**