

ROBINHOOD
INDUSTRIAL
ESTATE

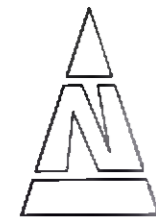

UNIT 42

UNIT 41
NO CHANGE TO THE EXISTING LAYOUT
FLOOR AREA 1750 M2

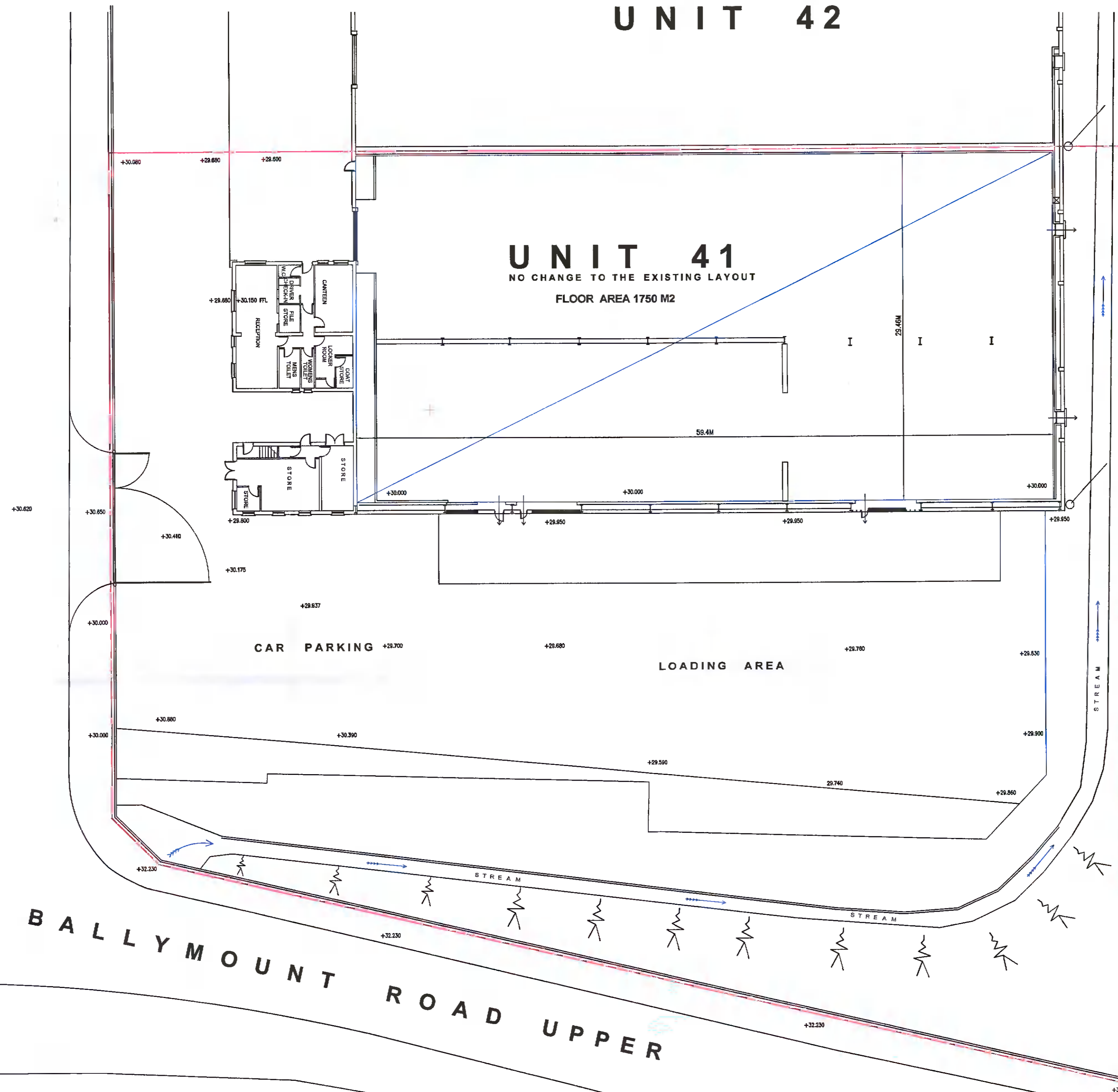

SITE LAYOUT PLAN SCALE 1:250
SITE AREA ENCLOSED IN RED 0.605 ha.
MAP ENLARGED FROM MAP SHEET 3327-08
NO CHANGE TO THE EXISTING LAYOUT

*** DO NOT SCALE USE FIGURED DIMENSIONS ONLY ***

REV:	BY:	AMENDMENTS:	DATE:
------	-----	-------------	-------

DRAWN BY:	JL	TECH. CHECK:	..
-----------	----	--------------	----

SCALE:	1:250	SIZE:	A1	ENG. CHECK:	
--------	-------	-------	----	-------------	--

DATE:	DEC 21	APPROVED:	
-------	--------	-----------	--

DRAWING STATUS:
FOR PLANNING

CLIENT:
PARMA MOTORS LTD

JOB TITLE:
CHANGE OF USE APPLICATION
FROM COLD STORAGE USE TO
LIGHT INDUSTRIAL USE

DRAWING TITLE:
1 : 250 SITE MAP

Planning Department
3 - FEB 2022
Received



Fitzsimons Doyle & Associates
250 Harold's Cross Road, Dublin 6w
Tel: +353 (0) 4966011 Fax: +353 (0) 4967018
Web: www.fdoconsulting.ie Email: admin@fdoconsulting.ie



JOB No:	DRAWING No:	REV:
21-5102	101	A