

Concrete Mixes:
 Lean Mix 7.5 N/mm².
 Pipe Bedding 10.0 N/mm².
 Blinding 10.0 N/mm².
 Strip Foundation 15.0 N/mm².
 Ground Floor 20.0 N/mm².
 Paths 25.0 N/mm².

Lintols:
 Precast concrete composite lintol and pressed metal lintols incorporating insulation, 225mm bearing each end



CONTIGUOUS ELEVATION

Note:
 All structural timbers to comply with SR11, structural timber for domestic construction. Timber to be kiln dried and supplied at a moisture content not exceeding 22%.

Roof
 Coloured concrete roof tiles laid to manufacturers instructions on 35mm x 50mm battens on sarking felt on prefabricated roof trusses at 600mm centres to I.S. 193: 1986, complete with bracing, water storage tank supports and holding down clips, all to manufacturers instructions

Ventilation:
 Room vents - 6500sq.mm
 Roof - 25mm continuous strip or equal
 Window opens Kitchen 1/10 of floor area other rooms 1/20 of floor area

Insulation:
 Maximum Elemental U! Values
 Exposed Roofs - 0.25 W/M² K
 Exposed Walls - 0.45 W/M² K
 Exposed Floors - 0.45 W/M² K

Glazing - Double glazing throughout.

Floor
 150mm thick power floated concrete slab on 50mm thick polystyrene insulation, 25mm at external edges on 1000 gauge Visqueen damp proof membrane on sand blinding on 150mm minimum well consolidated hard-core filling.

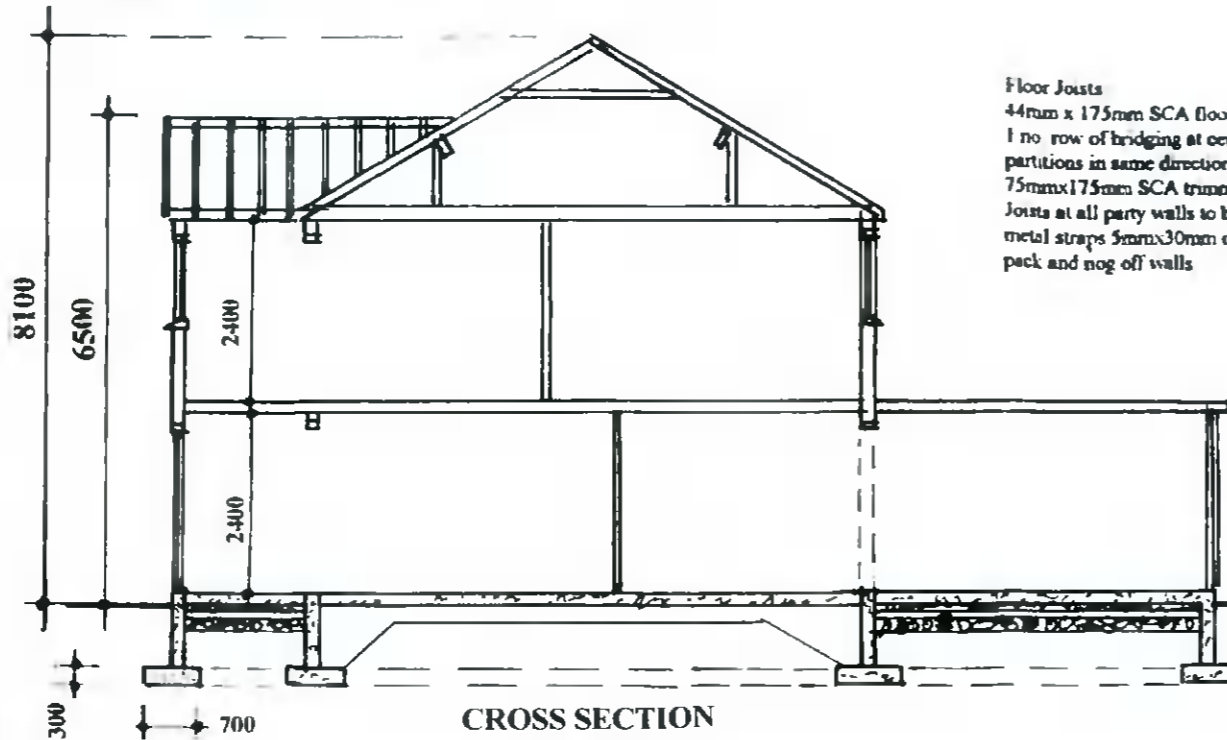

CROSS SECTION

Floor Joists
 44mm x 175mm SCA floor joists at 400mm centres with 1 no row of bridging at centre span Double row under stud partitions in same direction.
 75mm x 175mm SCA trimmers to firebreast and open Joists at all party walls to be hung on metal shoes Galvanised metal straps 5mm x 30mm over 3 joists at 2000mm centres pack and nog off walls

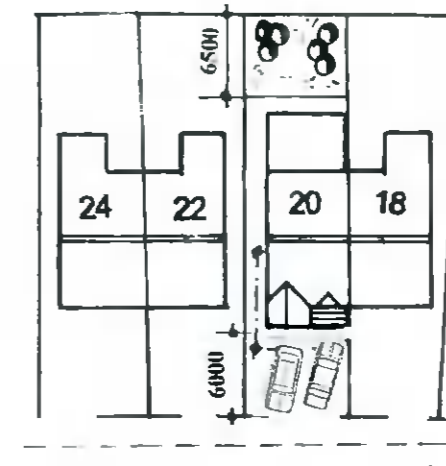

SITE PLAN

Scale : 1 : 500

DRAINAGE LEGEND

Foul Sewer Drain	---
Surface Water Drain	- - - -
Gully Trap	□
Gully Trap R.W.F.	○
Armstrong Junction	⊕
Manhole	□

Drawing Number : 614/PD/03
 Scale : 1 : 100

PROPOSED SINGLE AND TWO STOREY EXTENSION TO FRONT OF
 20 CORBALLY RISE, CITYWEST, CO. DUBLIN FOR MR. OWEN LAWLOR.

WATSON FITZPATRICK & ASSOCIATES
 Planning & Design Consultants
 98 Woodlawn Park Grove
 Firhouse, Dublin 24.

Revisions: