

GENERAL NOTES:
 DRAWINGS AND SPECIFICATIONS: THIS DRAWING TO BE READ IN CONJUNCTION WITH ALL RELEVANT ARCHITECTS, ENGINEERS AND SPECIALIST DRAWINGS TOGETHER WITH THE SPECIFICATION
 NOMINAL COVER TO REINFORCEMENT TO BE AS FOLLOWS: SEE SECTIONS

- ABBREVIATIONS:-
- UB U-BAR
 - LB L-BAR
 - B1 BOTTOM OUTER LAYER
 - B2 BOTTOM SECOND LAYER
 - T1 TOP OUTER LAYER
 - T2 TOP SECOND LAYER
 - N1 NEAR FACE OUTER LAYER
 - N2 NEAR FACE SECOND LAYER
 - F1 FAR FACE OUTER LAYER
 - F2 FAR FACE SECOND LAYER
 - ALT ALTERNATELY PLACED
 - AS ALTERNATELY STAGGERED
 - EF EACH FACE
 - NF NEAR FACE
 - FF FAR FACE
 - LL LONG LEG
 - SL SHORT LEG
 - NS NEAR SIDE
 - FS FAR SIDE

C30/37 100% LAPPED
 SCHEDULE OF REINFORCEMENT LAPS (L.U.O.)

WALLS
H10 500mm MIN.
H12 600mm MIN.
H16 800mm MIN.
H20 1000mm MIN.
H25 1250mm MIN.
H32 1500mm MIN.

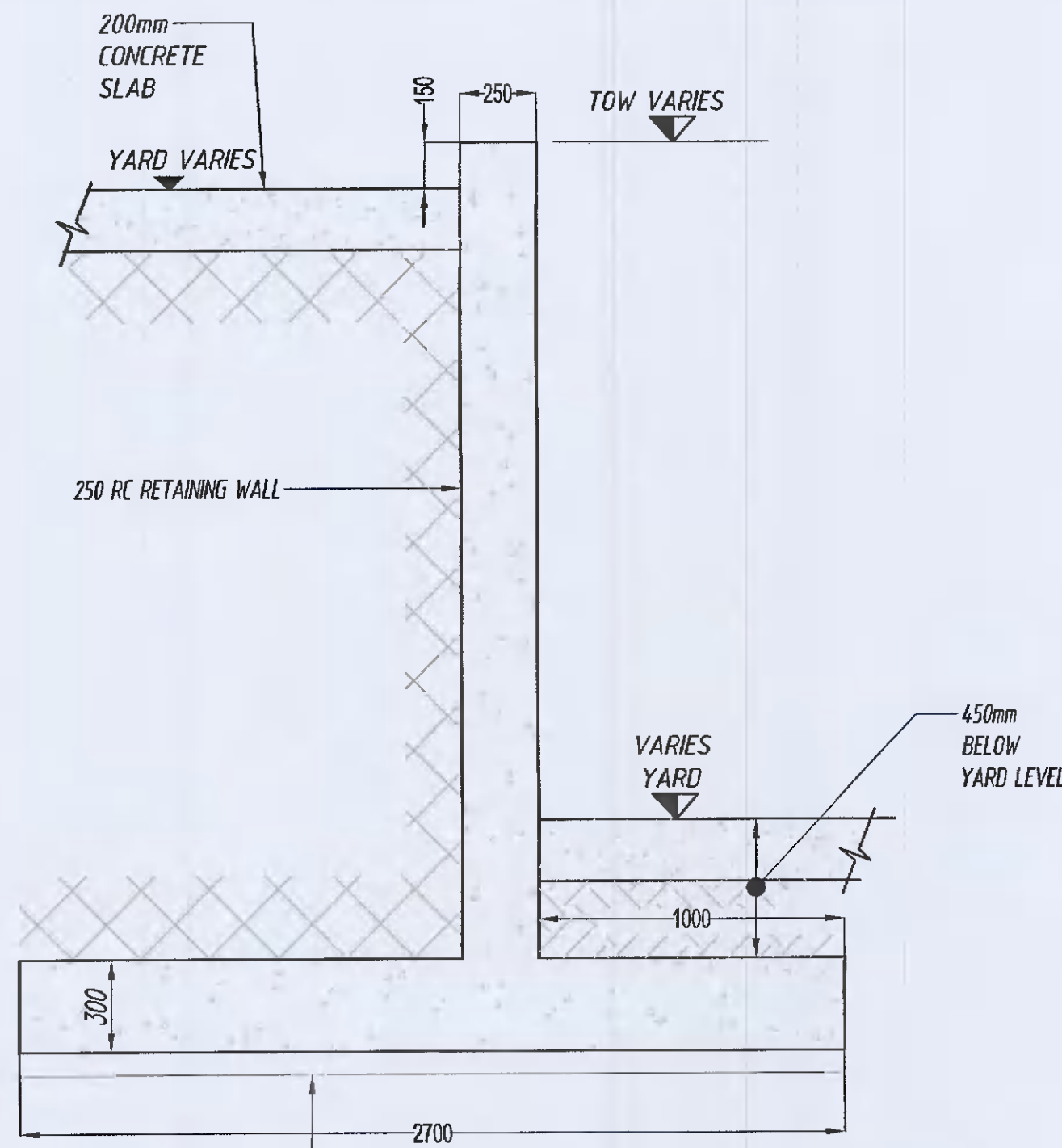

TYPICAL RETAINING WALL SECTION
 (1:20)

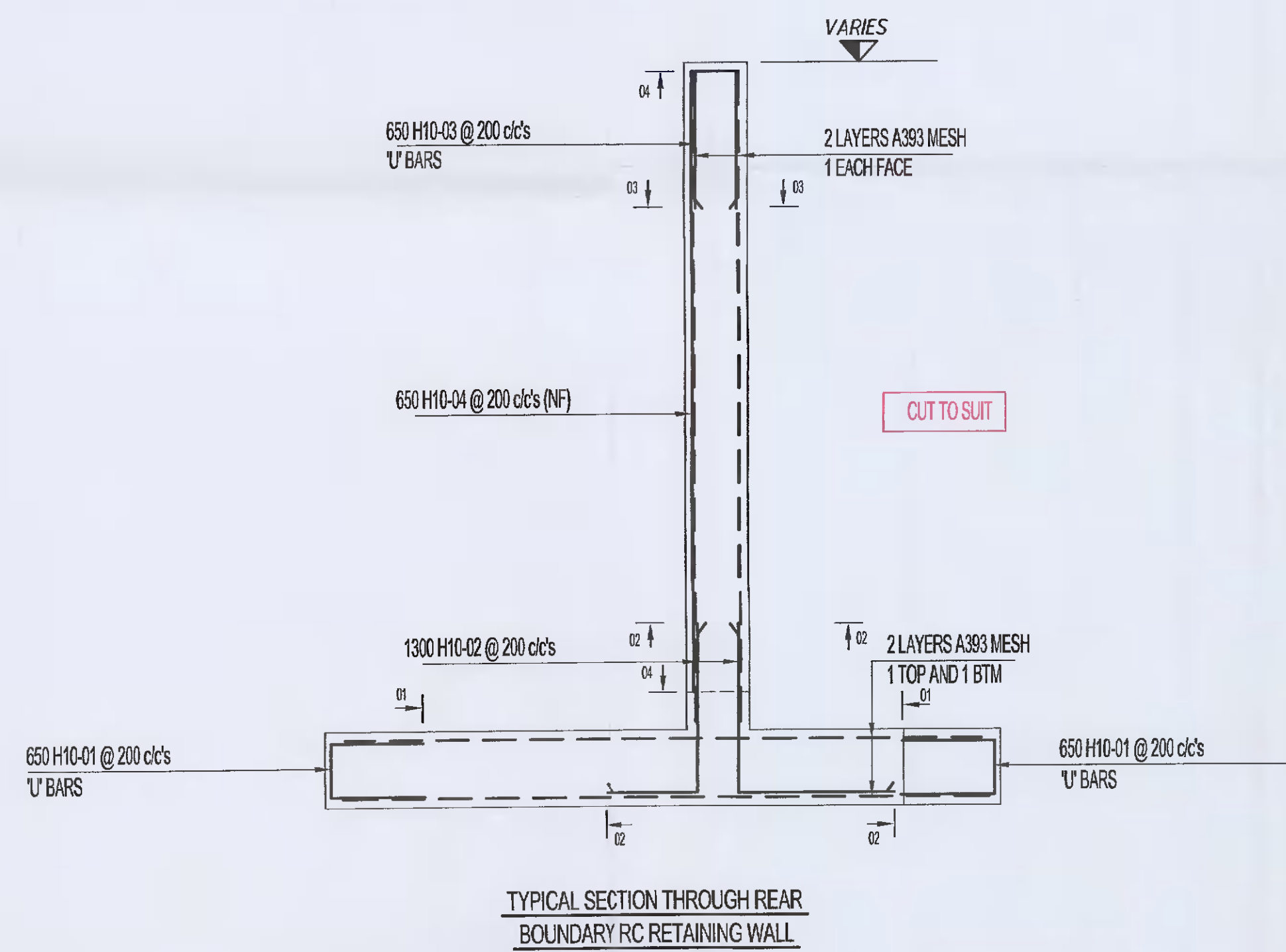

TYPICAL SECTION THROUGH REAR
 BOUNDARY RC RETAINING WALL

Location	BAR MARK	TYPE AND SIZE	NUMBER OF GROUPS	NUMBER IN EACH	TOTAL NUMBER	LENGTH	SHAPE CODE	All bending dimensions are in accordance with BS 8666:2005				D	ER	
								A	B	C	D	mm	mm	
RC RETAINING WALL	01	H10	1	1300	1300	1400	21	600	220	600	600			
	02	H10	1	1300	1300	1200	11	750	450					
	03	H10	1	650	650	1250	21	600	170	600				
	04	H10	1	650	650	1250	00	2400						
								A393 MESH = 150mm (approx)						



SITE LOCATION PLAN
 SCALE 1:250

PL1	2/24/2021	ED	-	-	ISSUED FOR PLANNING ALTERATIONS ADDITIONAL INFORMATION
Mark	Date	By	Chk.	App.	Revision

Job Title
**PROPOSED DEVELOPMENT AT
 KINGSWOOD BUSINESS PARK,
 BALDONNELL, DUBLIN 22**

Architect/Client
JMC VAN TRANS LTD

Drawing Title
RC RETAINING WALL

Drawing Status
PLANNING ALTERATIONS 2021 (A.I.)

Drawn: DG
 Checked: SB
 Approved: [Signature]
 Scales: AS SHOWN
 Date: September 2021

KAVANAGH BURKE
 CONSULTING ENGINEERS

Tel: 01-450 0694
 Fax: 01-426 4340
 Email: pkavanagh@kavanaghburke.ie

Unit C3, Calmount Plc.
 Ballymount, Dublin 12

Job No: D1568
 Drawing No: RC-010
 Rev: PL1