

TYPICAL SEMI-DETACHED HOUSE

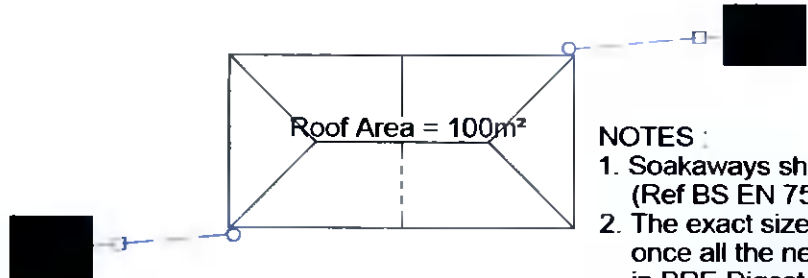

NOTES :

1. Soakaways should be sited at least 5m away from the building. (Ref BS EN 752)
  2. The exact size and shape of the soakaways are to be determined once all the necessary calculations have been produced as described in BRE Digest 365 - Soakaway Design
  3. Maximum installation depth as per manufacturer's guidelines
  4. Loading capacity 17.5 tonnes/m<sup>2</sup> vertically 4.0 tonnes/m<sup>2</sup> laterally
- = 250mmØ Silt Trap

GROUND LEVEL

0.5m MINIMUM COVER

BACKFILL SEE ROAD BUILD-UP

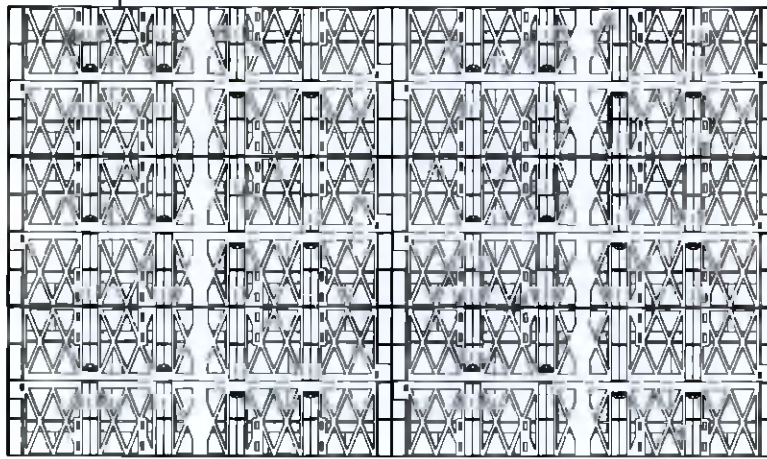

ROAD LEVEL

0.5m MINIMUM COVER

BACKFILL AS-DUG

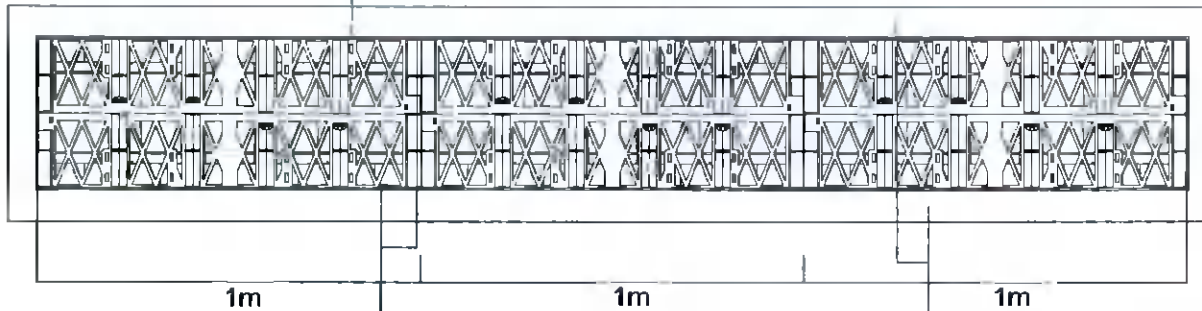

1m

1m

1m

PERMEABLE GEOTEXTILE

100mm COARSE SAND OR NON ANGULAR GRANULAR MATERIAL BASE AND SURROUND

NOTE:  
0.3m MINIMUM COVER, BUT 0.5M COVER IS RECOMMENDED TO PREVENT ACCIDENTAL DAMAGE.

Notes:

1. All dimensions to be checked on site. Engineer to be informed immediately of any discrepancies before work proceeds.
2. All blockwork to be dense solid blockwork with a minimum compressive strength of 5N/mm<sup>2</sup> u.n.o. and shall comply with the requirements of BS 325.
3. All foundations to be placed on minimum 50mm lean mix blinding (U.N.O.)
4. For details of underground drainage services refer to architects' and engineers drawings. For exact location of services, service openings, external ducting and lighting refer to architects engineers drawings.
5. All temporary works necessary shall be the sole responsibility of the contractor.
6. All steel to be CE certified
7. This drawing to be read in conjunction with all relevant architects and engineers drawings.
8. All concrete to be grade 35N/20 with a crushing strength of 35N/mm<sup>2</sup> after 28 days.
9. Reinforcement to have a minimum of 40mm clear cover of concrete unless otherwise noted.
10. Do not scale drawing.
11. All dimensions in millimeters unless otherwise stated.
12. Foundations to be formed on suitable bearing strata with capacity of 100 kn/sq.m.
13. Engineers office to be notified 24 hours before concrete pour.
14. Foundation design subject to no presence of water. Engineers office to be notified if soil conditions differ.
15. All dimensions and setting out to be confirmed and checked with architects drawings. Any discrepancies to be disclosed to architects and engineers office.
16. All building works to comply with current building control and regulations (BCaR).

Rev	Description	Date
01	Planning	11.20

Stability Status  
**P1 - Suitable for Planning**

Client  
Richard & Eliana Quinn

Job Title  
Proposed Dwelling at Kilakee Green, Firhouse, D.24

Drawing Title  
Typical Soakaway Detail

Originator	Drawn by	Checked by	Scale	Date	Sheet
SCS	BK	N.T.S.		24/11/20	A3

Dwg No  
20A224-SHD-XX-XX-DR-C-0004

**Structural Home Design  
Consultant Engineers**

Nutgrove Enterprise Park, Rathfarnham, Dublin 14  
Tel: 01-6852266  
email: info@SHDeng.ie www.SHDeng.ie

