

Land Registry Compliant Map

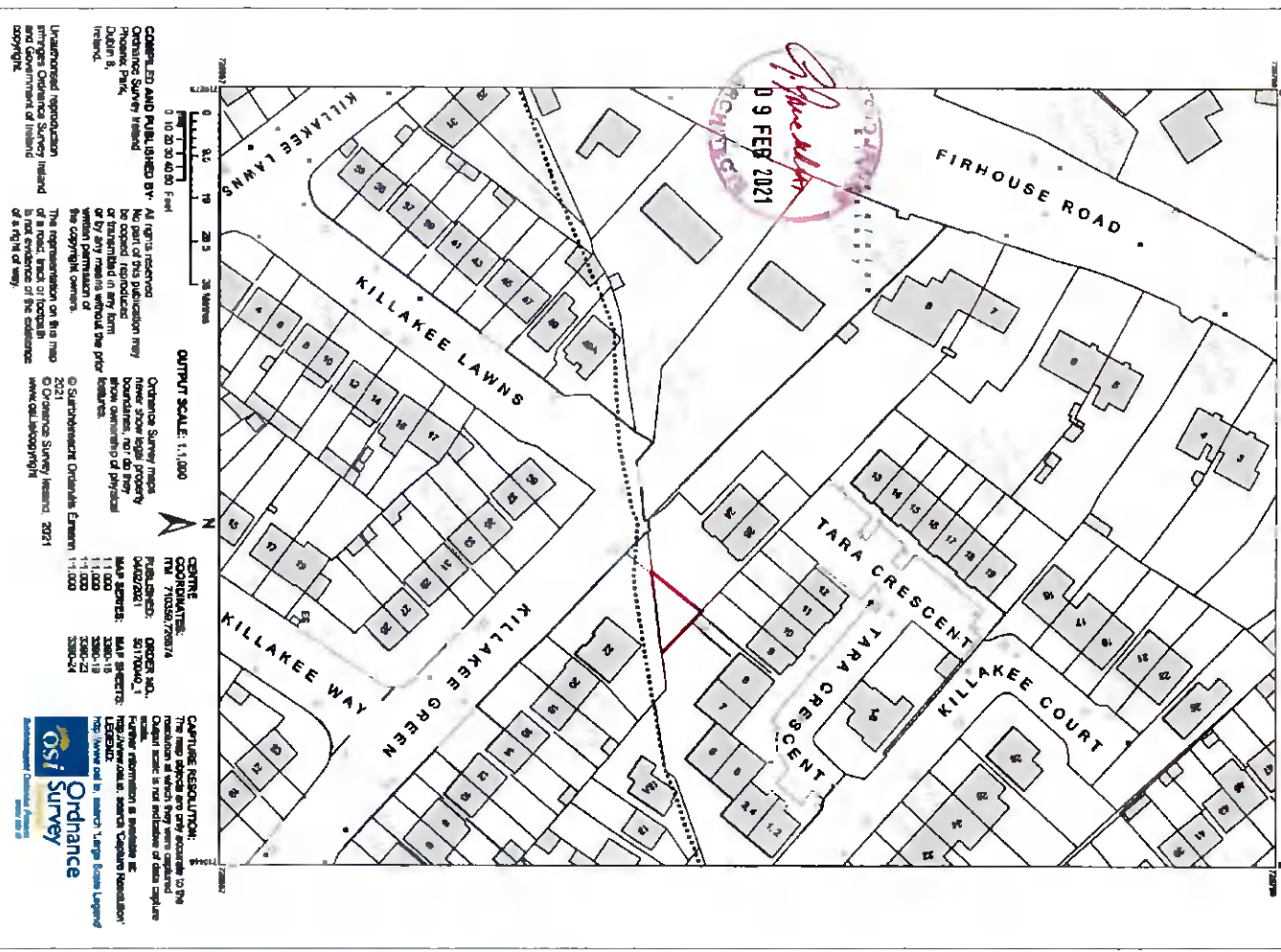

DETAILS ABOVE ILLUSTRATE LAND TRANSFER FROM

24-26 KILLAKEE GREEN TO

RED OUTLINE NOW UNDER OWNERSHIP OF MR. EDWARD QUINN

INFORMATION ABOVE SUPPLIED AS PART OF FURTHER INFORMATION REQUEST UNDER PLANNING APPLICATION SD21A0249

Land Registry Compliant Map

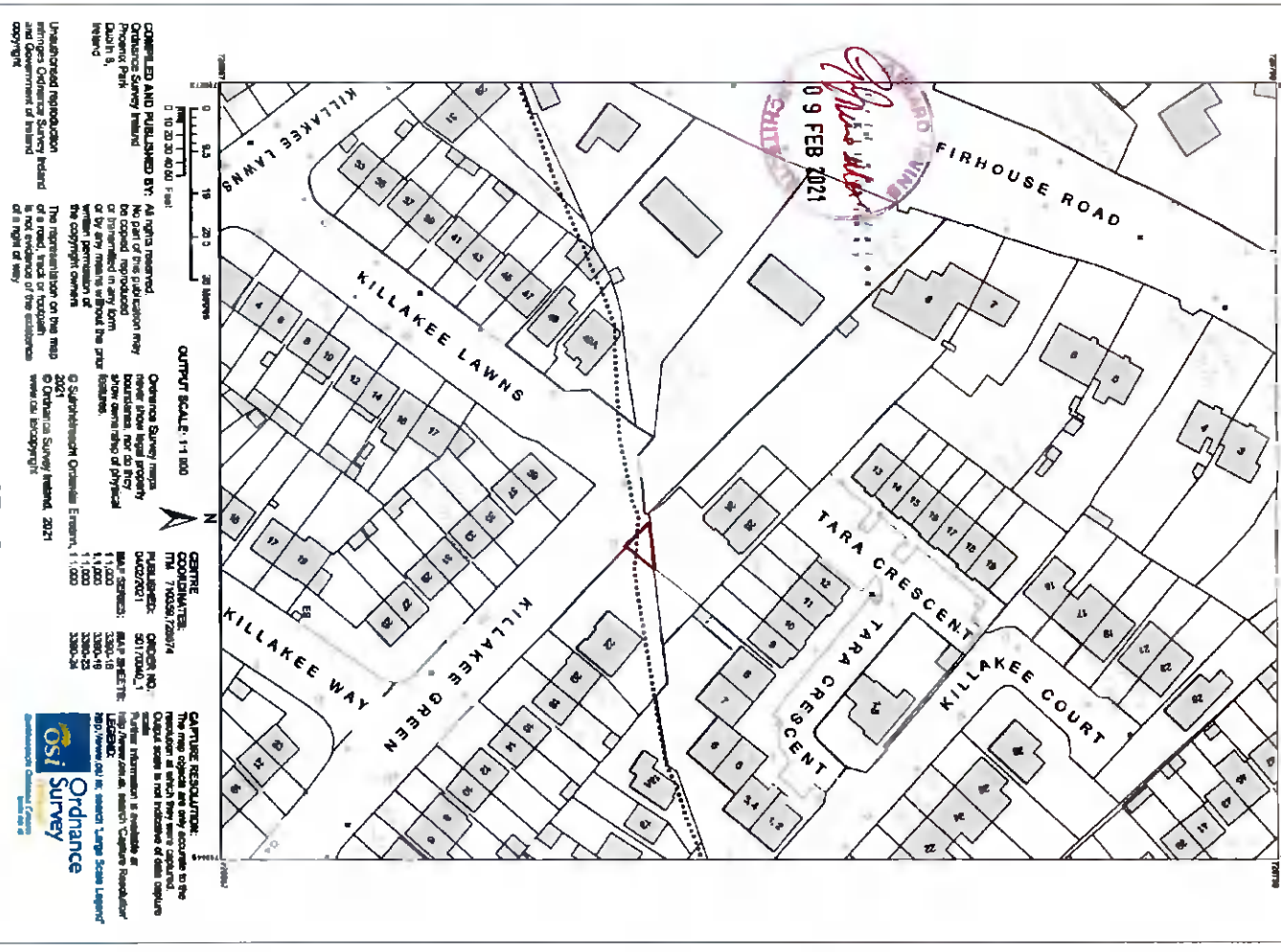

DETAILS ABOVE ILLUSTRATE LAND TRANSFER FROM

22 KILLAKEE GREEN TO

RED OUTLINE NOW UNDER OWNERSHIP OF OWNER OF 22 KILLAKEE GREEN

Land Registry Compliant Map

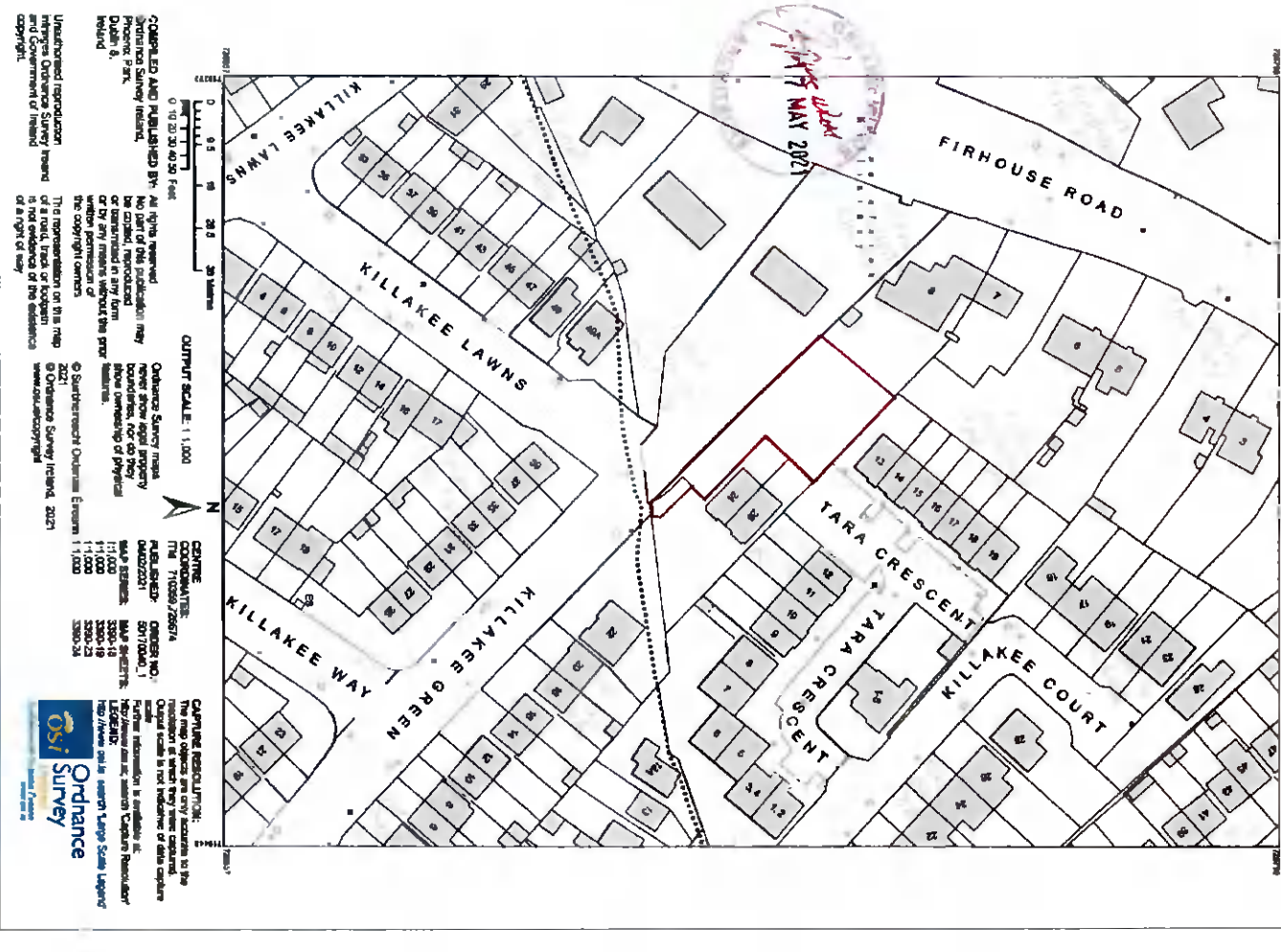

DETAILS ABOVE ILLUSTRATE LAND TRANSFER FROM

8 FIRHOUSE ROAD TO PROPOSED SITE LOCATION OF THIS PLANNING APPLICATION (SD21A0249)

RED OUTLINE NOW UNDER OWNERSHIP OF MR. RICHARD QUINN

Rev	Date	Note	By
PLANNING			

<p>DO NOT SCALE FROM DRAWING</p> <p>All dimensions to be checked on site prior to the start of any work, and any discrepancies notified in writing.</p> <p>Refer to Engineers' drawings for all structural, heating, lighting, power, drainage and ventilation information.</p> <p>All building works to comply in all respects to current Building Standards for country in which site is located.</p> <p>All electrical work to be carried out in accordance with the latest edition of the Institute of Electrical Engineers Regulations and to the approval of the Local Authority.</p> <p>All drainage work to be carried out in consultation with the Local Authority Inspectors and to be tested to the satisfaction of the Local Authority.</p>	
<p>Site Ownership Details</p> <p>Richard & Eiliana Quinn, Proposed Dwelling at Killakee Green, D.24</p>	
Drawn By	lan Carbery Architectural Consultancy Services 15 Wexley Gardens Gallop Gal 204 01 282 04725 gal@archgal.com
Scale	As Shown
Part	A3
Project	IG
Drawn To	PL21
Project No	19101