

GENERAL NOTES:
 ** Do not scale from this drawing
 ** Use figured dimensions only
 © This drawing is copyright. No part of this document may be re-produced or transmitted in any form or stored in any retrieval system from the copyright holder, except as agreed for use on a project, for which the document was originally issued.

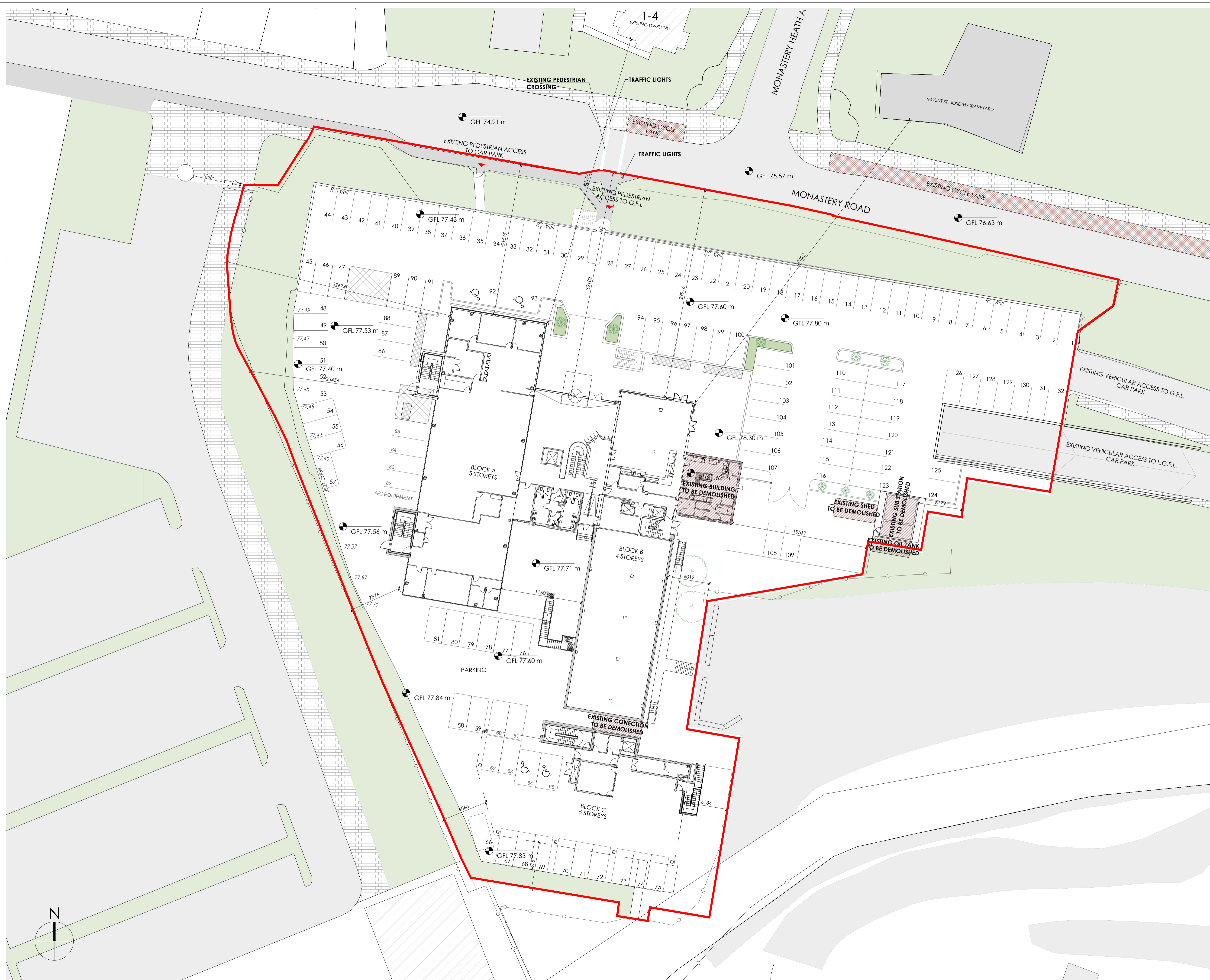

- SITE OUTLINE RED (0.81 HECTARES)
- DEMOLITION/REMOVAL WORKS

LEGEND

| TOTAL AREA TO BE DEMOLISHED | 153.5 SQM |
|---|-----------|
| • Existing Bulding to be demolished | 73.2 sqm |
| • Existing Shed to be demolished | 15.7 sqm |
| • Existing Sub Station to be demolished | 29.5 sqm |
| • Existing Oil Tank to be demolished | 12.1 sqm |
| • Existing Conection to be demolished | 23 sqm |

STAGE 03

ha
 DESIGN STUDIO
 36 Mount Street Upper, Dublin D02 Y982
 +353 1 524 0709 www.hads.ie

CLIENT
 RANDELSWOOD HOLDINGS LTD.
 PROJECT
 PROPOSED SHD DEVELOPMENT AT DOLCAIN HOUSE, MONASTERY RD., CLONDALKIN, DUBLIN 22

DWG. TITLE
 EXISTING/DEMOLITION/REMOVAL WORKS
 SITE LAYOUT PLAN
 SCALE @ A1: 1:250
 DRAWN BY: FL
 CHECKED BY: JH
 PAPER SIZE: A1
 JOB NO.: 18-001
 DATE: 21.01.2022

DWG NO. **PL-002**

EXISTING/DEMOLITION/REMOVAL WORKS SITE LAYOUT PLAN
 1:250