

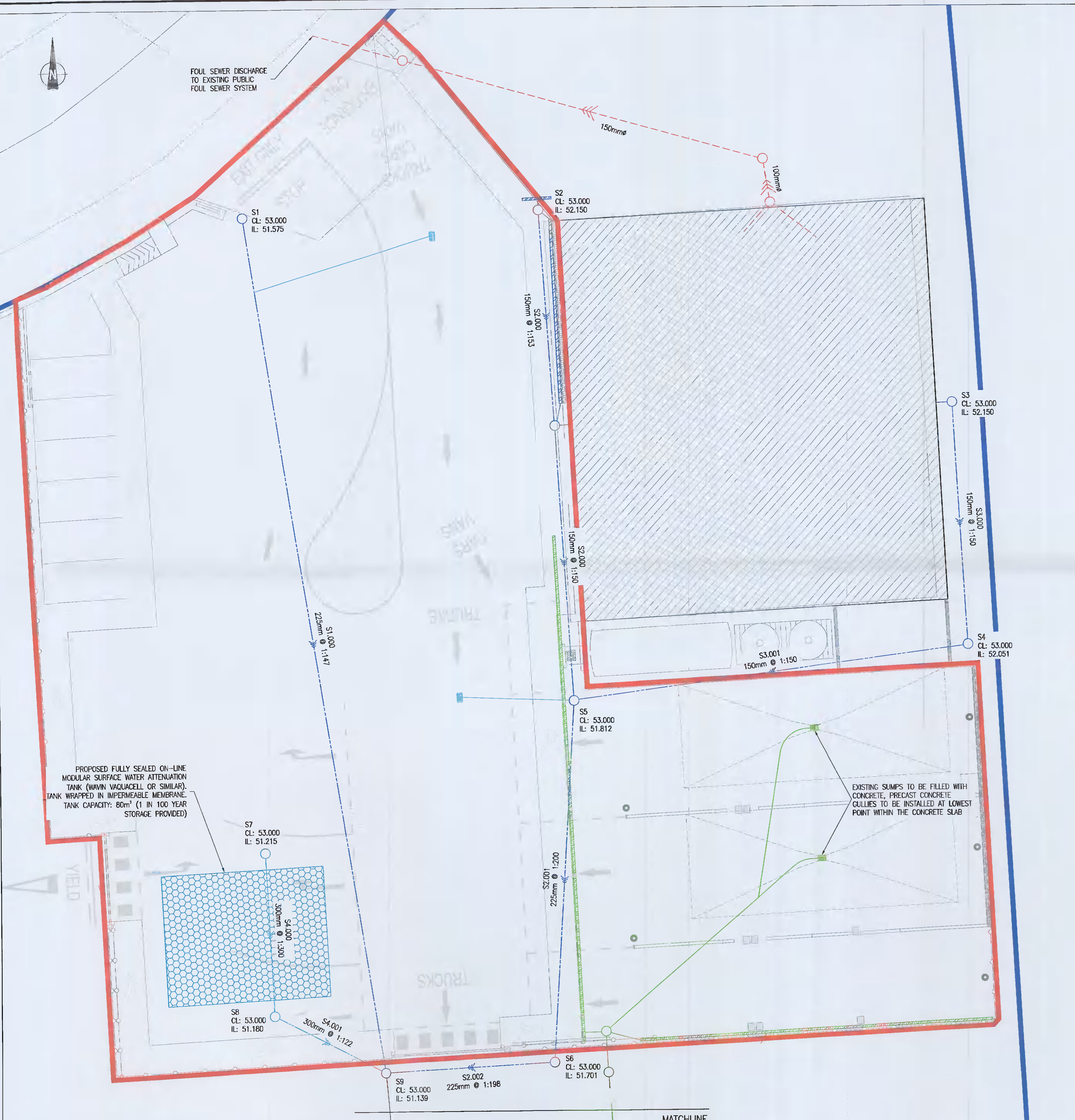

FOUL SEWER DISCHARGE TO EXISTING PUBLIC FOUL SEWER SYSTEM

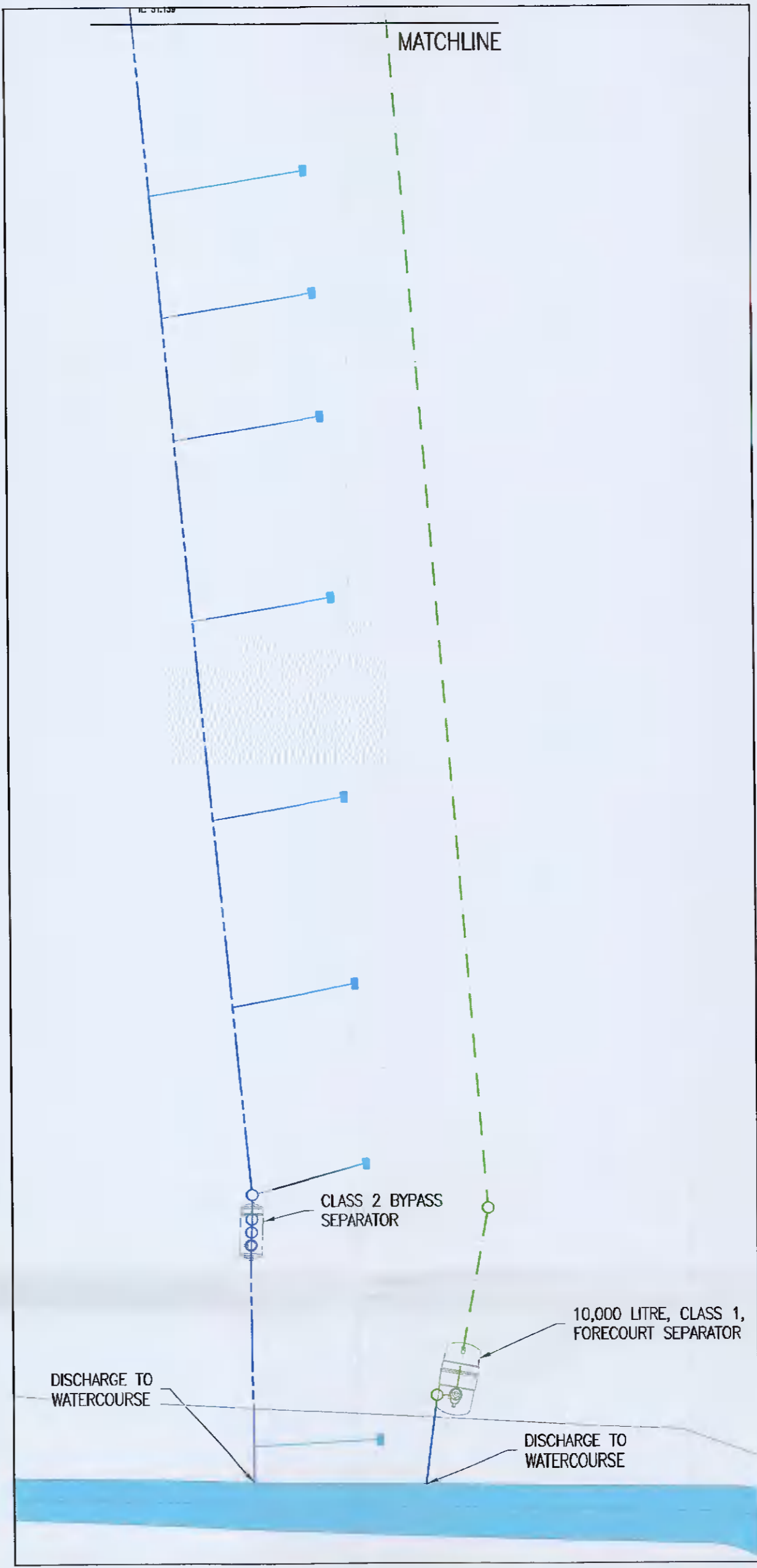

**DRAINAGE LAYOUT**  
SCALE 1:125



**INTERCEPTOR AND DISCHARGE TO WATERCOURSE**  
SCALE 1:250



**KEY PLAN**  
SCALE 1:1000

NOTES:  
THIS DRAWING IN WHOLE OR IN PART SHALL NOT BE COPIED WITHOUT THE PRIOR PERMISSION OF McARDLE DOYLE LTD.  
ALL WORKS TO COMPLY WITH THE CURRENT BUILDING REGULATIONS.  
DO NOT SCALE.  
ORDNANCE SURVEY IRELAND LICENCE No. AR 0105719  
© ORDNANCE SURVEY IRELAND / GOVERNMENT OF IRELAND

- LEGEND:**
- EXISTING STORM SEWER
  - EXISTING CONTAMINATED STORM SEWER
  - EXISTING FOUL SEWER
  - EXISTING CONCRETE CHANNEL DRAIN (STORM)
  - EXISTING CONCRETE CHANNEL DRAIN (STORM - CONTAMINATED)
  - PROPOSED STORM SEWER

Rev.	Description	GR	Date
A	ISSUED FOR ADDITIONAL INFORMATION	GR	18.01.22
-	ISSUED FOR PLANNING	GR	18.05.21

**McArdle Doyle**  
Second Floor  
Exchange Building  
The Long Walk  
Dundalk, Co. Louth

Chartered Engineers  
Architectural Services  
& Project Managers  
mail@mcardle-doyle.ie  
+353(0) 42 942 9052

PROJECT:  
RETENTION OF DEVELOPMENT AT  
12 CRAG AVENUE, CLONDALKIN  
INDUSTRIAL ESTATE

CLIENT:  
EMO OIL LTD.

DRAWING TITLE:  
DRAINAGE LAYOUT

Date	Drawn	Checked	Approved
18/05/21	GR	RMcA	RMcA

Scale at AS SHOWN	Drawing Number	Status	Rev.
AS SHOWN	P1922.C03	P	A