

- LEGEND**
- Boundary Line**
 - Existing Levels**
 - Proposed Levels**
 - Existing Tree and Hedge on site to be retained** (See Tree Survey for details)
 - Existing Tree on site to be removed** (See Tree Survey for details)
 - SOFT LANDSCAPE** Indicative proposed planting
 - Proposed Tree Planting** Trees to be planted on 600-800mm topsoil
 - Street Trees (T1)** to include the following species: *Tilia cordata*, *Prunus avium*, *Betula pendula*, *Sorbus aria*
 - Ornamental Trees (T2)** to include the following species: *Ameiandier lamarcxii*, *Betula pendula*, *Prunus avium*
 - N7 Buffer Trees (T3)** to include the following species: *Pinus sylvestris*, *Quercus robur*, *Ulmus 'Lobelii'*, *Crataegus laevigata*, *Corylus avellana*, *Betula pendula*, *Liriodendron tulipifera Fastigiata*
 - Early Mature Trees** Outside site boundary
 - N7 Buffer Planting** Native species hedgerow on 450mm topsoil to include the following species: *Betula pubescens*, *Corylus avellana*, *Salix caprea*, *Sorbus aucuparia*, *Euonymus europaeus*, *Ilex aquifolium*, *Crataegus monogyna*, *Viburnum opulus*, *Mahonia aquifolium*, *Cornus sanguinea*, *Forsythia intermedia*, *Hamamelis mollis*
 - Native Hedgerow and Scrub Planting** Native species hedgerow on 450mm topsoil to include the following species: *Crataegus monogyna*, *Prunus spinosa*, *Euonymus europaeus*, *Corylus avellana*, *Ilex aquifolium*, *Viburnum opulus*
 - High Screening Planting** Low-maintenance tree buffer planting on 450mm topsoil to include the following species: *Euonymus europaeus*, *Ilex aquifolium*, *Crataegus monogyna*, *Viburnum opulus*, *Mahonia aquifolium*, *Cornus sanguinea*, *Forsythia intermedia*, *Hamamelis mollis*
 - General Buffer Planting** Low-maintenance planting with buffer planting on 450mm topsoil to include the following species: *Lavandula 'Hidcote'*, *Sarcococca sp.*, *Enca sp.*, *Luzula sp.*, *Carex oshimensis 'Evergold'*, *Hypericum 'Hidcote'*, *Mahonia aquifolium*, *Rosmarinus officinalis*, *Lonicera pileata*, *Vinca minor*, *Viburnum davidii*, *Pennisetum 'Kerley Rose'*, *Salvia nemorosa 'Ostfriesland'*
 - SuDs Area Planting** Low-maintenance planting with buffer planting on 450mm topsoil to include the following species: *Purple moor-grass Molinia caerulea*, *Reed sweet-grass Glycyrrhiza maxima*, *Hard rush Junco inflexus*, *Marsh marigold Caltha palustris*, *Purple loosestrife Lythrum salicaria*, *Brooklime Veronica beccabunga*, *Yellow flag Iris pseudacorus*, *Chokeberry Aronia arbutifolia*, *Pagoda dogwood Cornus alternifolia*, *Little bluestem Andropogon scoparius*, *Switch grass Panicum virgatum*, *Prairie dropseed Sporobolus heterolepis*, *Pale purple coneflower Echinacea pallida*, *Yellow coneflower Rastbida pinnata*
 - Ornamental Textured Planting** Low-maintenance planting with year-round interest on 450mm topsoil to include the following species: *Lavandula 'Hidcote'*, *Sarcococca sp.*, *Enca sp.*, *Hypericum 'Hidcote'*, *Rosmarinus officinalis*, *Vinca minor*, *Viburnum davidii*, *Pennisetum 'Kerley Rose'*, *Daphne*
 - *Species Native to Ireland*
 - Grass Area** Grass Seed Mix, 200mm topsoil depth
 - Play Grass** Utility/ Play Grass Seed Mix on impact absorbing structure, to support intensive use, Safagrass Mat or similar approved, 200mm topsoil depth
 - Existing Roadside Vegetation to be Retained**
- HARD LANDSCAPE**
- Boulevard Roadway** Asphalt to Engineer's Specification
 - Local Roadway** Asphalt to Engineer's Specification
 - Kerbless Homezone** PC Vehicular Pavers block paving
 - Traffic Calming Ramp** PC Vehicular Pavers 300x150x100 block paving, Colour: Mid-Grey with Graphite edging set, City Pave VSS, or similar approved.
 - Parking Roadway** Permeable vehicular 240x120x60 block paving, Colour: Natural, Tobermore Hydropave 240, or similar approved.
 - Footpath/Concrete Area** Broom brushed concrete, or similar approved
 - Cycle Lane** Coloured tarmac or permeable block paving, red tones, or similar approved
 - Entrance Paving** PC Block Paving
 - Rear Patio Paving** PC Block Paving
 - Park Paver Area** PC Block Paving
 - Crushed Gravel/Resin Bound Area** Resin Bounded Surface, Colour TBD
 - Play Safe Surface** Play Safe Surface, Colour TBD
 - Cycle Parking Surface** Self-binding Gravel
 - Grasscrete**
- LANDSCAPE ELEMENTS**
- Kerb** Slipform concrete kerb.
 - Cycleway Edge** 50mm high edge element to define cycleway edge.
 - Tactile Paving** Blister/Corrugated tactile paving location at modal transition areas. To be installed at Crossing Points in accordance with TII Requirements and best practice guidance. Exact details and location to be determined during detail design with engineer.
- FURNITURE**
- Natural Play Elements** Stepping stones, balance logs, vertical logs, and other natural elements and play structures.
 - General Play Elements** Stepping stones, balance logs, vertical logs, and other natural elements and play structures.
 - Public Seating (20 no.)** Bench Type (1) +450mm height benches without armrest or backrest; Omos S22 or Hartcast HC2033B Bench, or similar approved
 - Cycle Stand (119 no., 238 spaces)** Sheffield standard stand, parallel or at 45°, see plan for layout
 - Bins**
 - Sculpture/ Artistic element**
 - Staging areas for bins weekly collection**
- BOUNDARY TREATMENTS**
- Front Garden Railing** Mild Steel Bar Railings, Galvanised, 1.8m high
 - Side Garden Boundary** Timber Panel Fence with Concrete Posts, 2.0m high
 - Rear Garden Boundary** Concrete Block Wall. Rendered and Capped, 2.0m high (to engineer's details and specifications)
 - Play Safe Railing** 1100mm protective railing
 - Acoustic wall (3 meters high)** designed by acoustic engineer
 - Wiremesh Paladin Fencing** 2.0m high, Galvanised, Powder Coated
 - Post and Rail Fence** 1.2m high

Key Plan 1:5000

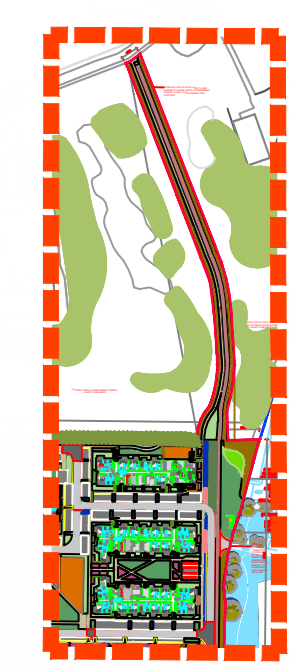

1. This drawing is intended to show landscape architectural proposals only. Please refer to Architects and Engineer's drawings for relevant details of buildings, structures, roads, parking, etc.
 2. The copyright of this drawing is vested with Murray & Associates. This drawing may not be copied or reproduced without written consent.
 3. All materials related to on the drawing - including plant species - are indicative and subject to change following detailed site investigation. Significant changes, if any are required, will be referred to the relevant authority for agreement.
 4. This drawing is not suitable for use for construction purposes.
 5. Discrepancies to be referred to Murray & Associates for clarification.

murray & associates
 landscape architecture

14 The Seapoint Building, murray@murrayassociates.com
 44-45, Clontarf Road, www.murrayassociates.com
 Dublin 3, D03 0F63 +353 (0)1 404 0095

REV	DATE	REVISION	DRAWN	CHECKED
B	14/12/21	Issue for Planning	IS	MB
A	29/11/21	Issue for Planning	IS	MB
0	22/09/20	Issue for Planning	IS	MB

CLIENT
Tetrarch Residential Ltd.

PROJECT FILE
Strategic Housing Development, on site at Mill Road, Saggart, Co. Dublin

SHEET FILE
Landscape Plan (4)

SHEET NO.
1829_PL_P_04

SHEET SIZE
A1

SCALE
1:500

REVISION
B

STAGE
DATE
14/12/21

Copyright Murray and Associates, 2020