

GENERAL NOTES:
 THE DEVELOPER/CONTRACTOR/BUILDER IS TO ENSURE THAT THE BUILDING UNDER CONSTRUCTION IS TO COMPLY FULLY WHERE APPLICABLE WITH THE BUILDING REGULATIONS 1997 WITH RESPECT TO ALL TRADES INVOLVED IN THE CONSTRUCTION OF THE DEVELOPMENT.
 THE DEVELOPER/CONTRACTOR/BUILDER SHOULD NOTIFY ALL WHITTAKER & ASSOCIATES LIMITED OF ANY INTENDED DEVIATIONS FROM THESE PLANS PRIOR TO COMMENCEMENT OF DEVELOPMENT.
 CONTRACTORS MUST VERIFY ALL DIMENSIONS IN SITE BEFORE COMMENCING ANY WORK. NO WORKING DIMENSIONS TO BE SCALE DIMENSIONS UNLESS SHOWN TO BE OTHERWISE.
 THIS DRAWING AND DESIGN IS COPYRIGHT AND IS THE PROPERTY OF ALL WHITTAKER & ASSOCIATES LTD. A.J. WHITTAKER & ASSOCIATES LIMITED, REGISTERED IN IRELAND NO. 527664.

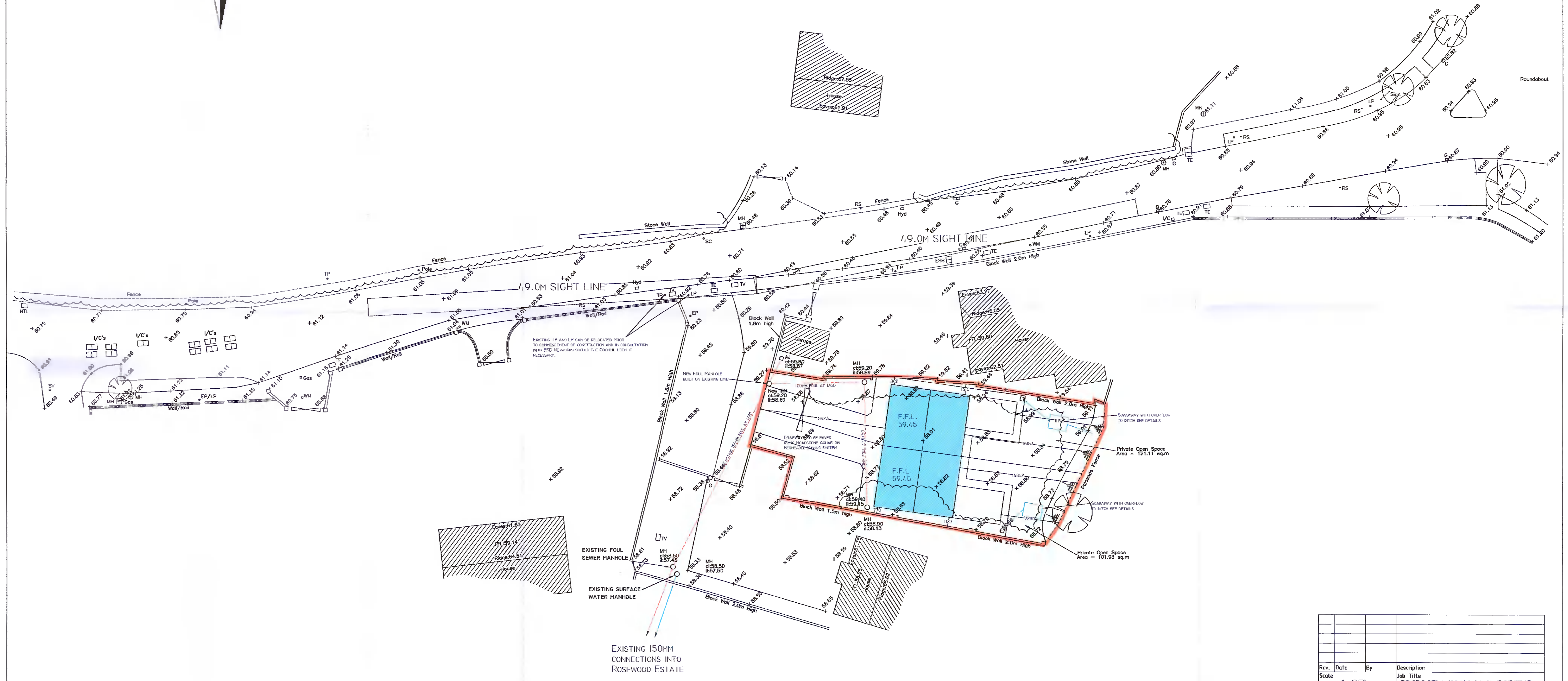
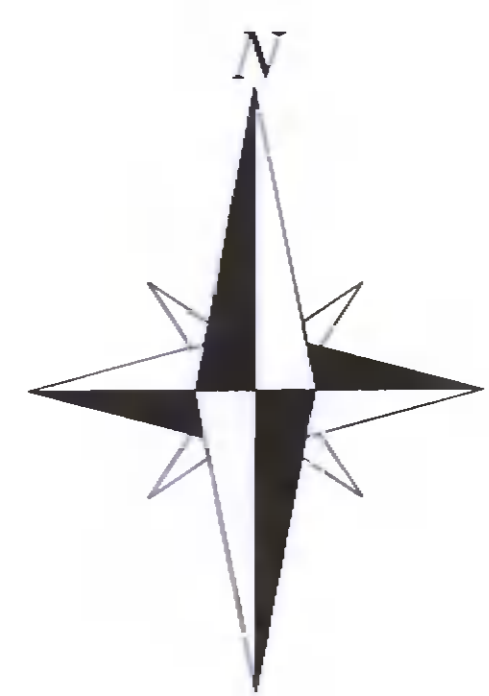

Rev.	Date	By	Description
Scale	1 : 250		Job Title
Date	NOV. 2021		PROPOSED WORKS AT SIDE OF THE BUNGALOW, LUCAN NEWLANDS ROAD BALGADDEY, LUCAN CO. DUBLIN.
Drawn by	D.C.		Drawing Title
Org. No.	21/1437/02	Rev.	Client
			EDWARD BENNETT & PAUL BOYLE

© A. J. WHITTAKER & ASSOCIATES
 ARCHITECTS, PLANNING &
 FIRE SAFETY CONSULTANTS
 55 LUDFORD DRIVE, BALLINTEER, DUBLIN 16.
 TEL: 086-8147081
 Email: a-jwplanning@gmail.com