

# Drawing : Proposed Ground floor plan & Drainage layout

WB : DOWNPIPE + WATER BUTT + GULLY TRAP AT ALL SURFACE WATER DOWNPIPE LOCATIONS  
 NOTE : ALL NEW PATIO / DRIVES TO BE WATER PERMEABLE SURFACES  
 WHERE ANY DRAINAGE PIPE TRAVELS UNDER EXTENSION / EXISTING HOUSE , THIS TO BE DONE UNDER STRICT SUPERVISION OF SURVEYSING STRUCTURAL ENGINEER

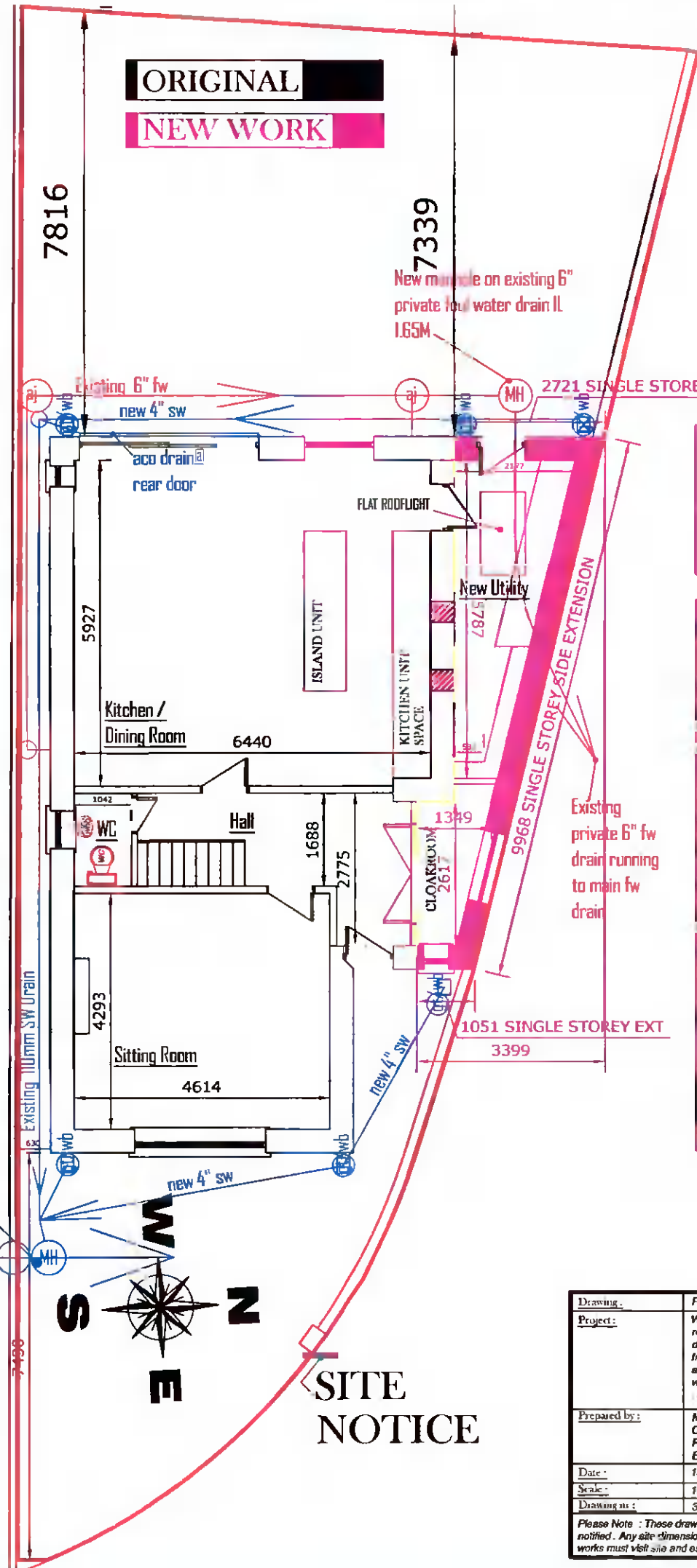

**Blue - indicates**  
 Surface water drain

**Red - indicates Foul**  
 water drain

**Notes on drainage :**

**All surface water downpipes to perimeter of dwelling to discharge to waterbutt prior to discharging to main drain .**

**All new formed patio spaces to be formed in loose gravel ( water permeable surface )**

**Any drains running under the building to be protected in rising walls by placing a concrete lintol in rising wall bridging pipe 100mm above the top of pipe , to prevent any damage to pipe by building settlement .**

**Any Pipework running under the building to be surrounded with leanmix concrete for full protection of pipework**

New manhole on existing 4" private sw water drain ll. 1.15

Existing private SW Drain running to main drain

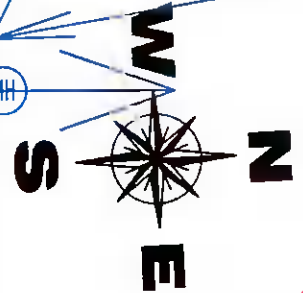

**SITE NOTICE**

Drawing :	Proposed ground floor plan & Drainage layout , Proposed First Floor plan
Project :	We Declan Heary & Liz Mcgrath intend to apply for full planning permission for 1. For a new first floor rear extension 2. For a new single storey side extension 3. For removal of main existing pitched roof on dwelling , and replacement of same with a mixture of pitch and flat roof , placing 1 velux window in front , 2 velux windows in rear , 6 velux windows in north side of new roof , placing 2 velux windows and 1 dormer structure with obscure window on side south face of new roof 4. All associated site works at 432A Orwell park green , Dublin 6w , DeW XCS8 . PREVIOUS PLANNING REFERENCE NR SD21B/0347 DATE OF DECISION : 16-12-2021
Prepared by :	Michael Finnan ( Bsc , MCIOB , MSCSI ) C/O Bidsa Ltd , Lower Fiarstown , Bohernabreena , Dublin 24 Ph : 087-2825326 Email : Michael.Finnan043@gmail.com
Date :	13-1-2022
Scale :	1/100
Drawing no. :	3

Please Note : These drawings are for planning application purposes only and no works to commence until author is notified . Any site dimension discrepancy with drawings to be notified to author immediately . Any builder quoting for works must visit site and establish exact nature of works prior to preparing works quote

# Drawing : Proposed First floor plan

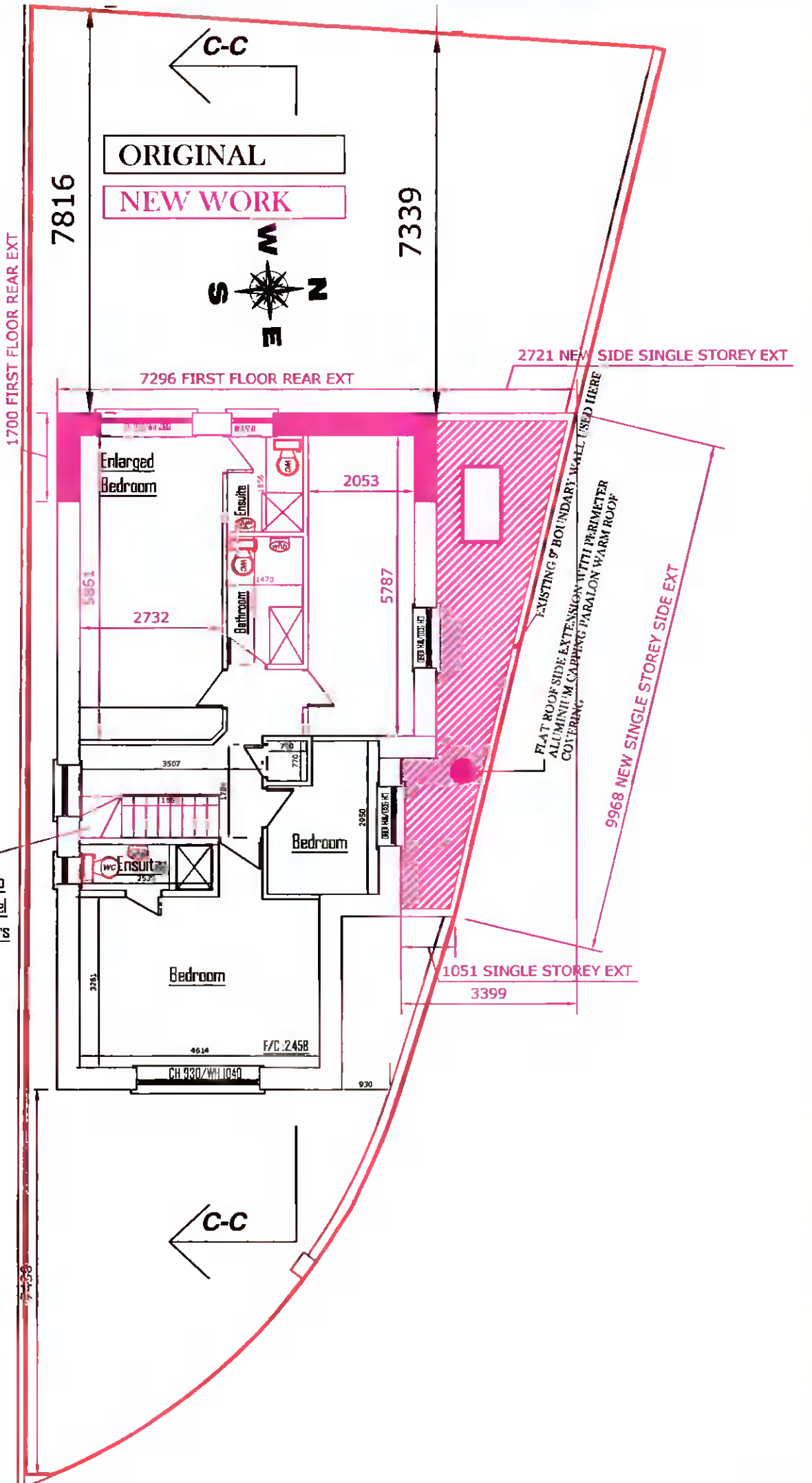

1700 FIRST FLOOR REAR EXT

New stairs to attic parallel to main stairs

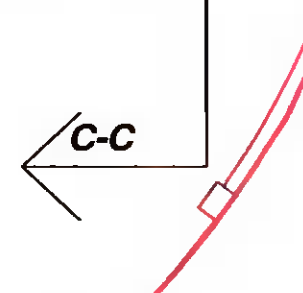

Drawing :	Proposed ground floor plan & Drainage layout , Proposed First Floor plan
Project :	We Declan Heary & Liz Mcgrath intend to apply for full planning permission for 1. For a new first floor rear extension 2. For a new single storey side extension 3. For removal of main existing pitched roof on dwelling , and replacement of same with a mixture of pitch and flat roof , placing 1 velux window in front , 2 velux windows in rear , 6 velux windows in north side of new roof , placing 2 velux windows and 1 dormer structure with obscure window on side south face of new roof 4. All associated site works at 432A Orwell park green , Dublin 6w , DeW XCS8 . PREVIOUS PLANNING REFERENCE NR SD21B/0347 DATE OF DECISION : 16-12-2021
Prepared by :	Michael Finnan ( Bsc , MCIOB , MSCSI ) C/O Bidsa Ltd , Lower Fiarstown , Bohernabreena , Dublin 24 Ph : 087-2825326 Email : Michael.Finnan043@gmail.com
Date :	13-1-2022
Scale :	1/100
Drawing no. :	3

Please Note : These drawings are for planning application purposes only and no works to commence until author is notified . Any site dimension discrepancy with drawings to be notified to author immediately . Any builder quoting for works must visit site and establish exact nature of works prior to preparing works quote