



 Luminaire B 	 Luminaire C 	 Luminaire D
Supplier	Historic Lanterns	Thorn UK	
Type	SRS201	Avenue Deco - Clear Prismatic Dif f - 18 x LEDs 3000K 700mA -	BRP708 T25 DM50 LED21/740 NO
Lamp(s)	SOX55W/-	LED 3000K LED21-4S/740	
Lamp Flux (klm)	7.80	3.12	2.10
Maintenance Factor	0.85	1.00	1.00
No. in Project	8	10	7



LIGHTING REALITY

PROJECT NAME:
Cherry Orchard, Palmerstown

PROJECT No: **M70**

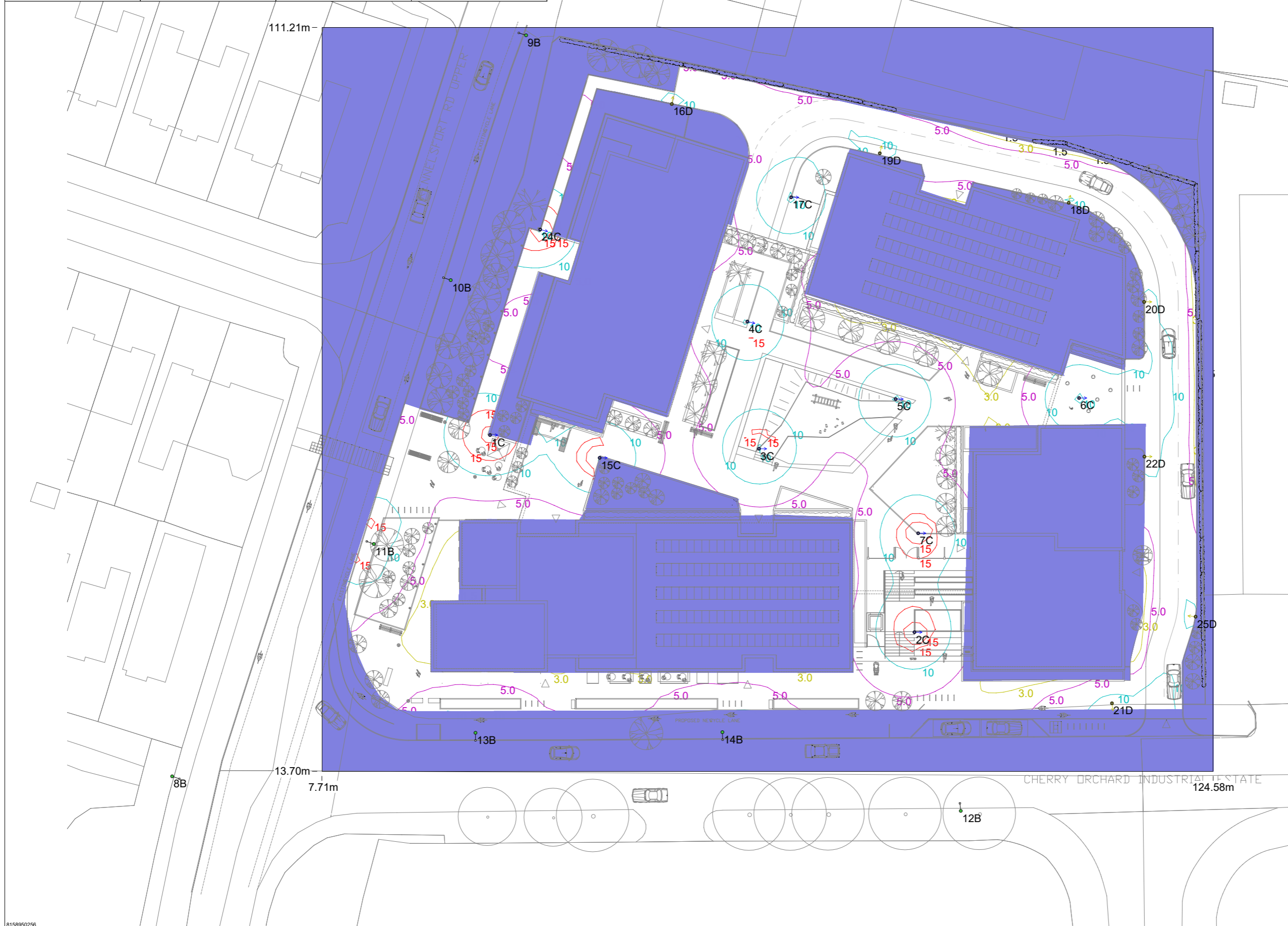
SCALE: **1:500** DATE: **14 December 2021**

CALCULATION:
Horizontal Illuminance (lux)

DESIGNER:
Ben van Deventer DKPI

Lux levels calculation results for for the circulation areas are in compliance with P3 EN13201 2015.
P3 is maintained for all areas, vehicular and pedestrian including podium circulation areas for even and adequate lux levels.
Base target level of horizontal illuminance for P3 is 7.50 Lux average and 1.50 lux min.
Constant Light output is used for these led fittings hence the MF relates to 2% led failure and 8% fouling only.
The calculation shows a respectable uniformity Emin/Eav of 0.24
The existing "B" fittings are shown for calculation purposes only as they impact on the relevant calculation grids

Public Lighting design for above mentioned project :
Light fittings to dim 25% (75% output) between midnight and 6 am (profile 2A)
Fittings must be ordered with Nema socket for 35/18 lux switching photo cell and to have CLO function applied
(Constant light output) Calculations comply to EN13201-2015

PREPARED BY:
Ben van Deventer
DKP International
CBG House
Kenmare
Co Kerry
Design Software from:
Lighting Reality Ltd

Results Grid 1	
Eav	7.58
Emin	1.63
Emax	16.94
Emin/Emax	0.10
Emin/Eav	0.22