



Symbol	Species and size
	Existing Trees to be protected during construction if within the hoarded site. Refer to Arboriculturist's Report.
	Existing Tree to be removed as part of proposed works associated with this development. Refer to Arboriculturist's Report. T288 Immature Cat C2 Norway Maple - fell T289 Dead Cat U Norway Maple - fell
	Seeded or turf lawn

Symbol	Species and size	Street Quantity	Podium Quantity
	<i>Quercus palustris</i> Pin Oak 20-22 cm girth, 2m clear stem, 4-5m tall, rootball	3	5
	<i>Acer campestre</i> Field Maple 18-20 cm girth, 2m clear stem, 4-5m tall, rootball	8	0
	<i>Betula pendula</i> or <i>ermanii</i> Silver Birch 16-18 cm girth, multi stem, 4-5 m tall, rootball	32	7
	<i>Carpinus betulus</i> Hornbeam 18-20 cm girth, 2m clear stem, 4-5m tall, rootball	17	9
	<i>Quercus ilex</i> Holm Oak (evergreen) 20-22 cm girth, 2m clear stem, 4-5m tall, rootball	4	4
	<i>Amelanchier lamarckii</i> Snowy Mespilus 12-14 cm girth, multistemmed, rootball, 2.5-3m tall	0	12
	PLANTERS - Ornamental grasses & Seasonal Interest <i>Stipa tenuissima</i> , <i>Helenium 'Moerheim Beauty'</i> <i>Verbena bonariensis</i> , <i>Buxus</i> , <i>Crocsmia 'Emily McKenzie'</i>		
	PLANTERS - Evergreen with some Seasonal Interest <i>Buxus</i> , <i>Privet</i> , <i>Hebe pinguifolia 'sutherlandii'</i> , <i>Astranta 'Buckland'</i> , <i>Hydrangea</i> , <i>Hakonechloa macra</i>		
	EVERGREEN HEDGING Portuguese Laurel for medium height <i>Buxus sempervirens</i> for low height		



Carpinus betulus (Hornbeam) Betula pendula with under storey of grasses



Acer campestre (Field Maple) Quercus palustris (Pin Oak)

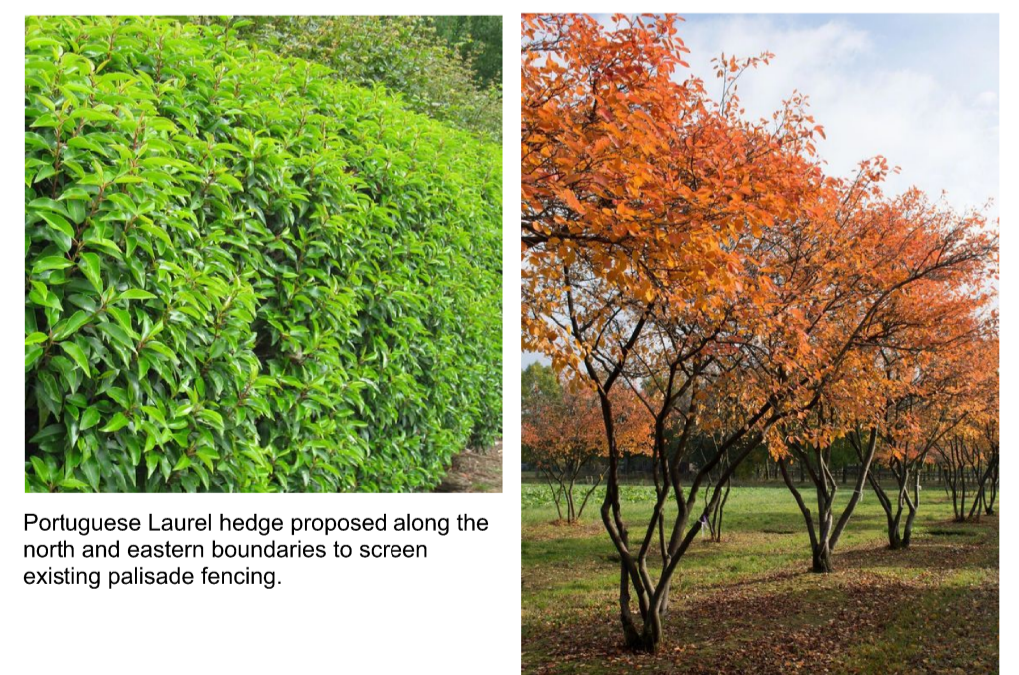

Portuguese Laurel hedge proposed along the north and eastern boundaries to screen existing palisade fencing. Amelanchier lamarckii proposed in clusters in large planter on the podium.

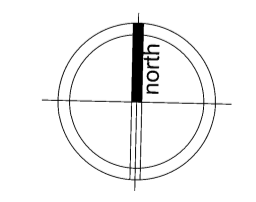

**NOTES / LEGEND**

DO NOT SCALE. USE FIGURED DIMENSIONS ONLY.  
THIS DRAWING IS TO BE READ IN CONJUNCTION WITH ALL RELEVANT SPECIFICATIONS AND DRAWINGS.  
ALL DIMENSIONS TO BE CHECKED ON SITE.  
IN THE EVENT OF ANY DISCREPANCIES BETWEEN DRAWINGS THE CONTRACTOR IS TO INFORM THE ARCHITECT IMMEDIATELY.

Revision	Date	Description	By
P.0	06.12.21	Issued for SHD Planning Application	IR

Drawing Status:  
**planning application**

Telephone: +353 85 7378900  
e-mail: isa@ilsarutgers.com

Project:	ORCHARD GATE SHD, Palmerstown
Drawn by:	LANDSCAPE DESIGN - PRIMARY PLANTING PLAN
Date:	November 2021
Scale:	1:250@A1 / 1:500@A3
Client:	AAI Palmerstown Ltd.
Job No.:	210401
Draw No.:	3000
Rev.:	P1

**ilsa rutgers landscape architecture**  
ARCHITECTURAL DESIGN LANDSCAPE DESIGN