

EXISTING LONGITUDINAL SECTION (A-A), Scale: 1/100

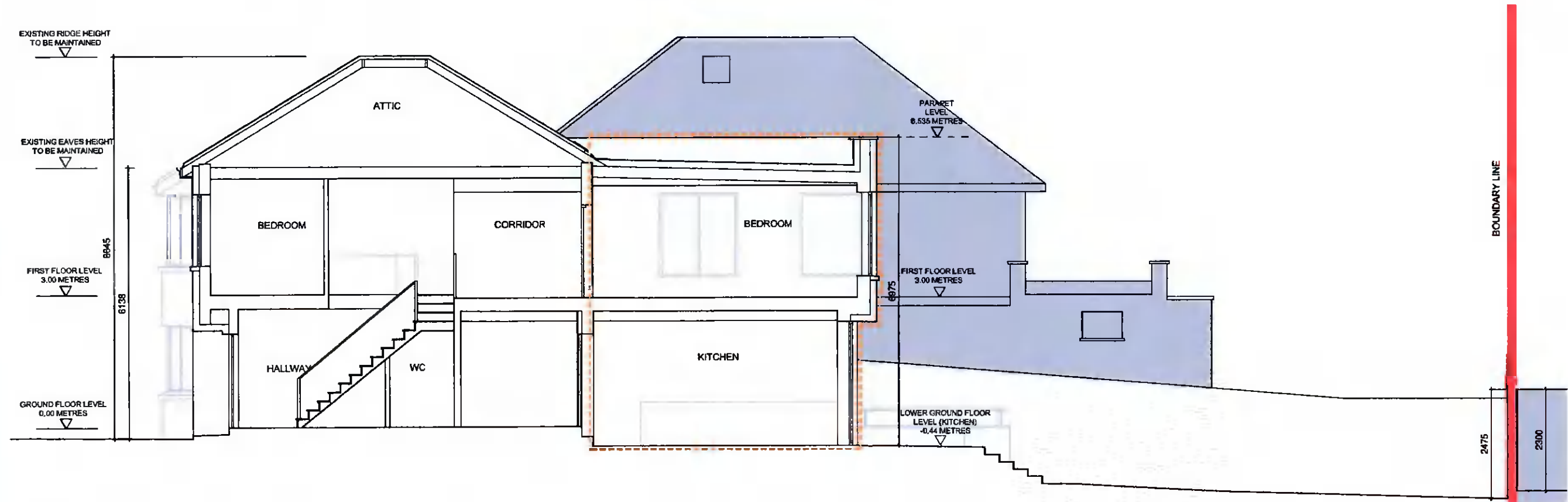

PROPOSED LONGITUDINAL SECTION (A-A), Scale: 1/100

— SITE BOUNDARY SUBJECT OF CURRENT PLANNING APPLICATION

- - - PROPOSED EXTENSIONS OUTLINED IN ORANGE



NO DIMENSIONS TO BE SCALED OFF THIS DRAWING
ALL DIMENSIONS TO BE CHECKED ON SITE
THE DRAWING IS COPYRIGHT
SPOT LEVELS SHOWN IN RELATION TO GROUND FLOOR LEVEL

REV	DATE	DRN	NOTES
A	05.01.21	AL	ISSUED FOR PLANNING

REV	DATE	DRN	NOTES

ARANZAZU LERA ANTON ARCHITECT
141 RATHFARNHAM ROAD, RATHFARNHAM, DUBLIN 14
T 0871027162 E aleranton@gmail.com

DWG. SERIES 3.1 PLANNING	
PROJECT	PROPOSED HOUSE EXTENSION AT ST KEVIN'S, 17 RATHFARNHAM PK, D 14
DRN. TITLE	EXISTING AND PROPOSED LONGITUDINAL SECTIONS (A-A)
CLIENT	WILLIAM JUDGE
DRN BY	AL
SCALE	1:100
JOB NO	21-101
DATE	23.12.21
DWG NO	3.1.301
REV	A

ORIGINAL SHEET SIZE = A3