

PART 1 STOREY, PART 2 STOREY EXTENSION AT THE REAR
 GROUND FLOOR LEVELS AT BACK EXTENSION ARE SPLIT TO FACILITATE CHANGE IN LEVEL

EXISTING SINGLE STOREY SHEDS TO BE DEMOLISHED AND NEW TWO STOREY EXTENSION TO BE CONSTRUCTED

EXISTING SINGLE STOREY GARAGE TO BE DEMOLISHED AND NEW SINGLE STOREY GARAGE TO BE CONSTRUCTED SET BACK FROM ORIGINAL LINE (INDICATED IN DASHED BLUE)

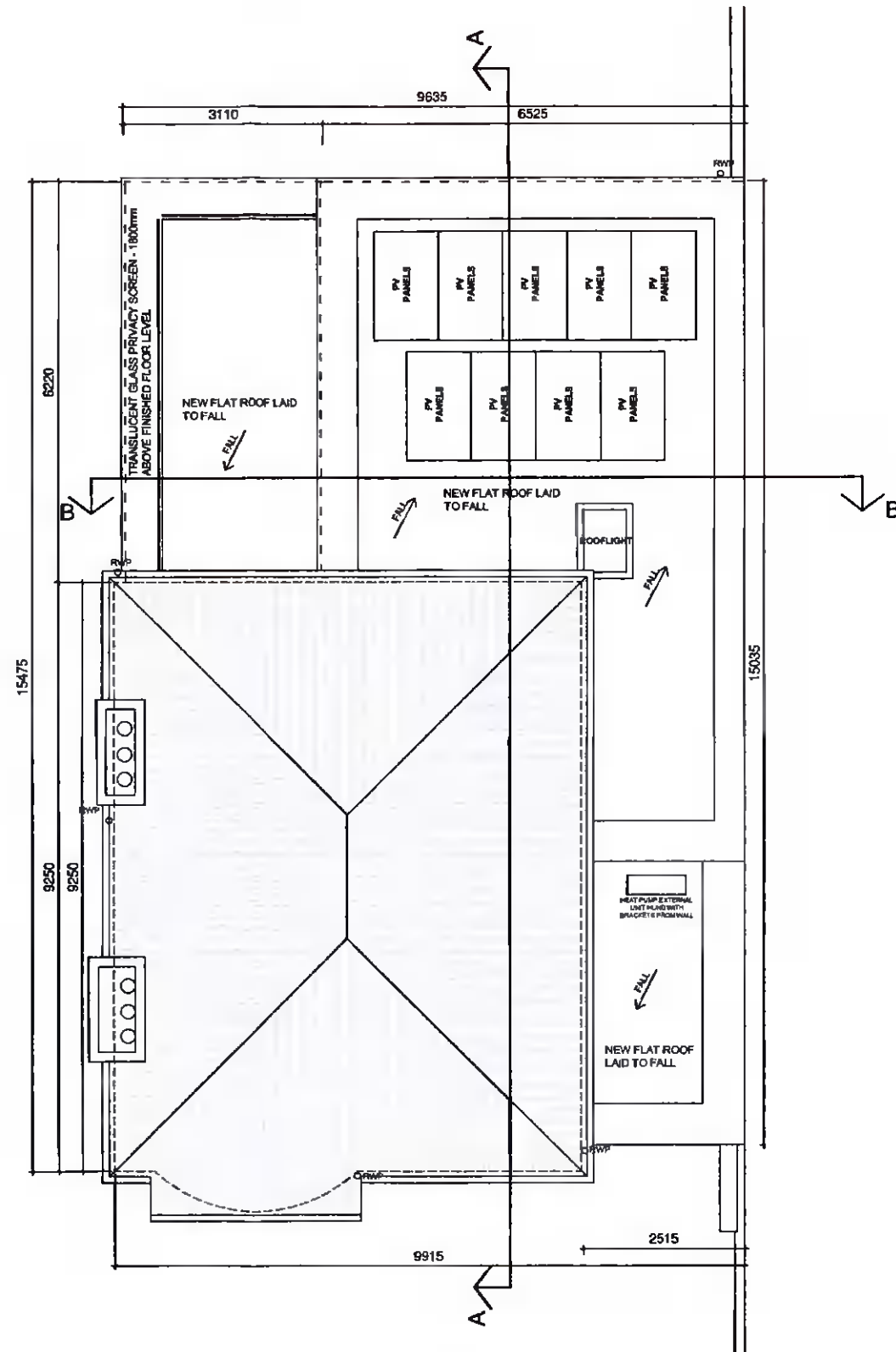

PROPOSED ROOF PLAN, Scale: 1/100

- SITE BOUNDARY SUBJECT OF CURRENT PLANNING APPLICATION
- EXISTING WALLS RETAINED
- PROPOSED NEW WALLS
- EXTERNAL INSULATION TO EXISTING WALLS
- PROPOSED ALTERATIONS AND ADDITIONAL FLOOR AREAS
- EXISTING WALLS TO BE REMOVED

NEW AREAS OF HOUSE:
 - GROUND FLOOR: 118.6 m²
 - FIRST FLOOR: 97 m²
 - TOTAL AREA: 215.6 m²

AREA OF EXISTING DWELLING: 133 m²

FLOOR AREA INCREASED BY 82.6 m²

ALL FOUL WATER TO JOIN TO EXISTING CONNECTIONS FOR SURFACE WATER: SOAKWAY TO BE DESIGNED IN ACCORDANCE WITH BRE DIGEST 365 AS INDICATED IN THE PROPOSED SITE PLAN (DRAWING NUMBER 3.1_105).

PROPOSED FIRST FLOOR PLAN, Scale: 1/100
 Proposed Ground Floor Area: 97 sqm
 Existing Retained: 54 sqm
 New floor area: 43 sqm

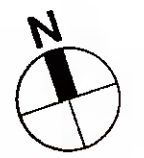

NO DIMENSIONS TO BE SCALED OFF THIS DRAWING
 ALL DIMENSIONS TO BE CHECKED ON SITE
 THE DRAWING IS COPYRIGHT
 SPOT LEVELS SHOWN IN RELATION TO GROUND FLOOR LEVEL

REV	DATE	DRN	NOTES
A	05.01.21	AL	ISSUED FOR PLANNING

REV	DATE	DRN	NOTES

ARANZAZU LERA ANTON ARCHITECT
 141 RATHFARNHAM ROAD, RATHFARNHAM, DUBLIN 14
 T 0871027162 E aleranton@gmail.com

DWG. SERIES 3.1 PLANNING			
PROJECT	PROPOSED HOUSE EXTENSION AT ST KEVIN'S, 17 RATHFARNHAM PK, D 14	JOB NO	21-101
DRN. TITLE	PROPOSED FIRST FLOOR AND ROOF PLANS	DATE	23.12.21
CLIENT	WILLIAM JUDGE	DRN BY	AL
		SCALE	1:100
		DWG NO	3.1_104
		REV	A

ORIGINAL SHEET SIZE = A3