

**DATE:** 10 December 2021  
**DESIGNER:** Thomas McCormack / Ross Traynor  
**PROJECT No:** 21039  
**PROJECT NAME:** Tubberlane 3



Designed in accordance with BS5489-1-2020 Class P4 & in accordance with South Dublin County Council Public Lighting Specification Rev 0 2016

## **PUBLIC LIGHTING REPORT**

## Layout Report

### General Data

Dimensions in Metres Angles in Degrees

### Calculation Grids

ID	Grid Name	X	Y	X' Length	Y' Length	X' Spacing	Y' Spacing
1	Grid 1	5922.39	1055.51	273.33	371.03	1.49	1.50
2	Grid 2	5594.06	757.38	336.90	303.08	1.50	1.49

### Luminaires



#### Luminaire B Data

Supplier	C U Phosco
Type	P852-12-P4-WW-CA0750-29W
Lamp(s)	730C WW
Lamp Flux (klm)	3.32
File Name	P852-12-P4-WW-CA0750-29W ies
Maintenance Factor	0.84
Imax70,80,90(cd/klm)	730.4, 161.4, 0.8
No. in Project	104



#### Luminaire C Data

Supplier	C U Phosco
Type	P852-12-R3B-WW-CA0200-9W
Lamp(s)	730C WW
Lamp Flux (klm)	1.04
File Name	P852-12-R3B-WW-CA0200-9W ies
Maintenance Factor	0.84
Imax70,80,90(cd/klm)	876.7, 56.5, 1.7
No. in Project	46

### Layout

ID	Type	X	Y	Height	Angle	Tilt	Cant	Out-reach	Target X	Target Y	Target Z
1	B	5890.67	1237.43	6.00	108.00	5.00	0.00	0.40			
2	B	5897.67	1262.29	6.00	278.00	5.00	0.00	0.40			
3	B	5862.21	1250.03	6.00	297.00	5.00	0.00	0.40			
4	B	5861.59	1224.35	6.00	117.00	5.00	0.00	0.40			
5	B	5829.70	1235.06	6.00	305.00	5.00	0.00	0.40			
6	B	5834.98	1209.99	6.00	117.00	5.00	0.00	0.40			
7	B	5800.95	1221.08	6.00	302.00	5.00	0.00	0.40			
8	B	5805.61	1194.69	6.00	112.00	5.00	0.00	0.40			
9	B	5771.71	1205.62	6.00	300.00	5.00	0.00	0.40			
10	B	5771.65	1177.36	6.00	113.00	5.00	0.00	0.40			
11	B	5739.37	1188.67	6.00	295.00	5.00	0.00	0.40			
12	B	5746.92	1164.89	6.00	115.00	5.00	0.00	0.40			
13	B	5726.82	1193.48	6.00	205.00	5.00	0.00	0.40			
14	B	5709.61	1173.52	6.00	26.00	5.00	0.00	0.40			
15	B	5725.60	1144.22	6.00	20.00	5.00	0.00	0.40			
16	B	5750.92	1138.43	6.00	210.00	5.00	0.00	0.40			
17	B	5711.64	1220.53	8.00	222.00	5.00	0.00	0.40			
18	B	5693.01	1203.13	6.00	35.00	5.00	0.00	0.40			
19	B	5684.48	1250.83	6.00	223.00	5.00	0.00	0.40			

**Layout Continued**

ID	Type	X	Y	Height	Angle	Tilt	Cant	Out-reach	Target X	Target Y	Target Z
20	B	5672.36	1232.31	6.00	45.00	5.00	0.00	0.40			
21	B	5663.51	1271.48	6.00	227.00	5.00	0.00	0.40			
22	B	5643.96	1260.37	6.00	50.00	5.00	0.00	0.40			
23	B	5635.53	1295.76	6.00	235.00	5.00	0.00	0.40			
24	B	5611.04	1285.69	6.00	61.00	5.00	0.00	0.40			
25	B	5606.14	1313.25	6.00	240.00	5.00	0.00	0.40			
26	B	5585.09	1298.25	6.00	61.00	5.00	0.00	0.40			
27	B	5579.10	1280.36	6.00	313.00	5.00	0.00	0.40			
28	C	5605.64	1278.57	6.00	65.00	5.00	0.00	0.40			
29	C	5567.77	1268.98	5.00	201.00	0.00	0.00	0.40			
30	C	5582.05	1243.46	5.00	209.00	0.00	0.00	0.40			
31	C	5590.33	1226.74	5.00	209.00	0.00	0.00	0.40			
32	B	5607.61	1209.06	6.00	203.00	0.00	0.00	0.40			
33	B	5703.98	1150.45	6.00	117.00	5.00	0.00	0.40			
34	B	5661.80	1151.51	6.00	295.00	5.00	0.00	0.40			
35	B	5691.89	1166.90	6.00	203.00	5.00	0.00	0.40			
36	B	5660.59	1130.58	6.00	115.00	5.00	0.00	0.40			
37	B	5679.06	1194.98	6.00	201.00	5.00	0.00	0.40			
38	B	5664.25	1215.41	6.00	223.00	5.00	0.00	0.40			
39	B	5648.69	1231.82	6.00	221.00	5.00	0.00	0.40			
40	C	5627.63	1247.16	5.00	216.00	5.00	0.00	0.40			
41	C	5617.23	1230.16	6.00	135.00	5.00	0.00	0.40			
42	B	5621.15	1179.91	6.00	204.00	0.00	0.00	0.40			
43	B	5638.58	1141.18	6.00	206.00	0.00	0.00	0.40			
44	B	5649.20	1101.41	6.00	26.00	5.00	0.00	0.40			
45	B	5669.09	1059.25	6.00	22.00	5.00	0.00	0.40			
46	B	5691.33	1075.17	6.00	296.00	5.00	0.00	0.40			
47	C	5715.89	1076.69	6.00	115.00	5.00	0.00	0.40			
48	B	5738.53	1114.02	6.00	27.00	5.00	0.00	0.40			
49	B	5763.46	1109.89	6.00	204.00	5.00	0.00	0.40			
50	C	5726.33	1096.72	6.00	297.00	5.00	0.00	0.40			
51	B	5741.11	1082.16	6.00	117.00	5.00	0.00	0.40			
52	B	5755.60	1083.86	6.00	24.00	5.00	0.00	0.40			
53	B	5764.29	1055.52	6.00	24.00	5.00	0.00	0.40			
54	B	5794.38	1071.02	6.00	115.00	5.00	0.00	0.40			
55	B	5785.01	1088.08	6.00	296.00	5.00	0.00	0.40			

**Layout Continued**

ID	Type	X	Y	Height	Angle	Tilt	Cant	Out-reach	Target X	Target Y	Target Z
56	B	5788.38	1055.14	6.00	204.00	5.00	0.00	0.40			
57	B	5818.11	1087.49	6.00	115.00	5.00	0.00	0.40			
58	B	5855.74	1115.08	6.00	294.00	5.00	0.00	0.40			
59	B	5897.18	1095.48	6.00	20.00	5.00	0.00	0.40			
60	B	5890.09	1130.64	6.00	294.00	5.00	0.00	0.40			
61	B	5892.53	1153.74	6.00	24.00	5.00	0.00	0.40			
62	B	5877.25	1178.78	6.00	30.00	5.00	0.00	0.40			
63	B	5859.49	1180.45	6.00	115.00	5.00	0.00	0.40			
64	B	5843.47	1189.57	6.00	293.00	5.00	0.00	0.40			
65	B	5826.51	1165.47	6.00	115.00	5.00	0.00	0.40			
66	C	5867.13	1200.59	6.00	297.00	5.00	0.00	0.40			
67	B	5797.42	1167.98	6.00	299.00	5.00	0.00	0.40			
68	B	5780.11	1143.78	6.00	115.00	5.00	0.00	0.40			
69	C	5767.47	1158.04	6.00	297.00	5.00	0.00	0.40			
70	B	5908.91	1066.44	6.00	357.00	5.00	0.00	0.40			
71	C	5928.52	1078.40	6.00	269.00	5.00	0.00	0.40			
72	B	5882.08	1053.59	6.00	288.00	5.00	0.00	0.40			
73	B	5786.81	1007.82	6.00	25.00	5.00	0.00	0.40			
74	B	5801.28	1027.21	6.00	207.00	5.00	0.00	0.40			
75	B	5816.26	996.16	6.00	204.00	5.00	0.00	0.40			
76	B	5800.76	977.00	6.00	32.00	5.00	0.00	0.40			
77	B	5754.75	1020.80	6.00	115.00	5.00	0.00	0.40			
78	B	5831.55	962.04	6.00	202.00	5.00	0.00	0.40			
79	B	5815.56	942.33	6.00	30.00	5.00	0.00	0.40			
80	B	5844.45	924.45	6.00	196.00	5.00	0.00	0.40			
81	B	5825.23	909.61	6.00	14.00	5.00	0.00	0.40			
82	B	5768.18	1042.87	6.00	297.00	5.00	0.00	0.40			
83	B	5722.80	1004.20	6.00	112.00	5.00	0.00	0.40			
84	B	5700.25	1014.92	6.00	207.00	5.00	0.00	0.40			
85	B	5710.48	983.01	6.00	204.00	5.00	0.00	0.40			
86	B	5682.56	1000.74	6.00	292.00	5.00	0.00	0.40			
87	B	5676.97	1033.17	6.00	25.00	5.00	0.00	0.40			
88	C	5662.59	1043.81	5.00	301.00	0.00	0.00	0.40			
89	C	5651.17	1025.64	5.00	322.00	0.00	0.00	0.40			
90	C	5647.25	997.35	5.00	190.00	0.00	0.00	0.40			
91	B	5641.25	968.88	6.00	11.00	5.00	0.00	0.40			

**Layout Continued**

ID	Type	X	Y	Height	Angle	Tilt	Cant	Out-reach	Target X	Target Y	Target Z
92	B	5662.46	978.11	6.00	113.00	5.00	0.00	0.40			
93	B	5652.25	943.02	6.00	168.00	5.00	0.00	0.40			
94	B	5720.72	961.25	6.00	206.00	5.00	0.00	0.40			
95	B	5720.74	910.12	6.00	171.00	5.00	0.00	0.40			
96	B	5716.29	874.86	6.00	169.00	5.00	0.00	0.40			
97	B	5703.89	847.26	6.00	354.00	5.00	0.00	0.40			
98	B	5689.80	828.85	6.00	259.00	5.00	0.00	0.40			
99	B	5711.64	813.33	6.00	84.00	5.00	0.00	0.40			
100	B	5661.15	815.81	6.00	78.00	5.00	0.00	0.40			
101	B	5647.29	843.78	6.00	219.00	5.00	0.00	0.40			
102	B	5643.47	873.52	6.00	175.00	5.00	0.00	0.40			
103	B	5648.29	910.99	6.00	171.00	5.00	0.00	0.40			
104	C	5626.82	861.55	6.00	13.00	0.00	0.00	0.40			
105	C	5631.29	890.84	6.00	345.00	0.00	0.00	0.40			
106	B	5741.08	825.22	6.00	265.00	5.00	0.00	0.40			
107	B	5755.10	805.66	6.00	85.00	5.00	0.00	0.40			
108	C	5759.57	793.67	5.00	317.00	0.00	0.00	0.40			
111	C	5744.11	775.29	5.00	111.00	5.00	0.00	0.40			
113	C	5719.70	770.10	5.00	88.00	5.00	0.00	0.40			
115	C	5692.65	778.08	5.00	54.00	5.00	0.00	0.40			
116	C	5672.79	793.55	5.00	52.00	5.00	0.00	0.40			
117	C	5677.89	803.05	5.00	170.00	0.00	0.00	0.40			
118	B	5789.12	848.03	6.00	172.00	5.00	0.00	0.40			
119	B	5772.17	830.07	6.00	351.00	5.00	0.00	0.40			
120	B	5777.82	875.57	6.00	352.00	5.00	0.00	0.40			
121	B	5795.37	898.21	6.00	174.00	5.00	0.00	0.40			
122	B	5783.58	923.25	6.00	352.00	5.00	0.00	0.40			
123	C	5795.19	824.87	5.00	130.00	0.00	0.00	0.40			
124	B	5792.43	951.52	6.00	204.00	5.00	0.00	0.40			
125	B	5776.75	939.41	6.00	27.00	5.00	0.00	0.40			
122	C	5802.71	886.04	5.00	144.00	0.00	0.00	0.40			
127	B	5728.31	934.18	6.00	92.00	5.00	0.00	0.40			
132	C	5856.89	941.20	5.00	140.00	3.00	0.00	0.40			
133	C	5867.12	957.96	5.00	148.00	0.00	0.00	0.40			
134	C	5877.36	981.28	5.00	156.00	0.00	0.00	0.40			
135	C	5889.41	1002.13	5.00	138.00	5.00	0.00	0.40			

**Layout Continued**

ID	Type	X	Y	Height	Angle	Tilt	Cant	Out-reach	Target X	Target Y	Target Z
136	C	5903.49	1020.42	5.00	144.00	5.00	0.00	0.40			
137	C	5880.93	1014.99	5.00	295.00	5.00	0.00	0.40			
138	C	5916.08	1042.47	5.00	154.00	5.00	0.00	0.40			
139	C	5854.38	972.12	5.00	202.00	5.00	0.00	0.40			
140	C	5857.91	1004.55	5.00	298.00	5.00	0.00	0.40			
141	C	5642.52	998.34	5.00	201.00	5.00	0.00	0.40			
142	C	5844.68	1013.50	5.00	203.00	5.00	0.00	0.40			
143	B	5866.65	1030.43	6.00	114.00	5.00	0.00	0.40			
144	B	5835.53	1032.16	6.00	289.00	5.00	0.00	0.40			
145	B	5819.79	1008.71	6.00	118.00	5.00	0.00	0.40			
146	C	5894.90	1040.71	5.00	25.00	5.00	0.00	0.40			
147	C	5882.73	1221.48	6.00	208.00	0.00	0.00	0.40			
148	C	5885.97	1197.77	6.00	173.00	0.00	0.00	0.40			
141	B	5758.02	955.33	6.00	297.00	5.00	0.00	0.40			
142	B	5787.08	968.88	5.00	298.00	0.00	0.00	0.40			
143	C	5809.28	900.81	5.00	283.00	0.00	0.00	0.40			
144	C	5811.12	844.85	5.00	171.00	0.00	0.00	0.40			
145	C	5817.80	869.67	5.00	155.00	0.00	0.00	0.40			
146	C	5829.08	887.93	5.00	146.00	0.00	0.00	0.40			
147	C	5664.14	1020.75	5.00	200.00	0.00	0.00	0.40			
148	C	5655.15	1005.13	5.00	112.00	0.00	0.00	0.40			
149	C	5615.63	1259.86	5.00	221.00	0.00	0.00	0.40			
150	C	5617.48	1269.05	5.00	134.00	0.00	0.00	0.40			



## Horizontal Illuminance (lux)

Grid 1

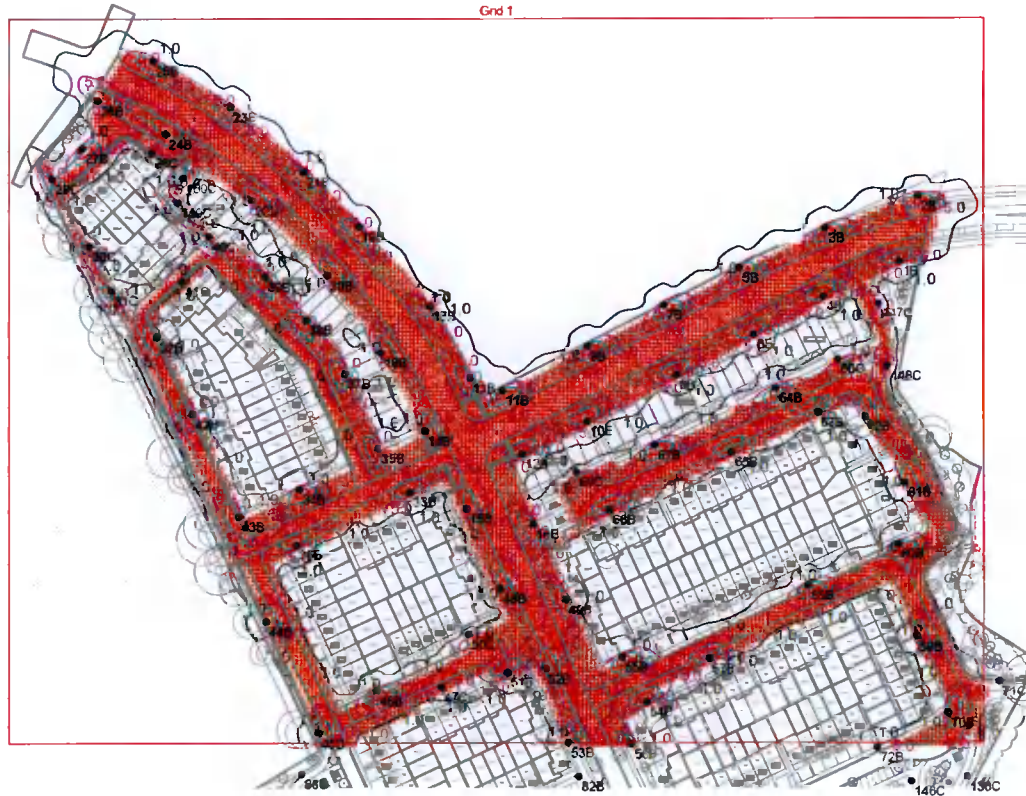

### Results

Eav	5.66
Emin	1.06
Emax	22.24
Emin/Emax	0.05
Emin/Eav	0.19

## Horizontal Illuminance (lux)

Grid 2

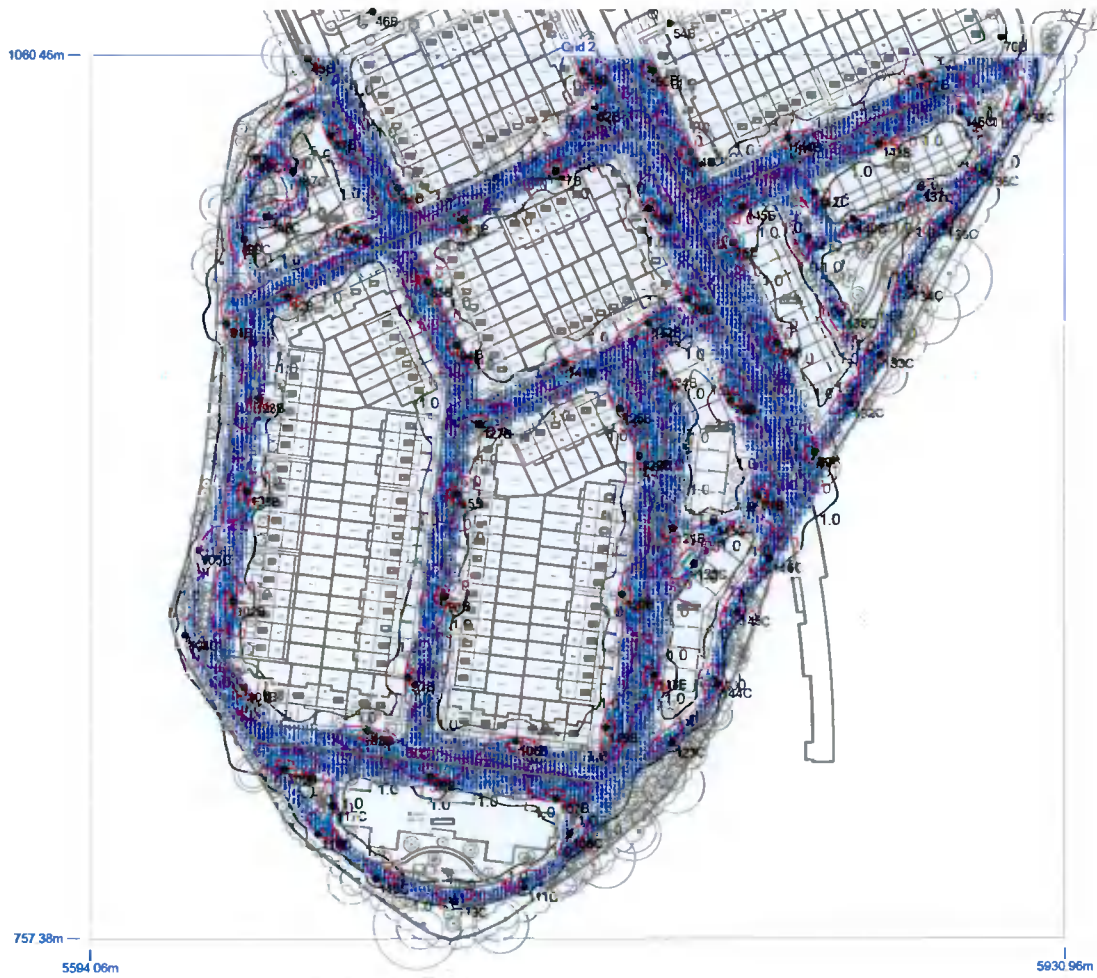

### Results

Eav	5.91
Emin	1.04
Emax	31.10
Emin/Emax	0.03
Emin/Eav	0.18