

**SERVICES LEGEND**

- PROPOSED SITE BOUNDARY
- CANAL SET BACK LINE
- PROPOSED PERMEABLE PAVING (PRIVATE)
- PROPOSED PERMEABLE PAVING (MANAGEMENT COMPANY)
- EXISTING SURFACE WATER SEWER
- TRUNK SURFACE WATER SEWER TO BE CONSTRUCTED AS PART OF THE CLONBURRIS SOUTHERN LINK ST [SD220A/0021]
- PROPOSED SURFACE WATER SEWER AND MANHOLE
- PROPOSED SURFACE WATER INSPECTION CHAMBER AND 150mmØ UPVC HOUSE DRAIN
- ROAD GULLY
- KERB INLET
- PROPOSED FILTER DRAIN WITH GRATED MANHOLE COVER (BRIO BY EJ OSA)
- PROPOSED SWALE WITH GRATED MANHOLE COVER (BRIO BY EJ OSA)
- DETENTION BASIN/POND
- BIORETENTION AREA
- EXISTING FOUL SEWER
- TRUNK FOUL SEWER TO BE CONSTRUCTED AS PART OF THE CLONBURRIS SOUTHERN LINK ST [SD220A/0021]
- PROPOSED FOUL SEWER AND MANHOLE
- PROPOSED FOUL WATER INSPECTION CHAMBER (STD-WW-13) AND HOUSE DRAIN
- EXISTING WATERMAIN
- PROPOSED LEVELS
- EXISTING LEVELS
- FINISHED FLOOR LEVEL
- ROAD GRADIENT

© COPYRIGHT OF THIS DRAWING IS RESERVED BY DBFL CONSULTING ENGINEERS. NO PART SHALL BE REPRODUCED OR TRANSMITTED WITHOUT THEIR WRITTEN PERMISSION.

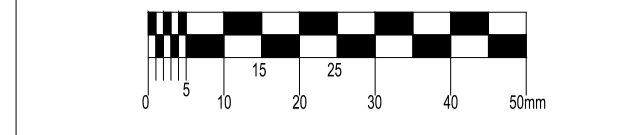

- NOTES:**
- ALL DRAWINGS TO BE CHECKED BY CONTRACTOR ON SITE AND ENGINEER INFORMED OF DISCREPANCIES BEFORE WORK COMMENCES.
  - THE CONTRACTOR SHALL SATISFY HIMSELF AS TO THE ACCURACY OF EXISTING DRAINAGE AND OUTFALL LEVELS AND LOCATION OF EXISTING SERVICES ON SITE PRIOR TO COMMENCEMENT OF WORKS ON SITE.
  - ALL DIMENSIONS AND LEVELS ARE IN METERS AND ARE RELATED TO ORDINANCE DATUM. CO-ORDINATES RELATE TO IRISH TRANSVERSE MERCATOR.
  - ALL FOUL SEWERS, MANHOLES AND CONNECTIONS TO BE CONSTRUCTED IN ACCORDANCE WITH IRISH WATER CODE OF PRACTICE FOR WASTEWATER INFRASTRUCTURE AND IRISH WATER WASTEWATER INFRASTRUCTURE STANDARD DETAILS.
  - ALL PUBLIC SURFACE WATER SEWERS TO BE IN ACCORDANCE WITH SOUTH DUBLIN COUNTY COUNCIL'S TAKING IN CHARGE POLICY AND THE GREATER DUBLIN REGIONAL CODE OF PRACTICE FOR DRAINAGE WORKS.
  - SURFACE WATER DRAINAGE STRATEGY TO BE IN ACCORDANCE WITH THE CLONBURRIS SURFACE WATER MANAGEMENT PLAN.
  - ALL COVER LEVELS TO MATCH FINISHED ROAD/VERGE/FOOTPATH/CYCLETRACK LEVELS UNLESS OTHERWISE STATED.
  - CONTRACTOR TO INCLUDE FOR TESTING AND CCTV SURVEY OF ALL SEWERS UPON COMPLETION OF SAME.
  - WHERE COVERS ARE LOCATED IN GRASS AREAS THEY SHALL BE SURROUNDED BY A CONCRETE PLINTH, 200MM ALL ROUND AND 100mm DEEP FORMED WITH C20/25 CONCRETE, 20mm AGGREGATE SIZE, BEDDED IN CLAUSE 808 MATERIAL.

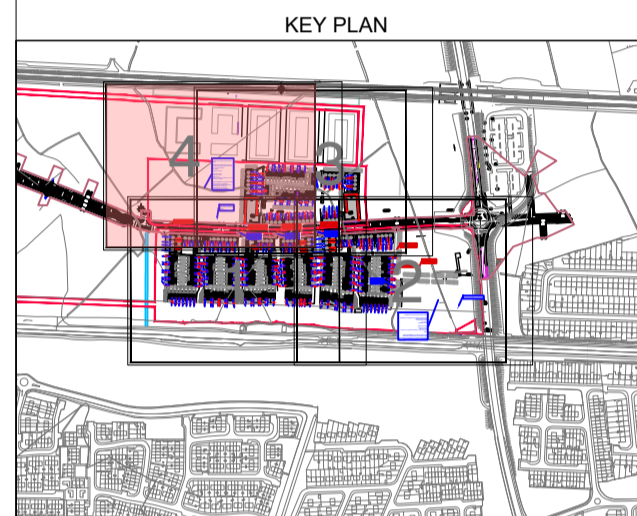

**ATTENUATION AREA 7: DETENTION BASIN. STORMTECH ATTENUATION WITH BASIN ABOVE**

STORMTECH ATTENUATION (30 YR AEP)  
 MC3500 SYSTEM TANK (MIN 0.45M COVER)  
 68m LONG X 100m WIDE  
 VOL: 6900m<sup>3</sup>  
 CHAMBER IL: 56.359

BASIN (100 YR AEP)  
 BASIN VOL: 3100m<sup>3</sup>  
 BASIN IL: 57.95  
 BASIN TWL: 58.364 (ACTIVE DEPTH: 0.414m)  
 TOTAL VOL: 10,000m<sup>3</sup>

MINOR AMENDMENTS TO PLAN FOOTPRINT FROM APPROVED CLONBURRIS SOUTHERN LINK STREET APPLICATION (REF SD220A/0021). GENERAL ARRANGEMENT AND VOLUMES MAINTAINED AS PER SD220A/0021

**FLOW CONTROL MANHOLE (HYDROBRAKE OPTIMUM OR SIMILAR)**  
 MaxQ= 102.55 l/s

NEW FOUL CONNECTION TO FOUL SEWER PROPOSED AS PART OF THE CLONBURRIS SOUTHERN LINK STREET WORKS. PLANNING REF SD220A/0021

NEW FOUL CONNECTION TO FUTURE FOUL SEWER TO BE CONSTRUCTED AS PART OF THE CLONBURRIS SOUTHERN LINK STREET WORKS. PLANNING REF SD220A/0021

NEW FOUL CONNECTION TO FUTURE FOUL SEWER TO BE CONSTRUCTED AS PART OF THE CLONBURRIS SOUTHERN LINK STREET WORKS. PLANNING REF SD220A/0021

NEW SURFACE WATER CONNECTION TO FUTURE SURFACE WATER SEWER TO BE CONSTRUCTED AS PART OF THE CLONBURRIS SOUTHERN LINK STREET WORKS. PLANNING REF SD220A/0021

NEW SURFACE WATER CONNECTION TO FUTURE SURFACE WATER SEWER TO BE CONSTRUCTED AS PART OF THE CLONBURRIS SOUTHERN LINK STREET WORKS. PLANNING REF SD220A/0021

ORDNANCE SURVEY IRELAND LICENCE  
 No EN 0017921  
 © ORDNANCE SURVEY IRELAND GOVERNMENT OF IRELAND

rev	date	description	DKE	JPC
P01	17-11-21	ISSUED FOR PLANNING		

**DBFL Consulting Engineers**  
 Civil, Structural & Transportation Engineering  
 www.dbfl.ie

DUBLIN OFFICE: Ormond House, Upper Ormond Quay, Dublin 7, Ireland.  
 PHONE: +353 (0)1 2024638  
 CORK OFFICE: Phoenix House, Monahan Road, Cork.  
 PHONE: +353 (0)21 2024638  
 WATERFORD OFFICE: 2nd Fl., The Chandlery, 1-2 O'Connell Street, Waterford, Ireland.  
 PHONE: +353 (0)51 309 500

client approval		issue purpose	
S2 - INFORMATION		PLANNING	
<p><b>CLONBURRIS PHASE 1A</b></p> <p>DRAINAGE LAYOUT - SHEET 4</p>			
<p>client</p> <p><b>CAIRN HOMES LTD</b></p>			
designed by	author	scale	sheet size
TCA	DKE	1:500	A1
drawing no.	revision		
162119-DBFL-CS-SP-DR-C-1304	P01		