

SERVICES LEGEND

	PROPOSED SITE BOUNDARY
	CANAL SET BACK LINE
	PROPOSED PERMEABLE PAVING (PRIVATE)
	PROPOSED PERMEABLE PAVING (MANAGEMENT COMPANY)
	EXISTING SURFACE WATER SEWER
	TRUNK SURFACE WATER SEWER TO BE CONSTRUCTED AS PART OF THE CLONBURRIS SOUTHERN LINK ST [SD220A/0021]
	PROPOSED SURFACE WATER SEWER AND MANHOLE
	PROPOSED SURFACE WATER INSPECTION CHAMBER AND 150mmØ UPVC HOUSE DRAIN
	ROAD GULLY
	KERB INLET
	PROPOSED FILTER DRAIN WITH GRATED MANHOLE COVER (BRO BY EJ OSA)
	PROPOSED SWALE WITH GRATED MANHOLE COVER (BRO BY EJ OSA)
	DETENTION BASIN/POND
	BIORETENTION AREA
	EXISTING FOUL SEWER
	TRUNK FOUL SEWER TO BE CONSTRUCTED AS PART OF THE CLONBURRIS SOUTHERN LINK ST [SD220A/0021]
	PROPOSED FOUL SEWER AND MANHOLE
	PROPOSED FOUL WATER INSPECTION CHAMBER (STD-WW-13) AND HOUSE DRAIN
	EXISTING WATERMAIN
	PROPOSED LEVELS
	EXISTING LEVELS
	FINISHED FLOOR LEVEL
	ROAD GRADIENT

© COPYRIGHT OF THIS DRAWING IS RESERVED BY DBFL CONSULTING ENGINEERS. NO PART SHALL BE REPRODUCED OR TRANSMITTED WITHOUT THEIR WRITTEN PERMISSION.

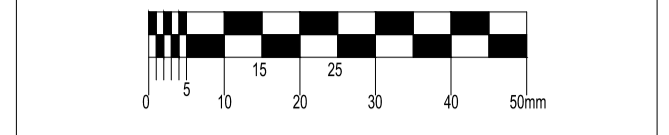

- NOTES:**
1. ALL DRAWINGS TO BE CHECKED BY CONTRACTOR ON SITE AND ENGINEER INFORMED OF DISCREPANCIES BEFORE WORK COMMENCES.
 2. THE CONTRACTOR SHALL SATISFY HIMSELF AS TO THE ACCURACY OF EXISTING DRAINAGE AND OUTFALL LEVELS AND LOCATION OF EXISTING SERVICES ON SITE PRIOR TO COMMENCEMENT OF WORKS ON SITE.
 3. ALL DIMENSIONS AND LEVELS ARE IN METERS AND ARE RELATED TO ORDNANCE DATUM. CO-ORDINATES RELATE TO IRISH TRANSVERSE MERCATOR.
 4. ALL FOUL SEWERS, MANHOLES AND CONNECTIONS TO BE CONSTRUCTED IN ACCORDANCE WITH IRISH WATER CODE OF PRACTICE FOR WASTEWATER INFRASTRUCTURE AND IRISH WATER WASTEWATER INFRASTRUCTURE STANDARD DETAILS.
 5. ALL PUBLIC SURFACE WATER SEWERS TO BE IN ACCORDANCE WITH SOUTH DUBLIN COUNTY COUNCIL'S TAKING IN CHARGE POLICY AND THE GREATER DUBLIN REGIONAL CODE OF PRACTICE FOR DRAINAGE WORKS.
 6. SURFACE WATER DRAINAGE STRATEGY TO BE IN ACCORDANCE WITH THE CLONBURRIS SURFACE WATER MANAGEMENT PLAN.
 7. ALL COVER LEVELS TO MATCH FINISHED ROAD/VERGE/FOOTPATH/BICYCLETRACK LEVELS UNLESS OTHERWISE STATED.
 8. CONTRACTOR TO INCLUDE FOR TESTING AND CCTV SURVEY OF ALL SEWERS UPON COMPLETION OF SAME.
 9. WHERE COVERS ARE LOCATED IN GRASS AREAS THEY SHALL BE SURROUNDED BY A CONCRETE PLINTH, 200MM ALL ROUND AND 100MM DEEP FORMED WITH C20/25 CONCRETE, 20mm AGGREGATE SIZE, BEDDED IN CLAUSE 808 MATERIAL.

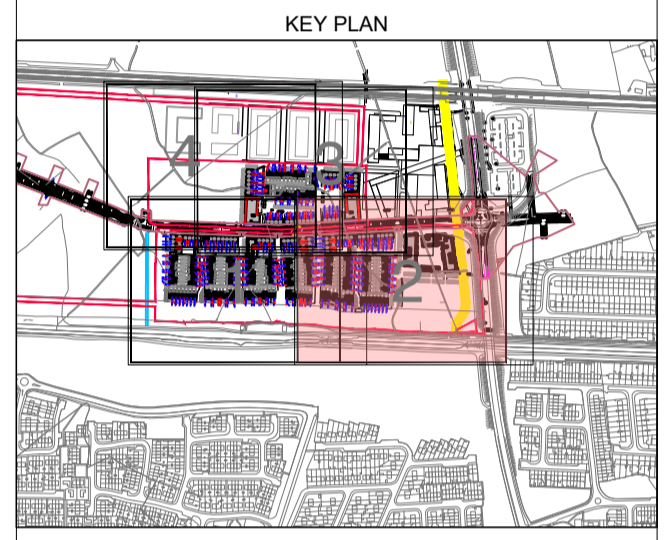

ORDNANCE SURVEY IRELAND LICENCE
No EN 0017921
© ORDNANCE SURVEY IRELAND GOVERNMENT OF IRELAND

ATTENUATION AREA 8: DETENTION BASIN.
STORMTECH ATTENUATION WITH BASIN ABOVE

STORMTECH ATTENUATION (30 YR AEP) MC3500 SYSTEM TANK (MIN 0.45M COVER)
82m LONG X 38m WIDE
VOL: 3140m³
CHAMBER IL: 55.509

BASIN (100 YR AEP)
BASIN VOL: 1350m³
BASIN IL: 57.099
BASIN TWL: 57.549 (ACTIVE DEPTH: 0.45m) TOTAL VOL: 4,490m³

MINOR AMENDMENTS TO PLAN FOOTPRINT FROM APPROVED CLONBURRIS SOUTHERN LINK STREET APPLICATION (REF SD220A/0021). GENERAL ARRANGEMENT AND VOLUMES MAINTAINED AS PER SD220A/0021

P01	17-11-21	ISSUED FOR PLANNING	DKE	JPC
rev	date	description	by	chkd.
		A - Approved		
		B - Approved with comments		
		C - Do not use		
client approval				
submittal		issue purpose		
S2 - INFORMATION		PLANNING		
DBFL Consulting Engineers Civil, Structural & Transportation Engineering www.dbfl.ie				
DUBLIN OFFICE: Ormond House, Upper Ormond Quay, Dublin 7, Ireland. PHONE: +353 (0) 1 400 4000				
CORK OFFICE: Phoenix House, Monahan Road, Cork. PHONE: +353 (0) 21 202 6338				
WATERFORD OFFICE: Unit 2, The Chandlery, 1-2 O'Connell Street, Waterford, Ireland. PHONE: +353 (0) 51 309 500				
project ref.	CLONBURRIS PHASE 1A			
drawing title	DRAINAGE LAYOUT - SHEET 2			
client	CAIRN HOMES LTD			
designed by	author	scale	sheet size	
TCA	DKE	1:500	A1	
drawing no.			revision	
162119-DBFL-CS-SP-DR-C-1302			P01	