

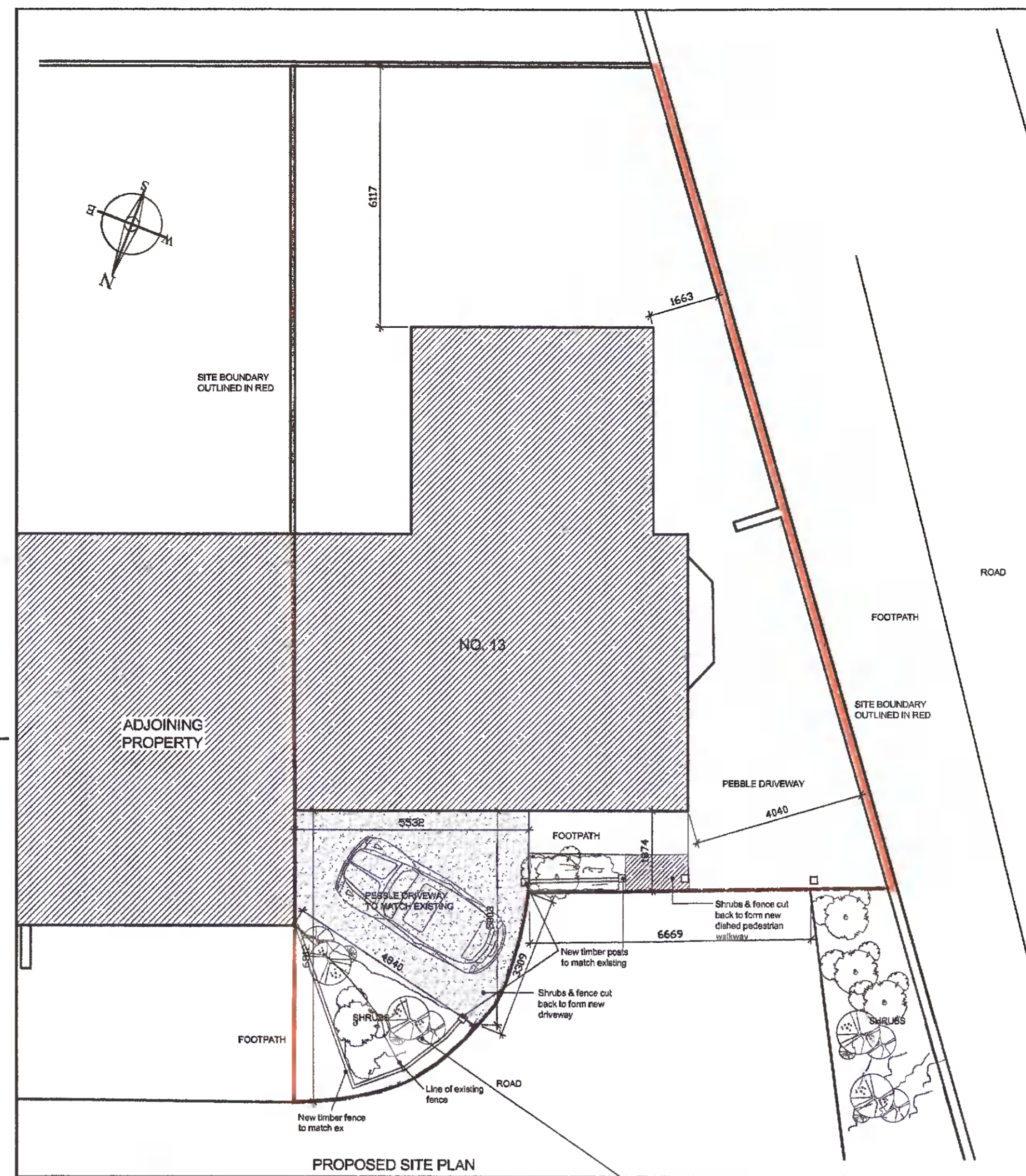

EXISTING NORTH ELEVATION



PROPOSED NORTH ELEVATION



PROPOSED SITE PLAN

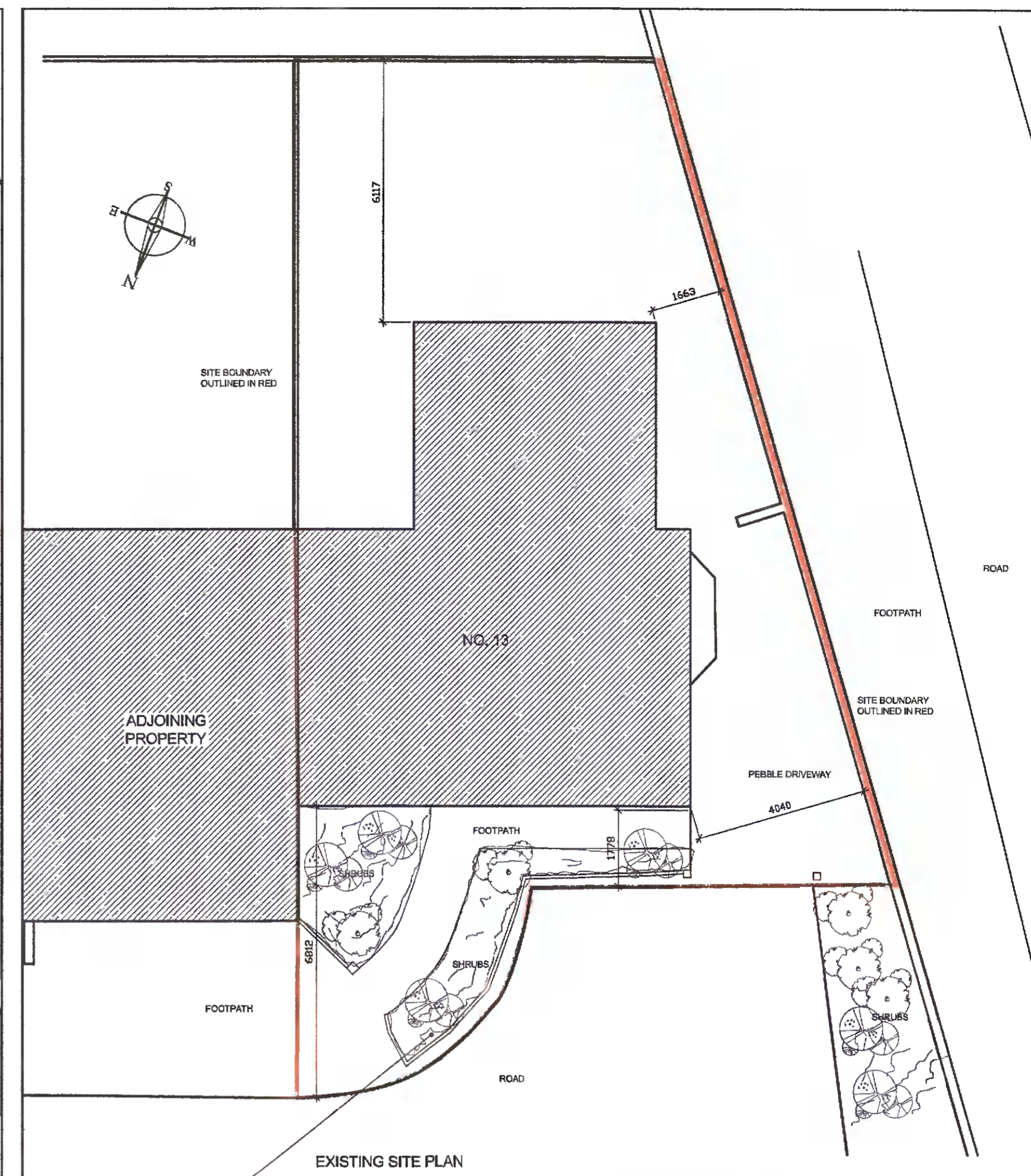

EXISTING SITE PLAN

NOTES:  
DO NOT SCALE FROM THIS DRAWING.  
ALL DIMENSIONS TO BE CHECKED ON SITE AND ANY DISCREPANCIES TO BE REPORTED IMMEDIATELY.  
CERTAIN ELEMENTS OF THE ORIGINAL SURVEY MAY HAVE BEEN ESTIMATED.  
DRAINAGE SHOWN MAY BE INDICATIVE AND SHOULD BE CHECKED ON SITE.  
THIS DRAWING IS TO BE READ IN CONJUNCTION WITH ALL OTHER RELEVANT DRAWINGS, SCHEDULES AND SPECIFICATIONS.  
THIS DRAWING IS FOR PLANNING PURPOSES ONLY AND MUST NOT BE USED FOR CONSTRUCTION.

Description:  
Digital Cartographic Model (DCM)  
Publisher / Source:  
Ordnance Survey Ireland (OS)  
Data Source / Reference:  
PRIME2  
File Format:  
Autodesk AutoCAD (DWG\_R2013)  
File Name:  
v\_50234788\_1.dwg  
Clip Extent / Area of Interest (ACI):  
LLX,LLY= 700349.6631,728349.1646  
LRX,LRX= 700582.6631,728399.1646  
ULX,ULY= 700349.6631,728351.1646  
URX,URY= 700582.6631,728351.1646  
Projection / Spatial Reference:  
Projection= IRENET95\_Irish\_Transverse\_Mercator  
Centre Point Coordinates:  
X,Y= 700466.1631,728445.1646  
Reference Index:  
Map Series | Map Sheets  
1:2,500 | 3388-A  
Data Extraction Date:  
Date: 22-Nov-2021  
Source Data Release:  
DCLMS Release V1.146.112  
Product Version:  
Version: 1.3  
License / Copyright:  
Ordnance Survey Ireland 'Terms of Use' apply. Please visit 'www.os.ie/about/terms-conditions'.

© Ordnance Survey Ireland, 2021  
Compiled and published by Ordnance Survey Ireland, Phoenix Park, Dublin 8, Ireland.  
Unauthorised reproduction infringes Ordnance Survey Ireland and Government of Ireland copyright.  
All rights reserved. No part of this publication may be copied, reproduced or transmitted in any form or by any means without the prior written permission of the copyright owners.  
The representation on this map of a road, track or footpath is not evidence of the existence of a right of way.  
Ordnance Survey maps never show legal property boundaries, nor do they show ownership of physical features.

© Suíbhéireacht Ordánáil Éireann, 2021  
Arna thionscnu agus arna thabairt ag Suíbhéireacht Ordánáil Éireann. Pláta an Fhionnuisce, Baile Ánna Cléib 8, Éire.  
Sábháilte arís gearrúchán na hOrdánáil Éireann agus na hÉireann.  
Gach cead ar coisneadh. Ní ceadúchán an chláir den fhionnuisce seo a chlopaíl, a athscrúduit nó a tharchur in aon form rú ar an bhfadhb gan ceadí scrúduit riamh nó ó úndair an chlopaíl.  
Ní Níonnán bóthar, bealach nó cosán a bhfuil ar an Merscáil seo agus fíneáse ar chéad st.  
Ní thabairtear mearcáil de chuid Ordánáil Éireann nó na hÉireann teoiric phointí dea-thúil de mhach niamh, ná úndaireacht de ghéarúchán fíneáil.

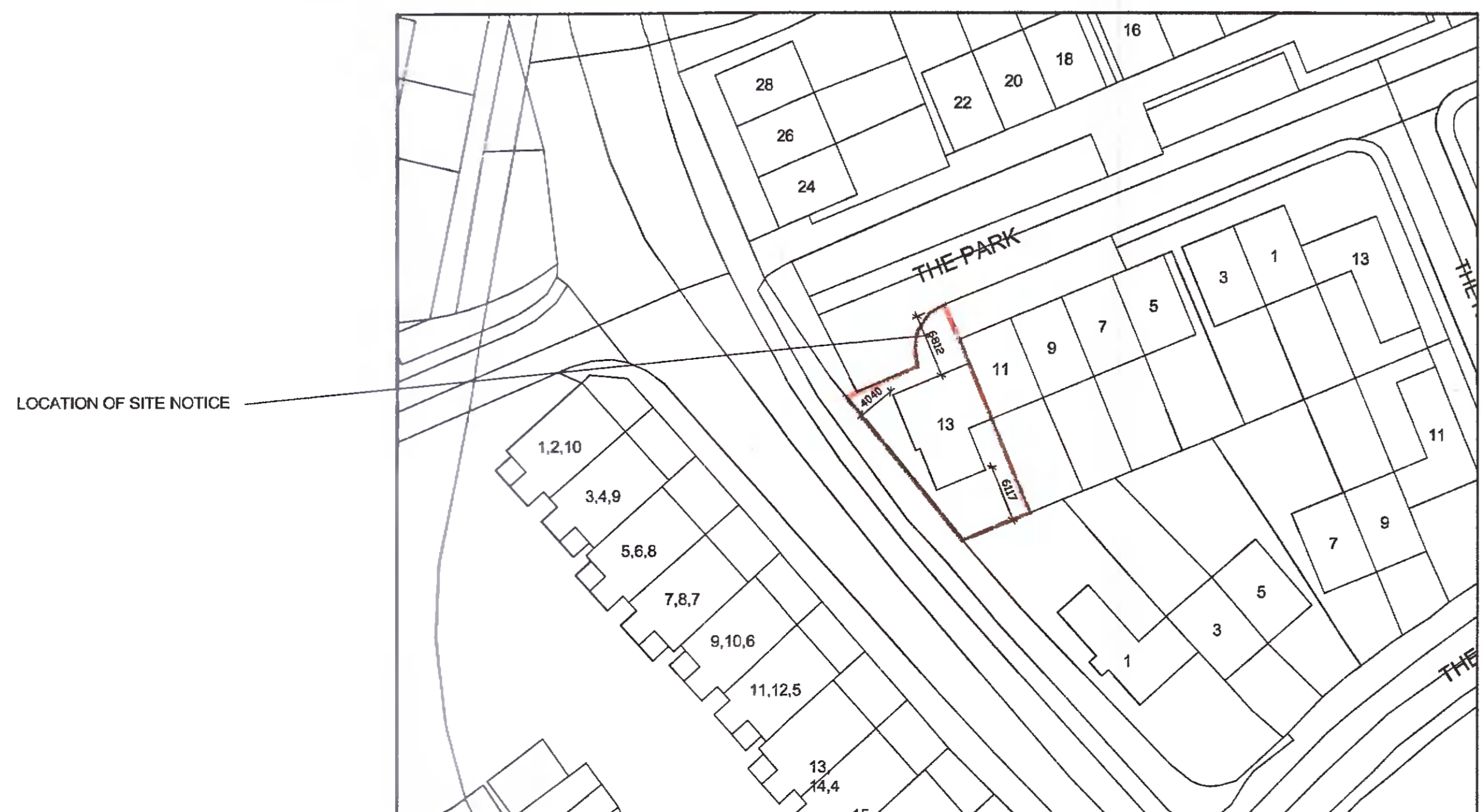

BLOCK PLAN - SCALE 1:500  
SEE NOTES OPPOSITE

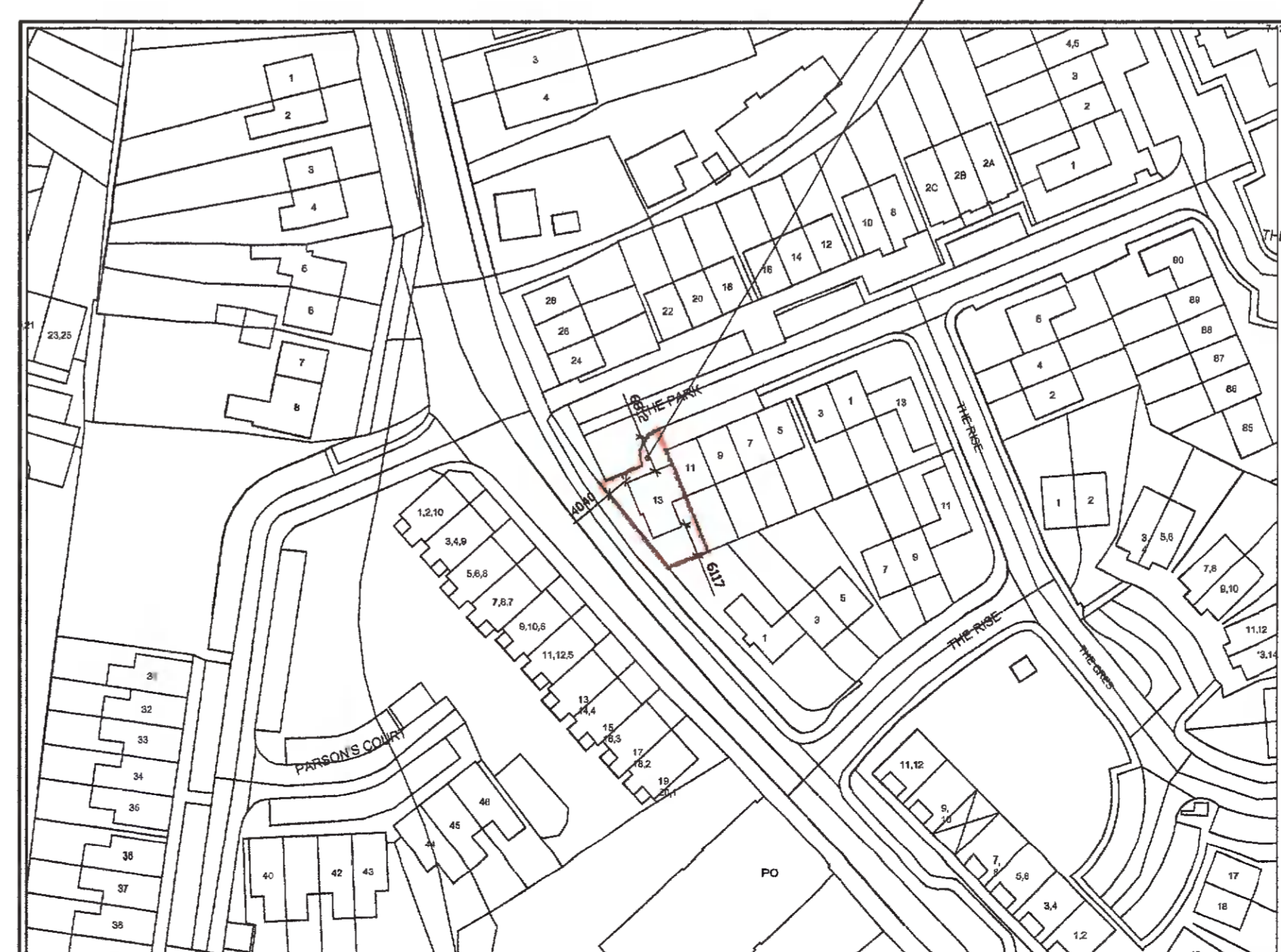

SITE LOCATION MAP - SCALE 1:1000  
SEE NOTES OPPOSITE

**www.DublinPlanning.ie**  
Architecture - Surveying - Project Management  
email: info@dublinplanning.com, phone: +353 87 6668016  
77 LOWER CAMDEN STREET, ST. KEVINS, DUBLIN 2.

ISSUED FOR PLANNING PURPOSES ONLY	
client	MR. GERARD HOLOHAN 13 NEWCASTLE MANOR PARK NEWCASTLE, CO DUBLIN
drawn	PETER KAVANAGH
drawing	PLANS, ELEVATIONS, SITE LOCATION MAP BLOCK PLAN.
description	PROPOSE NEW DRIVEWAY TO FRONT OF EXISTING HOUSE
scale	1:100 & AS SHOWN
date	10.12.21
dwg. no.	P-01

THIS DRAWING IS COPYRIGHT & THE PROPERTY OF DUBLIN PLANNING & MUST NOT BE COPIED, ALTERED OR COMMUNICATED TO A THIRD PARTY WITHOUT WRITTEN AUTHORIZATION.