

# S I T E L O C A T I O N M A P

## LEGEND :

- SITE BOUNDARY OF PLANNING APPLICATION
- SITE AREA IN SOUTH DUBLIN CO.CO. OWNERSHIP
- ADJACENT LANDS IN APPLICANT'S OWNERSHIP

## GENERAL NOTES

THIS DRAWING TO BE READ IN CONJUNCTION WITH ARCHITECT'S DRAWINGS, CONSULTANT ENGINEER'S DRAWINGS AND SPECIFICATIONS, AND LANDSCAPE ARCHITECT'S DRAWINGS AND SPECIFICATIONS & ARBORIST REPORT

LEVELS ARE ALL GIVEN IN RELATION TO LANDSURVEYOR'S BENCHMARK BASED ON MALIN HEAD DATUM LEVEL.

Reproduced under Licence No. CYAL50171770  
 Copyright Ordnance Survey Ireland.  
 O.S. Map Ref.: 3195-23 3261-04 3261-03  
 3195-D

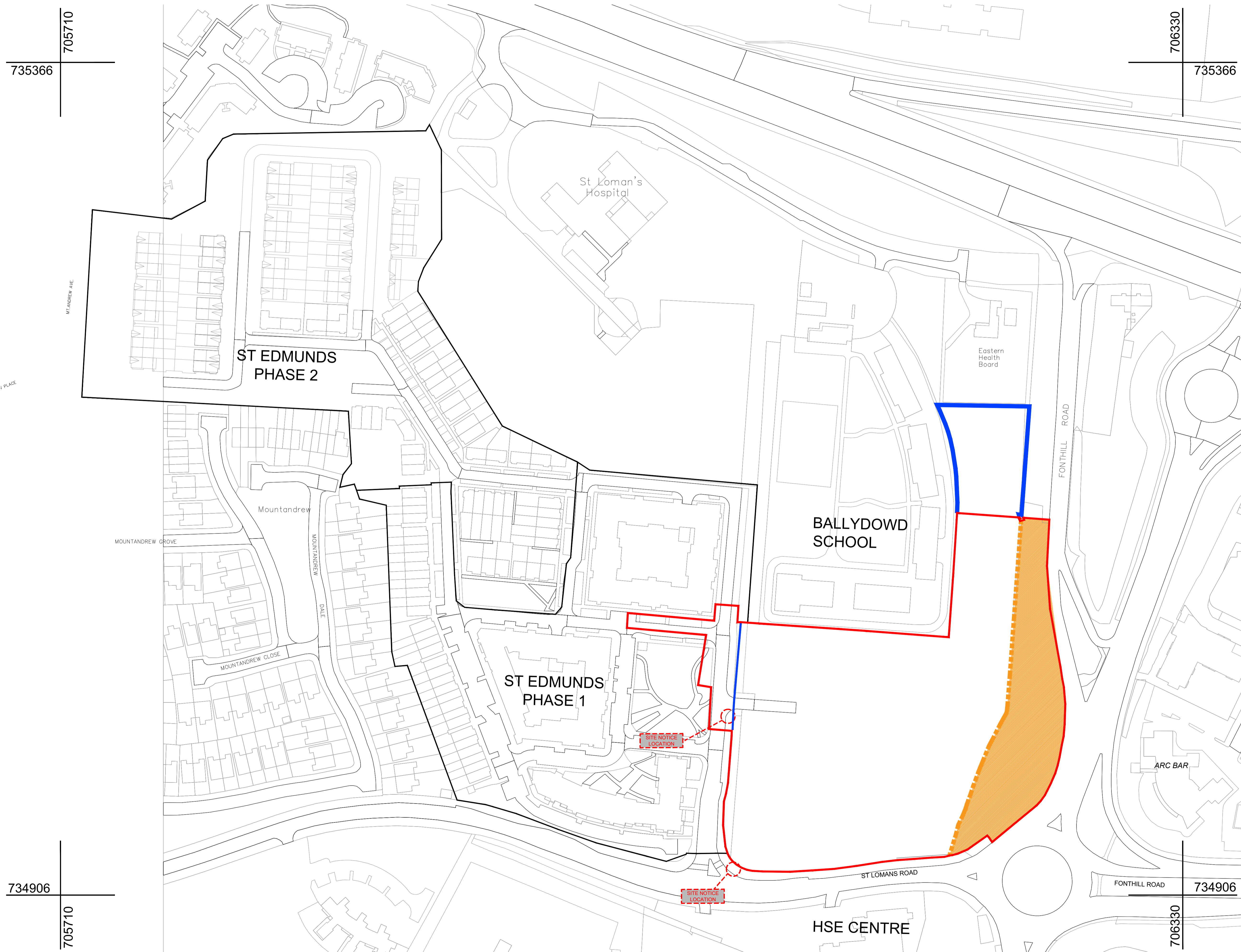

**NOTES:**  
 DO NOT SCALE FROM DRAWINGS. WORK TO FIGURED DIMENSIONS ONLY. ARCHITECT TO BE NOTIFIED OF ALL DISCREPANCIES.

**PLANNING APPLICATION**

REVISIONS		
DATE	DESCRIPTION	No.

**M C O R M**

MR CROSSAN O'ROURKE MANNING ARCHITECTS

PROJECT TITLE: <b>ST. EDMUNDS- PHASE 3 AMENDMENTS</b>	DATE: <b>NOV'21</b>	DRAWN BY: <b>MS</b>
DRAWING TITLE: <b>SITE LOCATION MAP</b>	SCALE: <b>1:1000</b>	REVISION: 
JOB NO: <b>18025.1</b>	DRAWING NO: <b>PL01</b>	
Albert Place West, Harcourt Lane, Dublin 2, Ireland. Tel: 01-4782700 Fax: 01-4782711 Email: mcm@mcm.com		