

SITE LOCATION MAP

LEGEND :

- SITE BOUNDARY OF PLANNING APPLICATION
- SITE AREA IN SOUTH DUBLIN CO.CO. OWNERSHIP
- ADJACENT LANDS IN APPLICANT'S OWNERSHIP

GENERAL NOTES

THIS DRAWING TO BE READ IN CONJUNCTION WITH ARCHITECT'S DRAWINGS, CONSULTANT ENGINEER'S DRAWINGS AND SPECIFICATIONS, AND LANDSCAPE ARCHITECT'S DRAWINGS AND SPECIFICATIONS & ARBORIST REPORT

LEVELS ARE ALL GIVEN IN RELATION TO LANDSURVEYOR'S BENCHMARK BASED ON MALIN HEAD DATUM LEVEL.

License No. AR0050119

Description:
Digital Cartographic Model (DCM)

Publisher / Source:
Ordnance Survey Ireland (OSi)

Data Source / Reference:
PRIME2

File Format:
Autodesk AutoCAD (DWG_R2013)

File Name:
v_50052448_1.dwg

Clip Extent / Area of Interest (AOI):
LLX,LLY= 705710,734906
LRX,LY= 706330, 734906
ULX,ULY= 705710, 735366
URX,URY= 706330, 735366
Projection / Spatial Reference:
Projection= IRENET95_Irish_Transverse_Mercator

Centre Point Coordinates:
X,Y= 706181.7936,735103.6509

Reference Index:
Map Series | Map Sheets
1:1,000 | 3195-23
1:1,000 | 3261-04
1:1,000 | 3261-03
1:2,500 | 3195-D

Data Extraction Date:
Date= 15-Mar-2019

Source Data Release:
DCLMS Release V1.115.104

Product Version:
Version= 1.3

License / Copyright:
Ordnance Survey Ireland 'Terms of Use' apply.
Please visit www.osi.ie/about/terms-conditions.

© Ordnance Survey Ireland, 2019

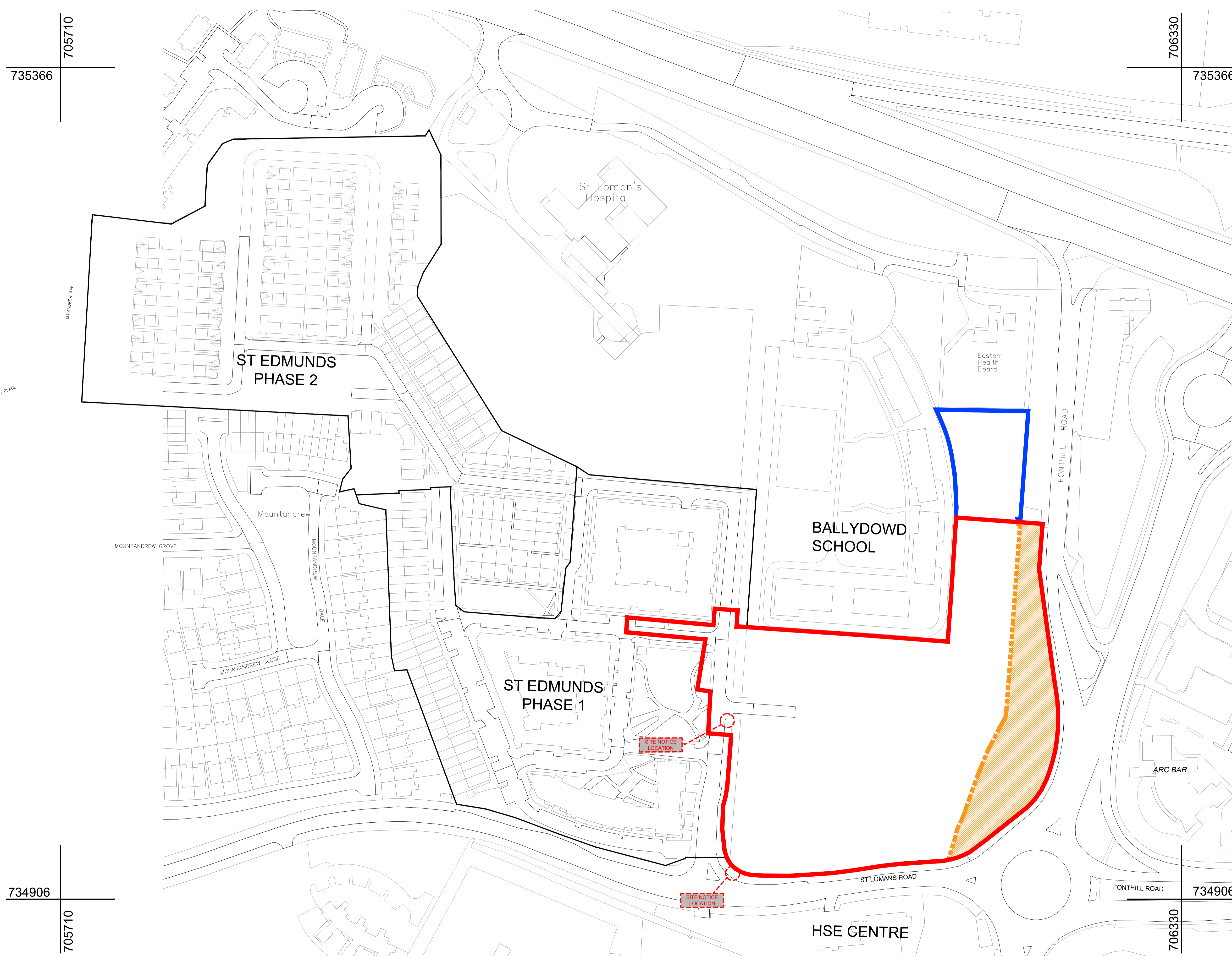

705710
735366

706330
735366

734906
705710

706330
734906

NOTES:

DO NOT SCALE FROM DRAWINGS. WORK TO FIGURED DIMENSIONS ONLY. ARCHITECT TO BE NOTIFIED OF ALL DISCREPANCIES.

PERMITTED

REVISIONS		
DATE	DESCRIPTION	No.



PROJECT TITLE: ST. EDMUNDS- PHASE 3	DATE: Nov'19	DRAWN BY: MS
DRAWING TITLE: SITE LOCATION MAP	SCALE: 1:1000	REVISION:
JOB NO: 18025	DRAWING NO: AP01	