

LEGEND	
PROPOSED FOOTPATH	
PROPOSED ROAD	
CENTRELINE	

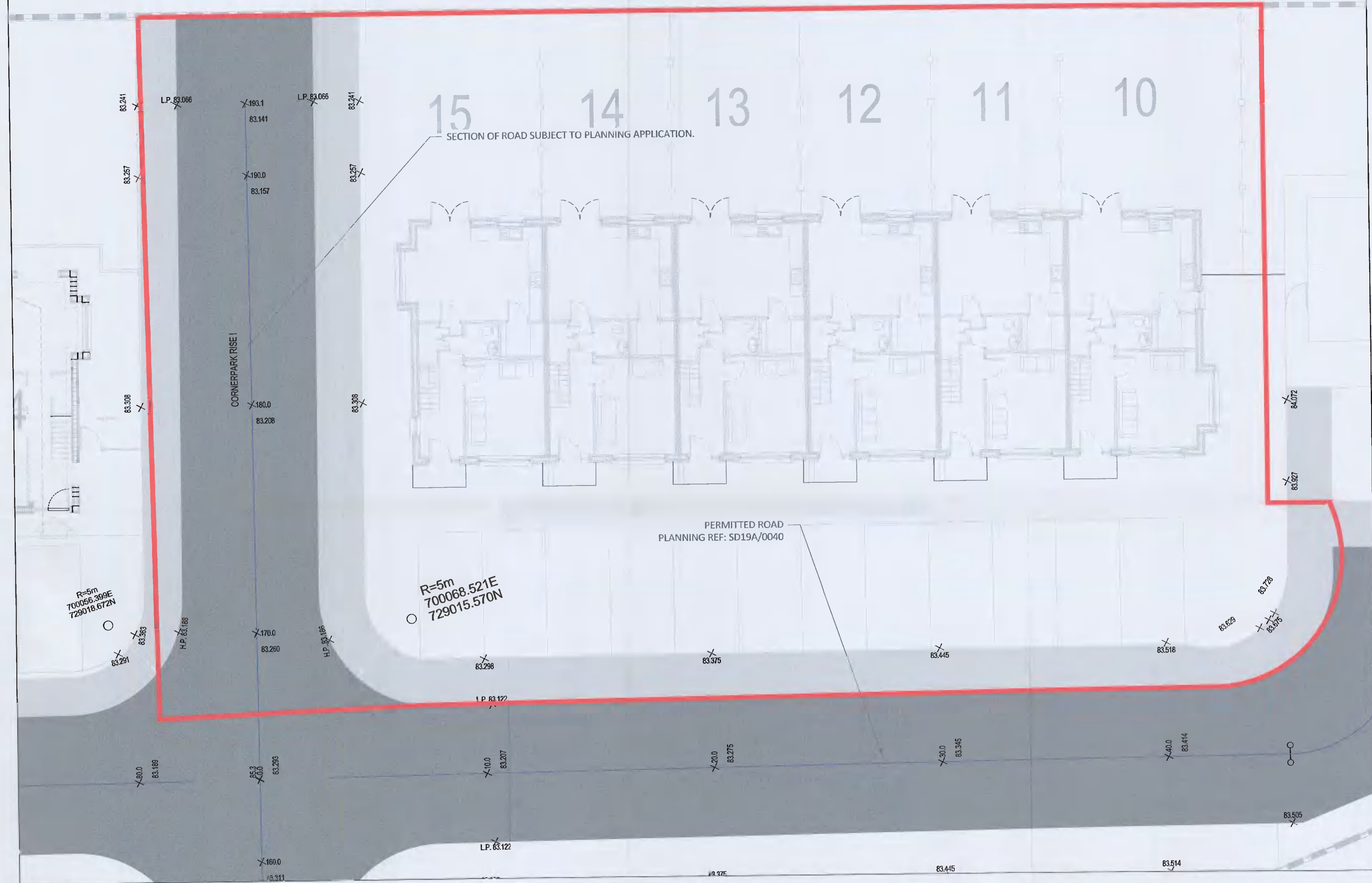

PLANNING DRAWING.
 NOT FOR CONSTRUCTION.
 ALL LEVELS GIVEN ARE
 RELATIVE TO ORDNANCE DATUM.
 THIS DRAWING HAS BEEN ISSUED FOR INFORMATION
 PURPOSES ONLY AND MUST NOT BE USED
 FOR CONSTRUCTION UNDER ANY CIRCUMSTANCES

ORDNANCE SURVEY OF IRELAND LICENCE NO. EN0000821 © GOVERNMENT OF IRELAND

- FOR SETTING OUT REFER TO ARCHITECT'S DRAWINGS.
- THIS DRAWING TO BE READ IN CONJUNCTION WITH ALL OTHER ARCHITECTURAL AND ENGINEERING DRAWINGS AND ALL OTHER RELEVANT DRAWINGS AND SPECIFICATIONS.
- DO NOT SCALE THIS DRAWING. USE FIGURED DIMENSIONS ONLY.
- NO PART OF THIS DOCUMENT MAY BE REPRODUCED OR TRANSMITTED IN ANY FORM OR STORED IN ANY RETRIEVAL SYSTEM OF ANY NATURE WITHOUT THE WRITTEN PERMISSION OF O'CONNOR SUTTON CRONIN AS COPYRIGHT HOLDER EXCEPT AS AGREED FOR USE ON THE PROJECT FOR WHICH THE DOCUMENT WAS ORIGINALLY ISSUED.

Rev No.	Date	Revision Note	Drn by	Chkd by	Rev No.	Date	Revision Note	Drn by	Chkd by
COL	22.11.21	ISSUED FOR PLANNING	QA	NMM					
CD	06.12.21	REVISED DUE TO CHANGE TO BOUNDARY LINE	QA	NMM					

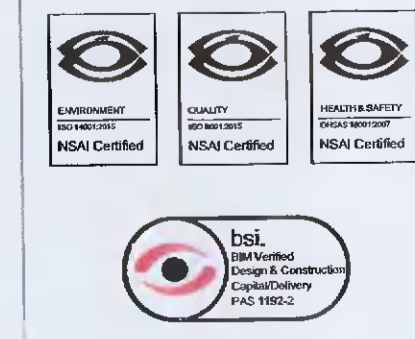

Head Office,
 9 Prussia Street,
 Dublin 7,
 D07KT57

TEL +353 (0)1 8682000
 e: contactus@ocsc.ie
 w: www.ocsc.ie

Dublin | London | Belfast | Galway | Cork | Birmingham

Client: Alanna Homes
 Project: Residential Development at
 Cornerpark, Newcastle Co Dublin
 Title: Phase 2
 Proposed Road Layout and Levels

Code | Originator | Zone | Level | Type | Role | Number | Status | Revision
 A611 | OCSC | XX | XX | DR | C | 0700 | A4 | C02

Date: 22.11.21 Scale: 1:100 @ A1 Drn by: QA Chkd by: NMM Aprvd by: BH