

GENERAL DRAINAGE NOTES

- 1 ALL DRAINAGE CONSTRUCTION WORKS TO BE CARRIED OUT IN ACCORDANCE WITH RELEVANT CODES OF PRACTICE, EPA AND DUBLIN COUNCIL REGULATIONS.
- 2 ADOPTED DRAINAGE TO BE INSTALLED TO THE APPROVAL OF IRISH WATER REQUIREMENTS / INSPECTOR
- 3 ALL PRIVATE BUILDING & CAR PARK DRAINAGE TO BE CONSTRUCTED IN ACCORDANCE WITH BS EN 752-4 DRAINS AND SEWER SYSTEMS OUTSIDE BUILDINGS IN ACCORDANCE WITH SCOTTISH BUILDING STANDARD REGULATIONS LAST EDITION TO THE APPROVAL OF BUILDING CONTROL INSPECTOR.
- 4 THIS DRAWING IS TO BE READ IN CONJUNCTION WITH ALL RELEVANT ARCHITECTS, ENGINEERS & SPECIALIST DRAWINGS AND SPECIFICATIONS.
- 5 ALL DIMENSIONS AND LEVELS ARE SHOWN IN METERS UNLESS NOTED OTHERWISE.
- 6 ANY DISCREPANCIES NOTED ON SITE ARE TO BE REPORTED TO THE SITE ENGINEER IMMEDIATELY.
- 7 PRIOR TO THE COMMENCEMENT OF ANY CONSTRUCTION WORKS ON SITE, THE CONTRACTOR MUST VERIFY THE LOCATION AND LEVEL OF ALL EXISTING DRAINAGE AFFECTED BY THE NEW WORKS AND CONFIRM HIS ACCEPTANCE OR OTHERWISE THE INFORMATION SHOWN ON THE DRAWINGS.
- 8 EXISTING DRAINAGE ROUTES INDICATED ON THIS DRAWING ARE INDICATIVE ONLY, EXACT LOCATION TO BE DETERMINED ON SITE. UNCHARTED SERVICES MAY EXIST IN THIS AREA.
- 9 THE LOCATION & LEVEL OF EXISTING SERVICES ARE TO BE VERIFIED ON SITE. ALL EXCAVATION IN THE VICINITY OF EXISTING SERVICES TO BE HAND DIG.
- 10 FOR SETTING OUT OF SOIL STACKS & RAINWATER PIPES REFER TO ARCHITECTS DRAWING. LOCATIONS SHOWN ARE INDICATIVE ONLY. REFER TO M&E DRAWINGS FOR DESIGN FLOW RATES.
- 11 ALL PIPES THAT PASS THROUGH A FOUNDATION OR TIE BEAM TO BE SLEEVED AND BACKFILLED WITH COMPRESSIBLE MATERIAL.
- 12 ALL PIPES THAT PASS BELOW A FOUNDATION OR TIE BEAM, THE TRENCH TO BE BACKFILLED WITH MASS CONCRETE AND PIPE SURROUNDED WITH 50mm COMPRESSIBLE MATERIAL WITH ROCKER PIPES TO BE PROVIDED ON BOTH SIDES OF THE CROSSING (CLOSE AS PRACTICAL TO THE FOUNDATION).
- 13 ALL GULLY CONNECTIONS TO BE 150mm DIAMETER AT 1:100 MIN. GRADIENT UNLESS NOTED OTHERWISE.
- 14 ROOT PROTECTION REQUIRED TO DRAINAGE RUNS WHICH ARE WITHIN 5 METERS OF TREE LOCATIONS.
- 15 AT PIPE CROSSOVERS, ROCKER PIPES ARE REQUIRED BOTH SIDES OF THE CROSSING ON EACH PIPELINE.
- 16 WHERE CLEARANCE IS LESS THAN 150mm BETWEEN SURFACE AND FOUL WATER PIPE LINE CROSS OVER A SUITABLE COMPRESSIBLE MATERIAL SHALL BE USED.
- 17 ALL DRAINAGE CONNECTIONS BELOW THE BUILDING FOOTPRINT TO BE 150mm DIAMETER. ALL CONNECTIONS TO BE LAID AT 1:40 MIN. WITH 45° BEND INTO MAIN CARRIER PIPE (UNLESS NOTED OTHERWISE).
- 18 ALL DRAINAGE CONNECTIONS BELOW ROADS AND TRAFFICKED AREAS TO BE 150mm DIAMETER WITH 45° BEND INTO MAIN CARRIER PIPE.
- 19 THE SURVEY CO-ORDINATES SHOWN ARE RELATIVE TO A CREWMAN DATUM. THE SURVEY INFORMATION IS ORIENTATED TO NORTH.
- 20 EXISTING DRAINAGE INFORMATION INDICATED ON THIS DRAWING OUT WITH IS BASED ON IRISH WATER GIS RECORD PLANS.

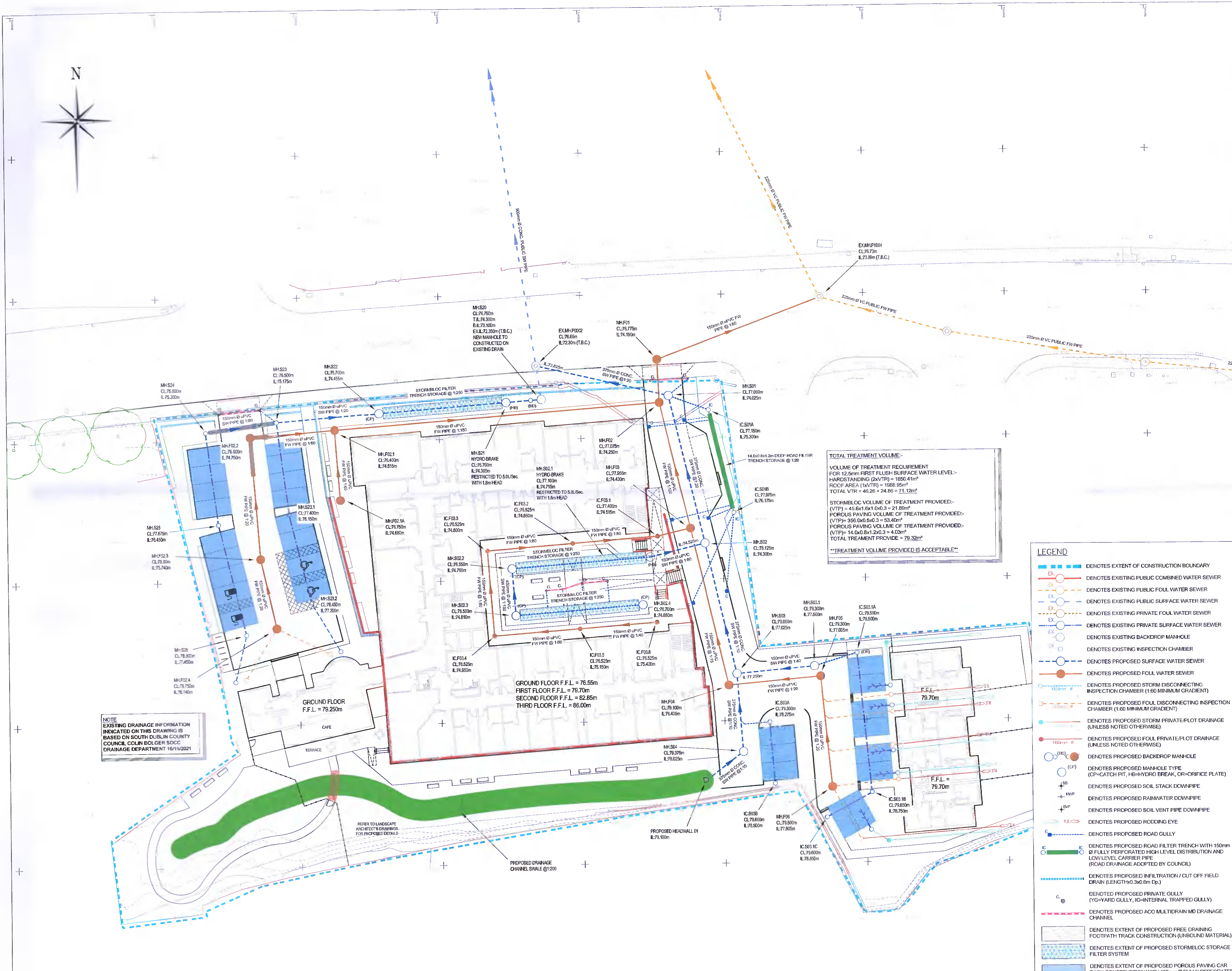

TOTAL TREATMENT VOLUME:-
 VOLUME OF TREATMENT REQUIREMENT FOR 12.5mm FIRST FLUSH SURFACE WATER LEVEL - HARDSTANDING (2xVTR) = 1850.41m³
 ROOF AREA (1st VTR) = 1888.55m²
 TOTAL VTR = 46.26 + 24.86 = 71.12m³
 STORMWATER VOLUME OF TREATMENT PROVIDED:- (VTP) = 45.6x1.6x1.0x0.3 = 21.89m³
 POROUS PAVING VOLUME OF TREATMENT PROVIDED:- (VTP) = 356.0x0.6x0.3 = 63.40m³
 TOTAL TREATMENT PROVIDED = 21.89 + 63.40 = 85.29m³
 TREATMENT VOLUME PROVIDED IS ACCEPTABLE

NOTE
 EXISTING DRAINAGE INFORMATION INDICATED ON THIS DRAWING IS BASED ON SOUTH DUBLIN COUNTY COUNCIL COLIN BOLGER SOCC DRAINAGE DEPARTMENT 16/11/2021

LEGEND

- DENOTES EXTENT OF CONSTRUCTION BOUNDARY
- DENOTES EXISTING PUBLIC COMBINED WATER SEWER
- DENOTES EXISTING PUBLIC FOUL WATER SEWER
- DENOTES EXISTING PUBLIC SURFACE WATER SEWER
- DENOTES EXISTING PRIVATE FOUL WATER SEWER
- DENOTES EXISTING PRIVATE SURFACE WATER SEWER
- DENOTES EXISTING BACKDROP MANHOLE
- DENOTES EXISTING INSPECTION CHAMBER
- DENOTES EXISTING SURFACE WATER SEWER
- DENOTES PROPOSED FOUL WATER SEWER
- DENOTES PROPOSED STORM DISCONNECTING INSPECTION CHAMBER (1:60 MINIMUM GRADIENT)
- DENOTES PROPOSED FOUL DISCONNECTING INSPECTION CHAMBER (1:60 MINIMUM GRADIENT)
- DENOTES PROPOSED STORM PRIVATE PLOT DRAINAGE (UNLESS NOTED OTHERWISE)
- DENOTES PROPOSED FOUL PRIVATE PLOT DRAINAGE (UNLESS NOTED OTHERWISE)
- DENOTES PROPOSED BACKDROP MANHOLE
- DENOTES PROPOSED MANHOLE TYPE (CP=CATCH PIT, HB=HYDRO BREAK, OR=ORIFICE PLATE)
- DENOTES PROPOSED SOIL STACK DOWNPIPE
- DENOTES PROPOSED RAINWATER DOWNPIPE
- DENOTES PROPOSED SOIL VENT PIPE DOWNPIPE
- DENOTES PROPOSED RODDING EYE
- DENOTES PROPOSED ROAD GULLY
- DENOTES PROPOSED ROAD FILTER TRENCH WITH 150mm Ø FULLY PERFORATED HIGH LEVEL DISTRIBUTION AND LOW LEVEL CARRIER PIPE (ROAD DRAINAGE ADOPTED BY COUNCIL)
- DENOTES PROPOSED INFILTRATION / CUT OFF FIELD DRAIN (LENGTH=0.3x0.6m Dp)
- DENOTES PROPOSED PRIVATE GULLY (YG-YARD GULLY, IG-INTERNAL TRAPPED GULLY)
- DENOTES PROPOSED ACO MULTIDRAIN MID DRAINAGE CHANNEL
- DENOTES EXTENT OF PROPOSED FREE DRAINING FOOTPATH TRACK CONSTRUCTION (UNBOUND MATERIAL)
- DENOTES EXTENT OF PROPOSED STORMWATER STORAGE FILTER SYSTEM
- DENOTES EXTENT OF PROPOSED POROUS PAVING CAR PARK CONSTRUCTION WITH 150mm Ø FULLY PERFORATED PIPEWORK TRENCH
- DENOTES EXTENT OF PROPOSED PIPEWORK 150mm THK ST1 CONCRETE SURROUND/PROTECTION SLAB

Morrison Community Care Group

Residential Care Home
 Taylors Lane, Rathfamham
 Dublin

Proposed Underground
 Drainage Layout

Scale at A1: 1:250
 Date: Nov, 2021
 Drawn: G.R.Porch
 Approved: G.R.Porch

Cowal Design Consultants
 Civil & Structural Engineering + Development Services
 Duncorn - 01359 707 652 Glasgow - 0141 406 1688
 London - 020 3855 8144 Chan-01631 571 260
 WEB-www.cowaldesign.co.uk
 Email-info@cowaldesign.co.uk

Planning
 Drawing No: 21-3406-C-032