

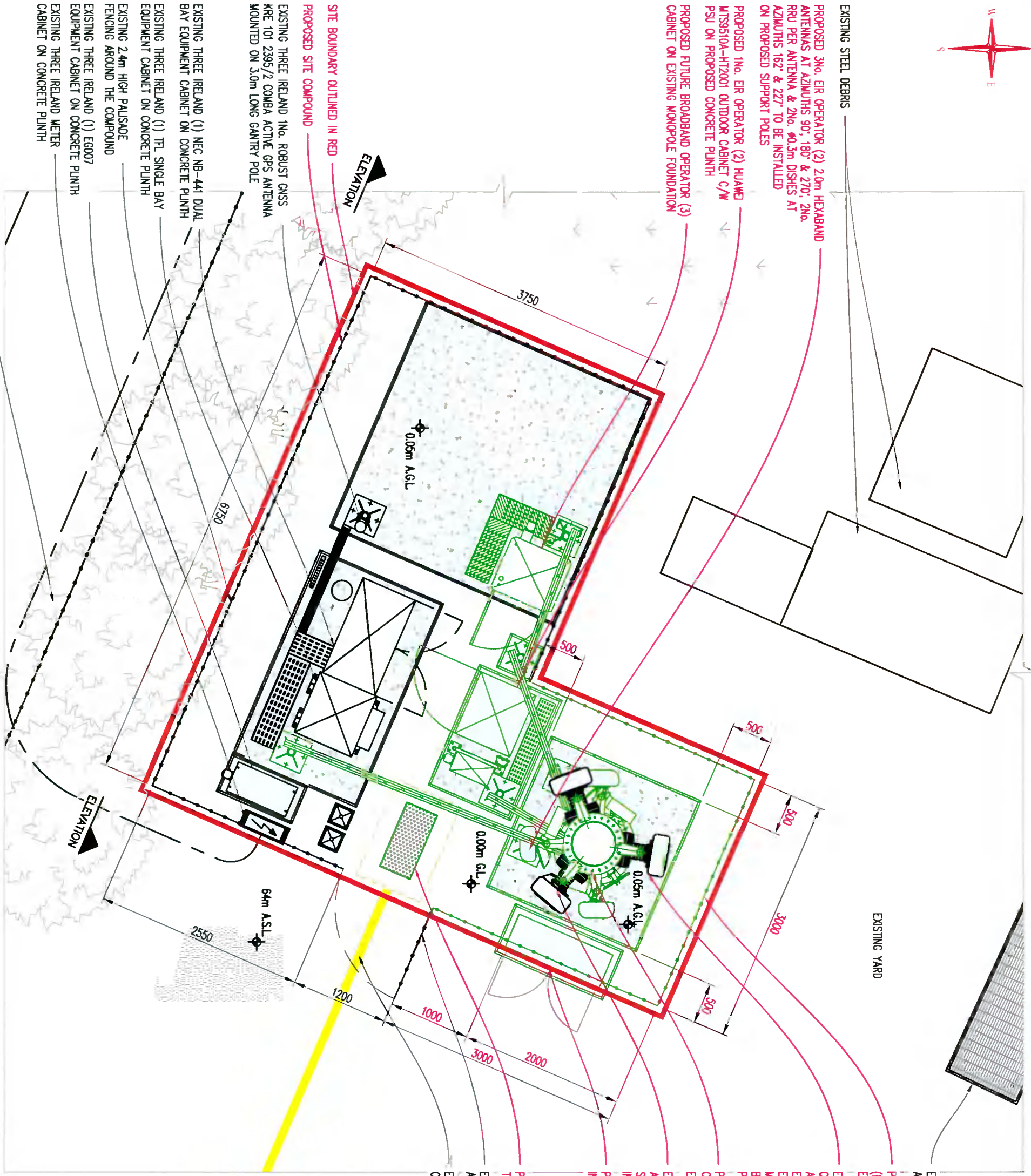

NOTE:
DISH HEIGHT AND AZIMUTH TO BE CONFIRMED FOLLOWING FULL LINE OF SITE SURVEY

- GENERAL NOTES**
1. Do not scale.
 2. All dimensions to be in mm unless specified otherwise.
 3. This drawing read in conjunction with the relevant scope of works and all relevant engineering and specialist drawings.
 4. All works to be in accordance with the relevant and current health and safety legislation.
 5. Specification of the works to be to the appropriate Irish standard or the equivalent British standard.
 6. All works to be carried out in strict accordance with project specifications.



EXISTING STEEL DEBRIS

PROPOSED 3No. EIR OPERATOR (2) 2.0m HEXABAND ANTENNAS AT AZIMUTHS 90°, 180° & 270°. 2No. RRU PER ANTENNA & 2No. #0.3m DISHES AT AZIMUTHS 162° & 227° TO BE INSTALLED ON PROPOSED SUPPORT POLES

PROPOSED 1No. EIR OPERATOR (2) HUAWAI MTS9610A-H12001 OUTDOOR CABINET C/W PSU ON PROPOSED CONCRETE PLINTH

PROPOSED FUTURE BROADBAND OPERATOR (3) CABINET ON EXISTING MONOPOLE FOUNDATION

SITE BOUNDARY OUTLINED IN RED

PROPOSED SITE COMPOUND

EXISTING THREE IRELAND 1No. ROBUST GNSS RRE 10T 2395/2 COMBA ACTIVE GPS ANTENNA MOUNTED ON 3.0m LONG GANTRY POLE

EXISTING THREE IRELAND (1) NEC NB-444 DUAL BAY EQUIPMENT CABINET ON CONCRETE PLINTH

EXISTING THREE IRELAND (1) TFL SINGLE BAY EQUIPMENT CABINET ON CONCRETE PLINTH

EXISTING 2.4m HIGH PALISADE FENCING AROUND THE COMPOUND

EXISTING THREE IRELAND (1) EG007 EQUIPMENT CABINET ON CONCRETE PLINTH

EXISTING THREE IRELAND METER CABINET ON CONCRETE PLINTH

EXISTING BOUNDARY WALL

EXISTING DRAIN SYSTEM CHAMBER APPROX. 3m DEEP

PROPOSED 2.4m HIGH PALISADE FENCING (POWDER COATED BLUE) AROUND THE EXTENDED COMPOUND

EXISTING 3No. THREE IRELAND (1) COMASSCOPE RRY4-65A-R6 ANTENNAS AT AZIMUTHS 10°, 130° & 250°. 1No. ERICSSON 2238 L8 PER ANTENNA & 1No. ERICSSON 4480 L18 PER ANTENNA MOUNTED ON EXISTING SUPPORT POLE TO BE RELOCATED & INSTALLED ON PROPOSED SUPPORT POLES

PROPOSED 21m MULTI USER MONOPOLE CARRYING TELECOMMUNICATIONS EQUIPMENT (GALVANIZED)

EXISTING THREE IRELAND 1No. #0.3m DISH AT AZIMUTH 120° MOUNTED ON EXISTING SUPPORT POLE TO BE RELOCATED & INSTALLED ON SUPPORT POLE

PROPOSED SIGNAL MANU CABINET IN PALISADE FENCE LINE

PROPOSED 1No. VCI FIBRE CHAMBER TO BE INSTALLED IN COMPOUND

EXISTING 1.2m WIDE COMPOUND ACCESS GATE AS REMAIN

EXISTING ACCESS ROUTE OUTLINED IN YELLOW

PROPOSED SITE LAYOUT PLAN

SCALE 1:50

THIS DRAWING IS THE PROPERTY OF SIGNAL INFRASTRUCTURE LTD (TRADING AS CELLNEX TELECOM) AT ALL TIMES, AND MUST NOT BE COPIED, TRACED OR REPRODUCED WITHOUT THEIR PERMISSION

<p>Signal Infrastructure Ltd driving telecom connectivity Suite 311 Q House, 78 Pallas Road Sanofi/rd Dublin 18, D18 V950, IRELAND</p>		<p>ENGINEERING A DIGITAL FUTURE Cloghleaing Avenue Rahislen Business Pk, Limerick, V94 VX88, IRELAND</p>	
Site Code	CIG_02499	Structure Height	21m
Structure Type	MONOPOLE	Beam Width	-
Site Name	SUREWELD INTERNATIONAL LTD., FONTHILL, LUCAN, Co. DUBLIN		
<p>The PROPOSED SITE LAYOUT PLAN</p>			
<p>PLANNING APPLICATION DRAWING</p>			
Designed By	DR	Drawn By	SI
Date	29/11/2021	Date	29/11/2021
Scale	AS SHOWN	Scale	AS SHOWN
Drawn No.	CIG_02499 - 106 PA	Rev.	A