

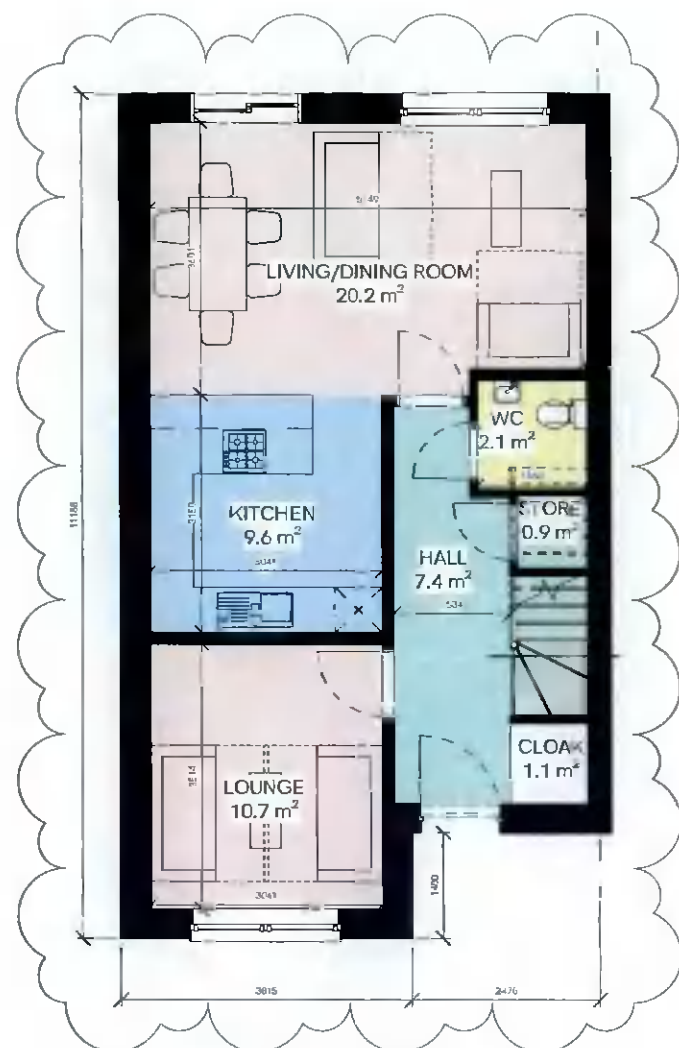

Notes

Copyright and not to be reproduced without the consent of Holmes Miller. Holmes Miller accepts responsibility for this document only to the commissioning Party and not to any other. Holmes Miller does not accept liability for accuracy or veracity of survey information provided by others and horizontal dimensions and levels provided by Holmes Miller and based on survey information provided by others must be verified on site. DO NOT SCALE. Use figured dimensions only.



GROUND FLOOR PLAN 1:100
GIFA: 56.1m²



FIRST FLOOR PLAN 1:100
GIFA: 52.8m²



SECOND FLOOR PLAN 1:100
GIFA: 35.3m²

TOTAL GIFA: 144.2m²

P03	Areas Updated. Schedule of compliance added	BP	DJ	05.11.21
P02	Depth of House Type reduced	DH	DJ	20.07.21
P01	Approved as per notes comments	DH	DJ	13.07.21
Rev	Notes	Drawn	Appr	Date

SCHEDULE OF COMPLIANCE WITH QUALITY HOUSING FOR SUSTAINABLE COMMUNITIES (2007)		
	REQUIREMENTS FOR 3 BED/ 6P HOUSE - 3 STOREY	PROPOSAL
GIFA	110 SQM	144.2 SQM
LIVING ROOM	15 SQM	20.2 SQM
AGGREGATE LIVING AREA	37 SQM	39 SQM
AGGREGATE BEDROOM AREA	36 SQM	45 SQM
STORAGE	6 SQM	6.9 SQM
DOUBLE BEDROOM	Min. 11.4 SQM	Min. 11.5 SQM
MAIN BEDROOM	Min. 13 SQM	Min. 22.4 SQM
LIVING ROOM	Min. Width of 3.8M	5.75M
DOUBLE BEDROOM	Min. Width of 2.8M	Min. 3.35M

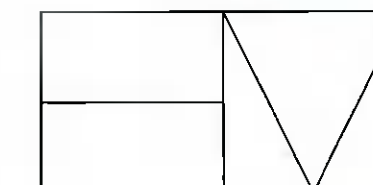

Holmes Miller
89 Minerva Street
Glasgow
G3 5LE
0141 204 2080
www.holmesmiller.com

Project 4801
Newbrook House Luxury Suites

Drawing Name
PROPOSED FLOOR PLANS
(TYPICAL HOUSE TYPE)

Scale @A3 Checked Revision
1 : 100 DJ DJ P03

Drawing Number
4801-HML-ZZ-ZZ-DR-A-10205