

1 TYPICAL CHAMBER LAYOUT PLAN
SCALE: 1:25

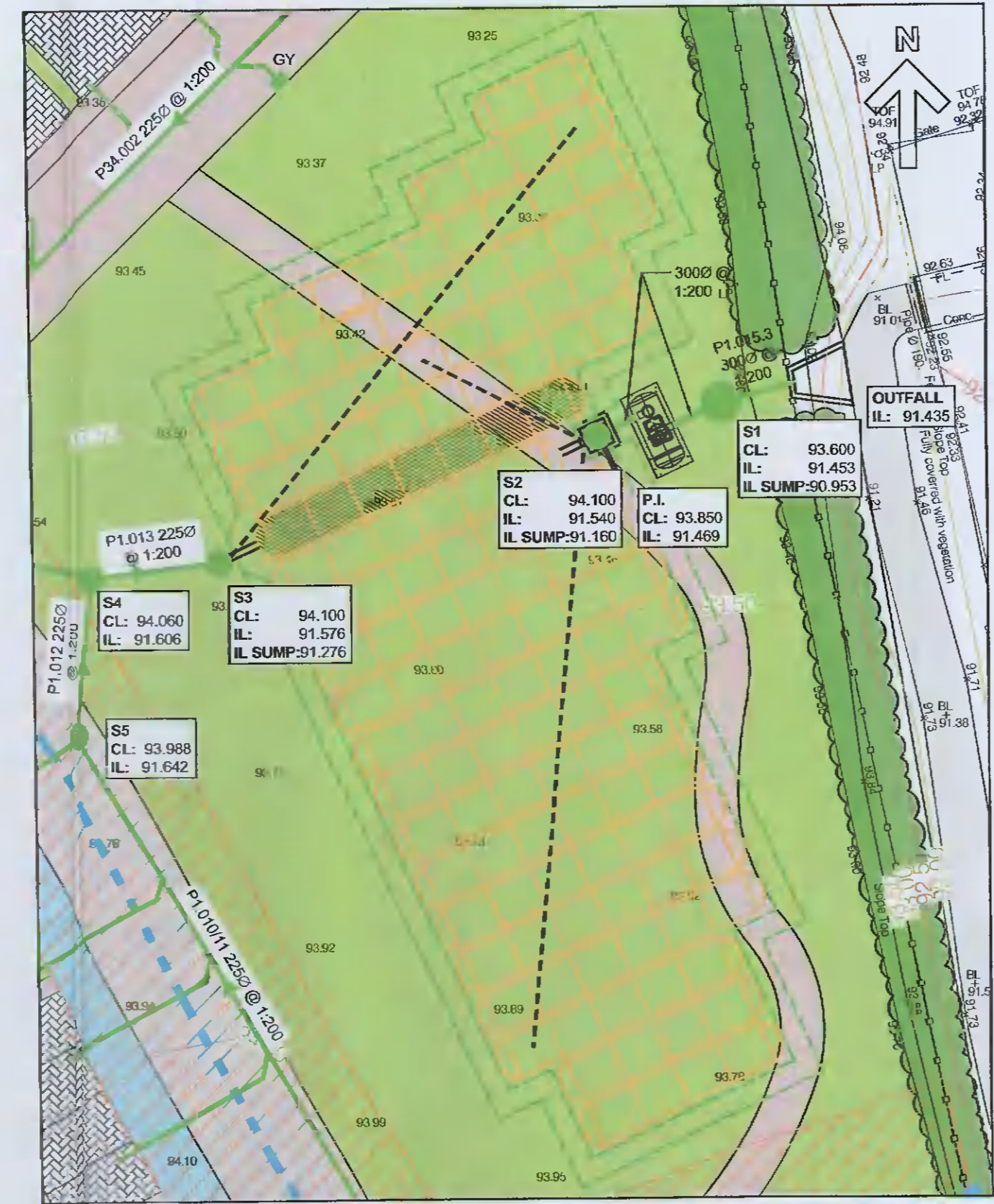

KEY PLAN
SCALE: 1:250

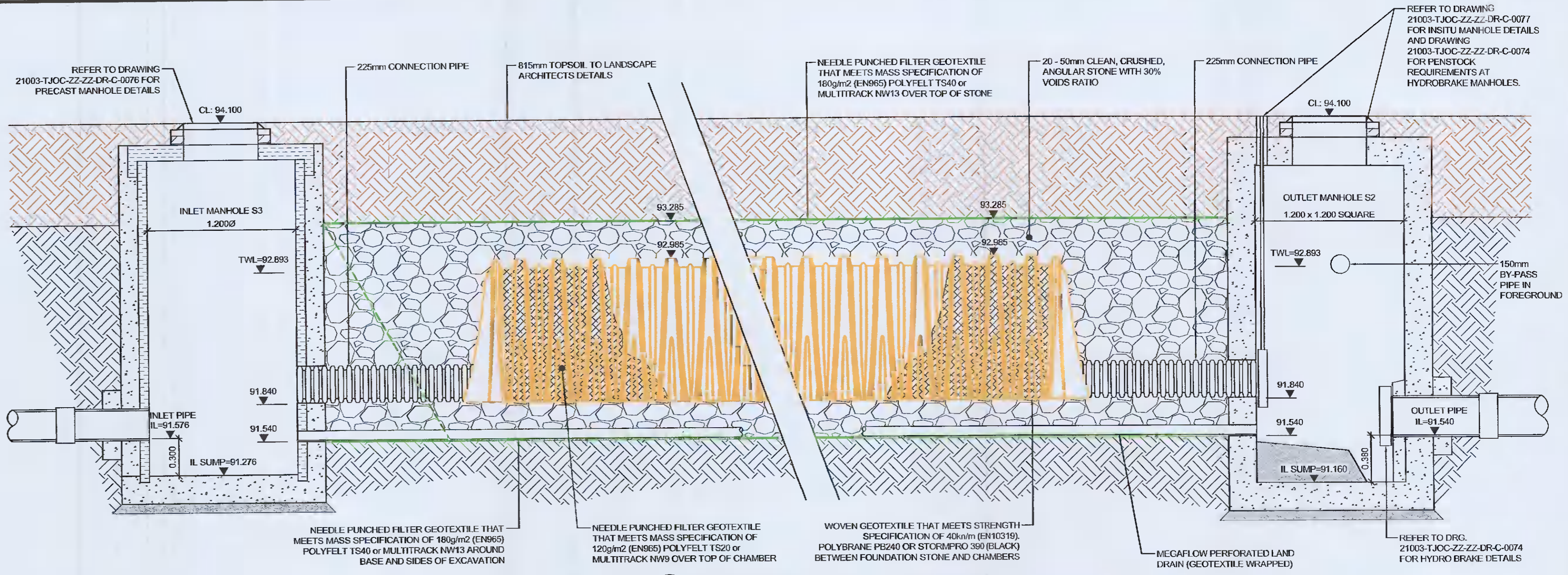

2 STORMTECH ISOLATOR™ ROW CROSS SECTION
SCALE: 1:25

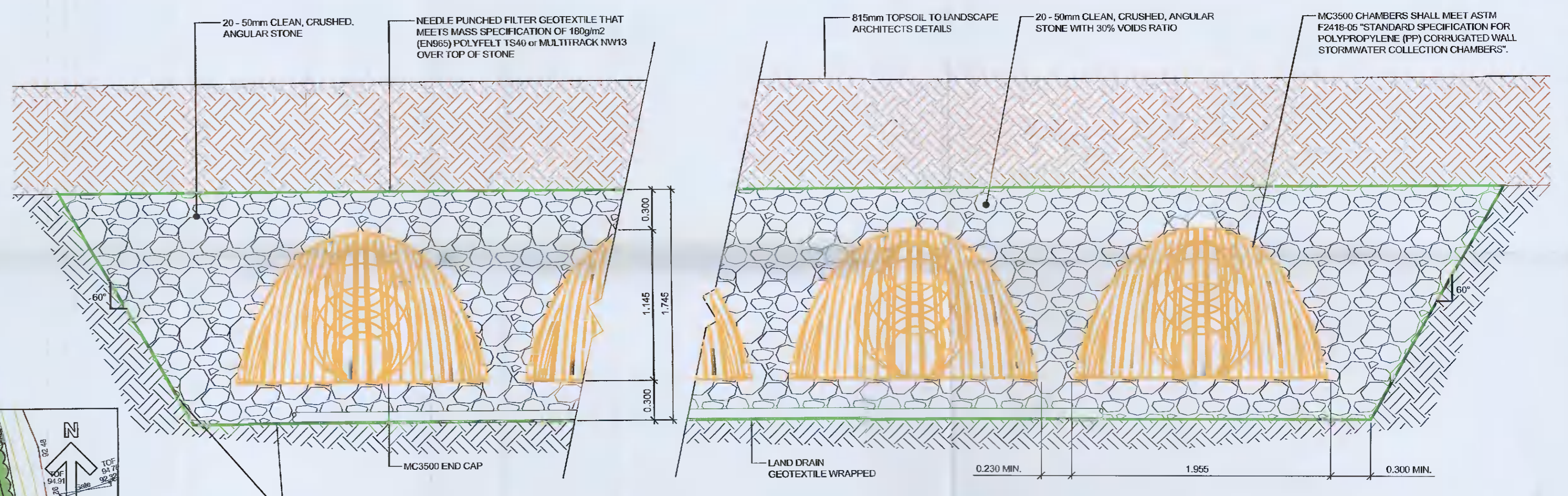

3 STORMTECH CROSS SECTION
SCALE: 1:25

LEGEND

- PROPOSED SURFACE WATER SEWER
- PROPOSED SURFACE WATER MANHOLE
- PROPOSED ROAD GULLY
- STORMTECH ATTENUATION SYSTEM

MODULAR STORMWATER CHAMBER SPECIFICATIONS:

1. CHAMBERS SHALL BE STORMTECH MC-3500, OR APPROVED EQUAL.
2. CHAMBERS SHALL CONFORM TO THE REQUIREMENTS OF ASTM F2418-05 "STANDARD SPECIFICATION FOR POLYPROPYLENE (PP) CORRUGATED WALL STORMWATER COLLECTION CHAMBERS".
3. CHAMBERS ROWS SHALL PROVIDE CONTINUOUS, UNOBSTRUCTED INTERNAL SPACE WITH NO INTERNAL SUPPORT PANELS.
4. CHAMBERS SHALL BE PRODUCED / AN ISO 9001 CERTIFIED MANUFACTURING FACILITY.
5. ALL DESIGN SPECIFICATION FOR CHAMBERS SHALL BE IN ACCORDANCE WITH THE MANUFACTURER'S LATEST DESIGN MANUAL.
6. THE INSTALLATION OF CHAMBERS SHALL BE IN ACCORDANCE WITH THE MANUFACTURER'S LATEST INSTALLATION INSTRUCTIONS.

C01	AP	ISSUED FOR PLANNING	18.11.2021
-----	----	---------------------	------------

REV	STAT	DESCRIPTION	DATE
-----	------	-------------	------

DRAWING STATUS: ISSUED FOR PLANNING		
CHECKED BY: RON	REVIEWED BY: JM	APPROVED BY: JM

NO PART OF THIS DOCUMENT MAY BE REPRODUCED OR TRANSMITTED IN ANY FORM OR STORED IN ANY RETRIEVAL SYSTEM OR ANY MANNER WITHOUT THE WRITTEN PERMISSION OF THE CONSULTING ENGINEER AS COPYRIGHT HOLDER EXCEPT AS AGREED FOR USE ON THE PROJECT FOR WHICH THE DOCUMENT WAS ORIGINALLY ISSUED.

TJ O'CONNOR & ASSOCIATES
CONSULTING ENGINEERS

CORRIG HOUSE, CORRIG ROAD, SANDYFORD, DUBLIN 18.
Tel: 01-295 2321 Fax: 01-295 4541 Email: tjoc@tjoc.ie Web: www.tjoc.ie

PROJECT: PROPOSED RESIDENTIAL DEVELOPMENT AT GORDON PARK

CLIENT: GREENWALK DEVELOPMENT LTD.

DRAWING TITLE: PROPOSED STORMTECH DETAILS SHEET 2

SCALE: AS SHOWN (A1)

PROJECT - CONSTRUCTION - VOLUME - LOCATION - TYPE - ROW - NUMBER
21003-TJOC-ZZ-ZZ-DR-C-0072 REV: C01