

Additional Information Response:

Note: The proposed development has been revised. The number of proposed units has been reduced from 2 to 3. The revised proposal is for the construction of one 4 bed detached residential unit and the reinstatement of existing unit from child care care building to a 4 bed semi-detached residential unit.

Note: The previously proposed planning application was for the construction of 2 semi-detached 3 bed residential units and the reinstatement of existing unit from child care care building to a 3 bed semi detached residential unit.

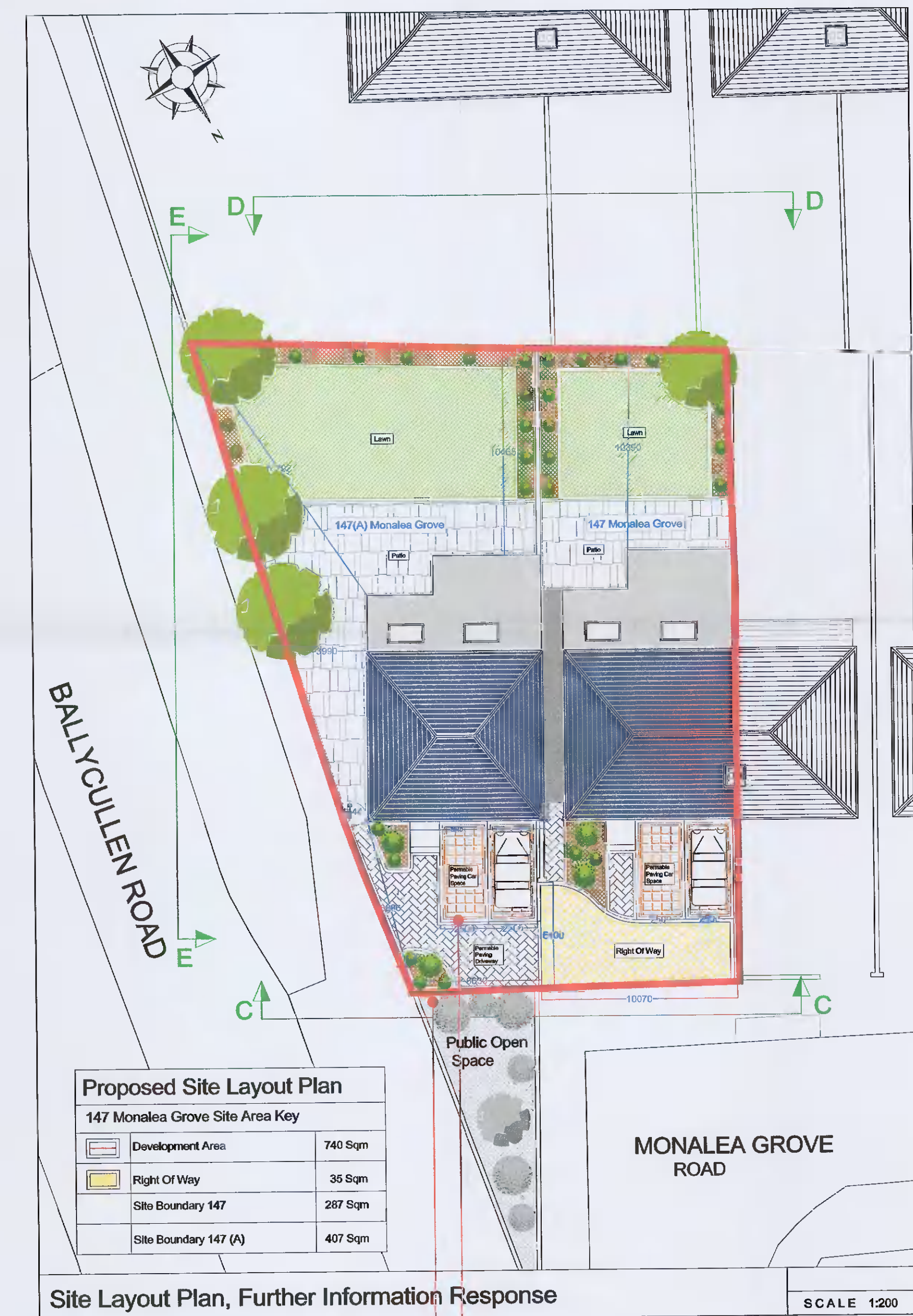

Additional Information Response:

Request:
1. Development should not encroach on publicly owned planted space directly north of the site

Response:
1. Development does Not encroach on publicly owned planted space directly north of the site. See Revised Site Layout Plans & Ordnance Survey Maps which clearly shows the site boundary line for proposed development and the boundary line for the publicly owned planted space

Additional Information Response:

Request:
2(a) The applicant is requested to submit a revised layout increasing the parking arrangement to up to 2 on-curtlidge car parking spaces for each dwelling
2(b) The applicant is requested to consider providing separate vehicle access to each dwelling

Response:
2(a&b) The proposed car parking arrangement is for the allocation of two separate car parking spaces per dwelling. Each dwelling is accessed via a shared surface 'way leave' for vehicular access