

NOTE:
EXISTING WATER
TANK AND
SERVICES TO BE
RELOCATED

NOTE:
EXISTING SOLAR
PANELS TO BE
RELOCATED

FLAT ROOF LAID TO FALL 1-80.
ROOF TRUSS RAFTERS 150x50mm
@400 C.C. ON 100x75 WALL
PLATES

NOTES:
MODIFY EXISTING ROOF STRUCTURE TO
FACILITATE ACCESS INTO EXISTING ATTIC SPACE
AND CONVERSION OF EXISTING ATTIC SPACE
FOR STORAGE PURPOSES.
ROOF TILES LAID ON 50x25 BATTENS LAID OVER
UNTEARABLE ROOFING FELT.
FELT TO RUN OUT OVER FILLET PIECE AND INTO
PVC GUTTER
ROOF TRUSS RAFTERS 150x50mm @400 C.C.
ON 100x75 WALL PLATES SUPPORT WITH
175x75 PURLINS AND 150x50 HANGERS & TIES
TO COMPLY WITH I.S. 193

NOTES:
ALL TIMBERS TO BE SCB AND IN
ACCORDANCE WITH SR 11 1991.
PROVIDE LATERAL SUPPORT TO
WALLS WHERE THEY RUN PARALLEL
TO JOISTS, BY FIXING 30X6MM GALV.
M.S. STRAPS AT 2M CRS ACROSS 2
NO JOISTS.
SOLID NOGGING PIECES TO BE FIXED
DIRECTLY UNDER STRAPS. DITTO
ALONG ROOF SLOPE.
INSULATION BETWEEN RAFTERS TO
BUILDING REGULATIONS.
PROVIDE 50MM UNOBSTRUCTED AIR
SPACE BETWEEN INSULATION AND
ROOF FELT. PROVIDE VENTILATION AT
EAVES TO PROMOTE CROSS
VENTILATION 10MM STRIP FULL
LENGTH

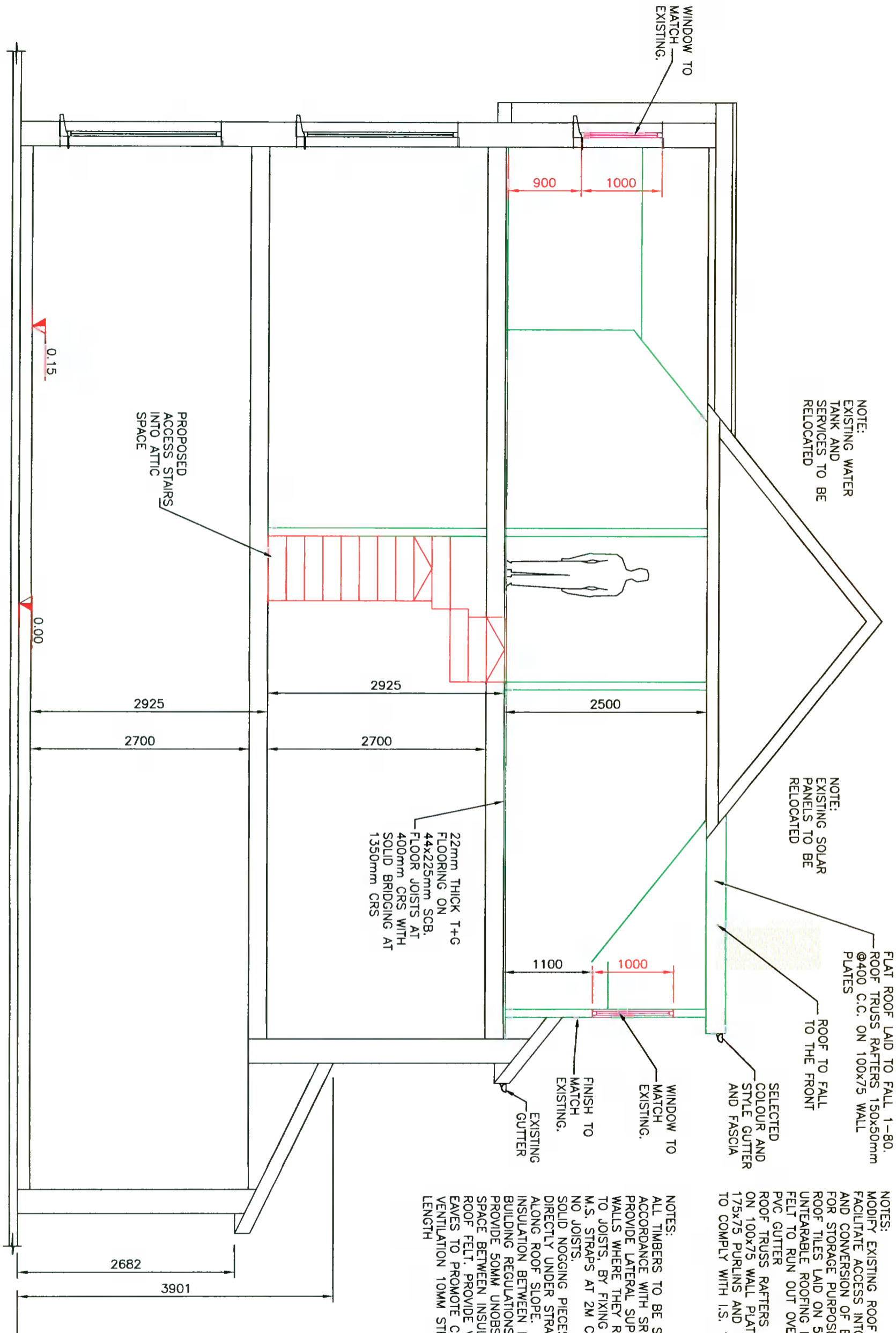

PROPOSED SECTION VIEW



The information contained in this drawing is confidential and must not be divulged to any third party without the written consent of 4bes Design Services.



38 Larkfield Avenue
Lucan
Co. Dublin

60 Wilkins Court,
Whitehall,
Dublin 12

PROPOSED SECTION VIEW

DRAWN	JOHN FORBES , 38 LARKFIELD AVE. , LUCAN, CO. DUBLIN
DATE	NOVEMBER 2021
SCALE	1:50 @ A3
Max Klimmek	